

STRATA PLAN OF LOT 2
OF DISTRICT LOT 4,
GROUP 1, PLAN 58826,
NEW WESTMINSTER DISTRICT
MUNICIPALITY OF BURNABY

STRATA PLAN NW 1630

DEPOSITED AND REGISTERED IN
 THE LAND TITLES OFFICE AT
 NEW WESTMINSTER, BRITISH COLUMBIA
 THIS 24 DAY OF JULY, 1981

[Signature]
 ASSISTANT DEPUTY REGISTRAR

REF. BY 156006

KEY PLAN
EAST TOWER

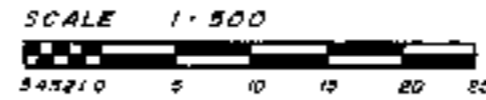

"LOUGHEED TOWERS" (EAST TOWER)

ADDRESS FOR SERVICE OF
 DOCUMENTS ON THE STRATA
 CORPORATION IS:

THE OWNERS
 STRATA CORPORATION NW 1630
 1/4 OLIVER, HUGHES, AND GRABIK
 725 CARNARVON STREET
 NEW WESTMINSTER, B.C.

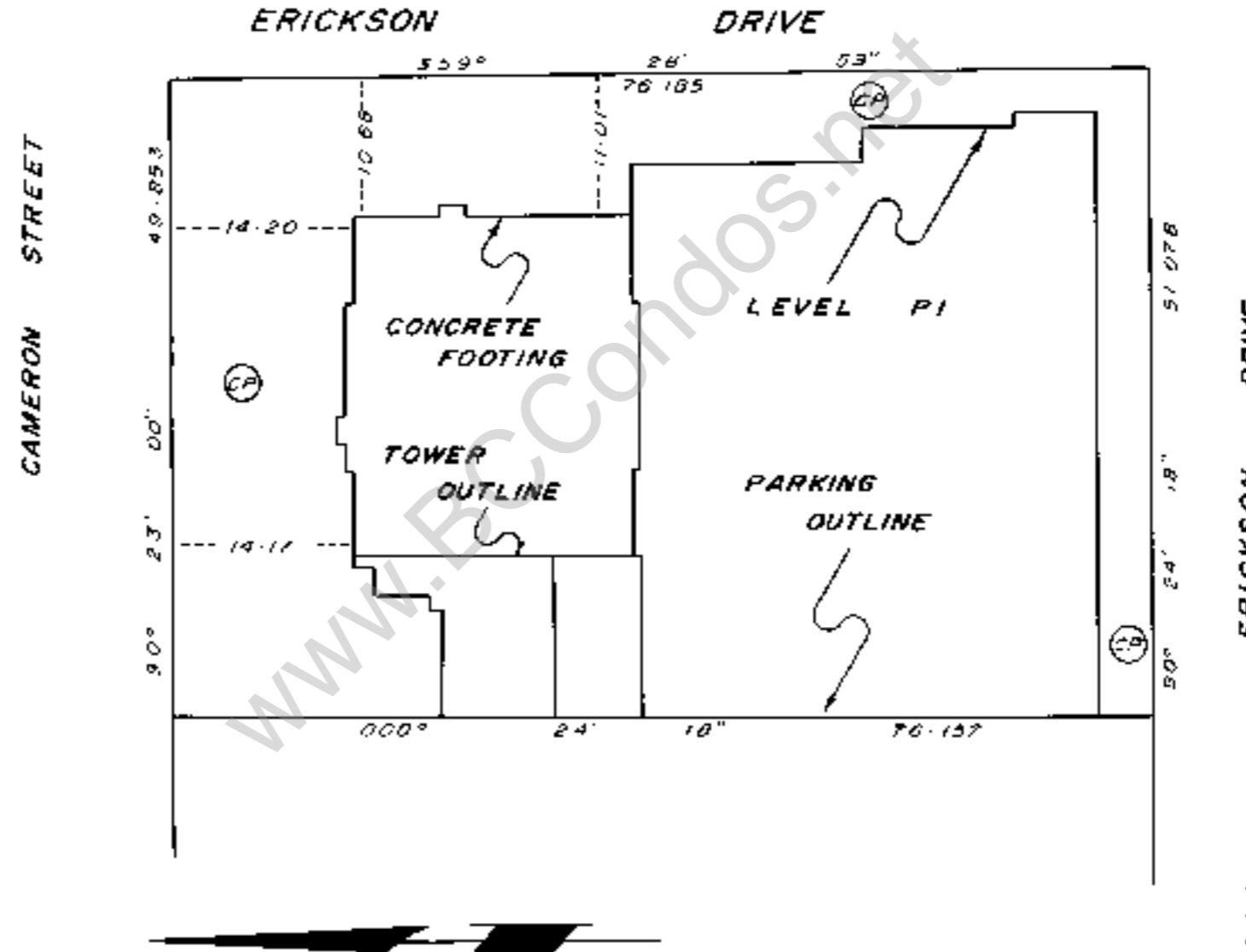

- LEGEND
- ALL DISTANCES ARE IN METRES
 - Ⓢ DENOTES COMMON PROPERTY
 - m² DENOTES METRES SQUARED
 - H1 DENOTES PART
 - SL DENOTES STRATA LOT
 - Ⓜ DENOTES BALCONY
 - Ⓟ DENOTES PATIO
 - PLAZA IS OPEN SPACE

MURRAY & ASSOCIATES
9238 SCOTT ROAD
SURREY, B.C.

I ERIC I. KAARDAL OF NEW WESTMINSTER,
 BRITISH COLUMBIA LAND SURVEYOR, HEREBY
 CERTIFY THAT THE BUILDING ERECTED ON THE
 PARCEL DESCRIBED ABOVE IS WHOLLY WITHIN
 THE EXTERNAL BOUNDARIES OF THAT PARCEL,
 DATED AT SURREY, B.C.
 THIS 25th DAY OF MAY, 1981

[Signature]
 1981

FILE 6744 (S)(E)

STRATA PLAN NW 1630

S. L. N°	SHEET N°	FORM I	FORM II	FORM III
		SCHEDULE	SCHEDULE	SCHEDULE
		UNIT ENTITLEMENT	INTEREST UPON DESTRUCTION	VOTING RIGHTS
1	10	812	93380	
2	10	814	93610	
3	10	685	78775	
4	10	822	94530	
5	10	685	94645	
6	10	682	78430	
7	11	812	93380	
8	11	814	93610	
9	11	685	78775	
10	11	822	94530	
11	11	823	94645	
12	11	682	78430	
13	12	812	93380	
14	12	814	93610	
15	12	685	78775	
16	12	822	94530	
17	12	823	94645	
18	12	682	78430	
19	13	812	93380	
20	13	814	93610	
21	13	685	78775	
22	13	822	94530	
23	13	823	94645	
24	13	682	78430	
25	14	812	93380	
26	14	814	93610	
27	14	685	78775	
28	14	822	94530	
29	14	823	94645	
30	14	682	78430	
31	15	812	93380	
32	15	814	93610	
33	15	685	78775	
34	15	822	94530	
35	15	823	94645	
36	15	682	78430	
37	16	812	93380	
38	16	814	93610	

S. L. N°	SHEET N°	FORM I	FORM II	FORM III
		SCHEDULE	SCHEDULE	SCHEDULE
		UNIT ENTITLEMENT	INTEREST UPON DESTRUCTION	VOTING RIGHTS
39	16	685	78775	
40	16	822	94530	
41	16	823	94645	
42	16	682	78430	
43	17	812	93380	
44	17	814	93610	
45	17	685	78775	
46	17	822	94530	
47	17	823	94645	
48	17	682	78430	
49	18	812	93380	
50	18	814	93610	
51	18	685	78775	
52	18	822	94530	
53	18	823	94645	
54	18	682	78430	
55	18	812	93380	
56	19	814	93610	
57	19	685	78775	
58	19	822	94530	
59	19	823	94645	
60	19	682	78430	
61	20	812	93380	
62	20	814	93610	
63	20	685	78775	
64	20	822	94530	
65	20	823	94645	
66	20	682	78430	
67	21	812	93380	
68	21	814	93610	
69	21	685	78775	
70	21	822	94530	
71	21	823	94645	
72	21	682	78430	
73	22	812	93380	
74	22	814	93610	
75	22	685	78775	
76	22	822	94530	

S. L. N°	SHEET N°	FORM I	FORM II	FORM III
		SCHEDULE	SCHEDULE	SCHEDULE
		UNIT ENTITLEMENT	INTEREST UPON DESTRUCTION	VOTING RIGHTS
77	22	823	94645	
78	22	682	78430	
79	23	812	93380	
80	23	814	93610	
81	23	685	78775	
82	23	822	94530	
83	23	823	94645	
84	23	682	78430	
85	24	812	93380	
86	24	814	93610	
87	24	685	78775	
88	24	822	94530	
89	24	823	94645	
90	24	682	78430	
91	25	812	93380	
92	25	814	93610	
93	25	685	78775	
94	25	822	94530	
95	25	823	94645	
96	25	682	78430	
97	26	812	93380	
98	26	814	93610	
99	26	685	78775	
100	26	822	94530	
101	26	823	94645	
102	26	682	78430	
103	27	812	93380	
104	27	814	93610	
105	27	685	78775	
106	27	822	94530	
107	27	823	94645	
108	27	682	78430	
109	28	979	99835	
110	28	979	99835	
111	28	979	99835	
112	28	978	99835	
AGGREGATE		87399	10000000	

EX
MAY 25/01

STRATA PLAN NW 1630

LEGAL DEVELOPMENT

AUTHORIZED SIGNATORY: G. HENRY

AUTHORIZED SIGNATORY: M. PRINCE

LOUGHEED TOWERS LIMITED

AUTHORIZED SIGNATORY

AUTHORIZED SIGNATORY

THE MERCANTILE BANK OF CANADA
By its local attorney:

[Signature]
AUTHORIZED SIGNATORY

[Signature]
AUTHORIZED SIGNATORY

Witness as to both
signatures:

MURIEL DUCK
103-1155 French St.
Vancouver, B.C.
Corporate Secretary

ACCEPTED AS TO FORMS 1, 2, AND 3,
DATED THIS 26th DAY OF July, 1981

[Signature]
SUPERINTENDENT OF INSURANCE

I, ERIC I KAARDAL OF NEW WESTMINSTER, BRITISH
COLUMBIA LAND SURVEYOR, HEREBY CERTIFY THAT THE
BUILDING SHOWN ON THIS STRATA PLAN HAS NOT AS
OF THE 25th DAY OF MAY, 1981 BEEN
PREVIOUSLY OCCUPIED.
DATED AT SURREY, B. C.
THE 25th DAY OF MAY, 1981

[Signature] B. C. L. S.

STATUTORY DECLARATION

I / WE THE UNDERSIGNED DO SOLEMNLY DECLARE THAT
(1) I / WE THE UNDERSIGNED (AM/ARE) THE OWNER-DEVELOPER
OR (IN THE ALTERNATIVE) THE DULY AUTHORIZED AGENT
OF THE OWNER-DEVELOPER

(2) THE STRATA PLAN IS ENTIRELY FOR RESIDENTIAL USE.

I / WE MAKE THIS SOLEMN DECLARATION CONSCIENTIOUSLY
BELIEVING IT TO BE TRUE AND KNOWING THAT IT IS OF
THE SAME FORCE AND EFFECT AS IF MADE UNDER OATH

DECLARED BEFORE ME
AT _____
IN THE PROVINCE OF B. C.
THIS _____ DAY OF _____ A.D.
1981.

A NOTARY PUBLIC IN AND FOR THE PROVINCE OF BRITISH COLUMBIA
A COMMISSIONER FOR TAKING AFFIDAVITS WITHIN BRITISH COLUMBIA

1981

FILE 6744 (S)(E)

STRATA PLAN NW 1630

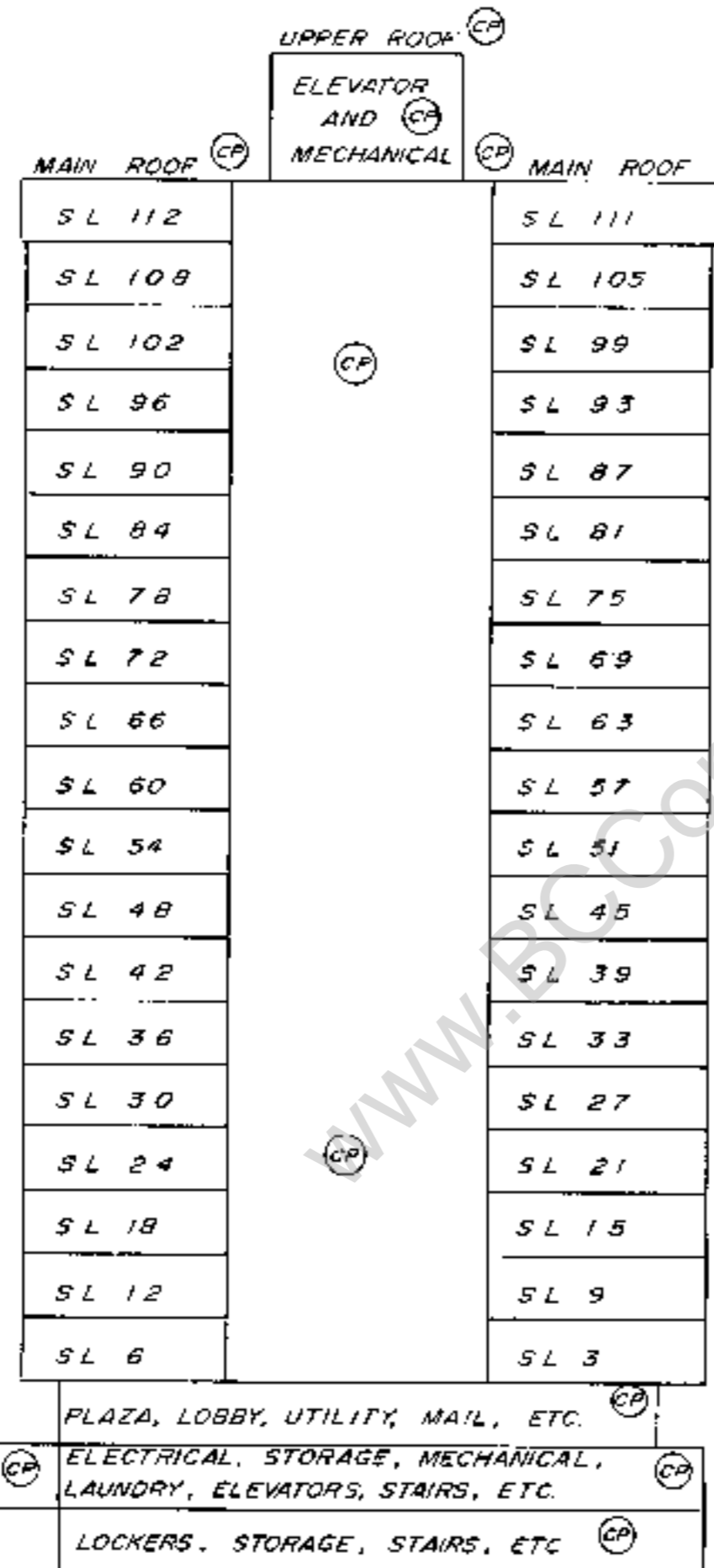

- 20th FLOOR
- 19th FLOOR
- 18th FLOOR
- 17th FLOOR
- 16th FLOOR
- 15th FLOOR
- 14th FLOOR
- 13th FLOOR
- 12th FLOOR
- 11th FLOOR
- 10th FLOOR
- 9th FLOOR
- 8th FLOOR
- 7th FLOOR
- 6th FLOOR
- 5th FLOOR
- 4th FLOOR
- 3rd FLOOR
- 2nd FLOOR
- GROUND FLOOR AND PLAZA LEVEL
- LEVEL P1
- LEVEL P2

BUILDING SECTIONS

SECTION A - A'

(VIEWED FROM THE SOUTH)

EX
MAY 25/81

FILE 6744 (S)(E)

STRATA PLAN NW 1630

BUILDING SECTIONS

SECTION B - B'

(VIEWED FROM THE WEST)

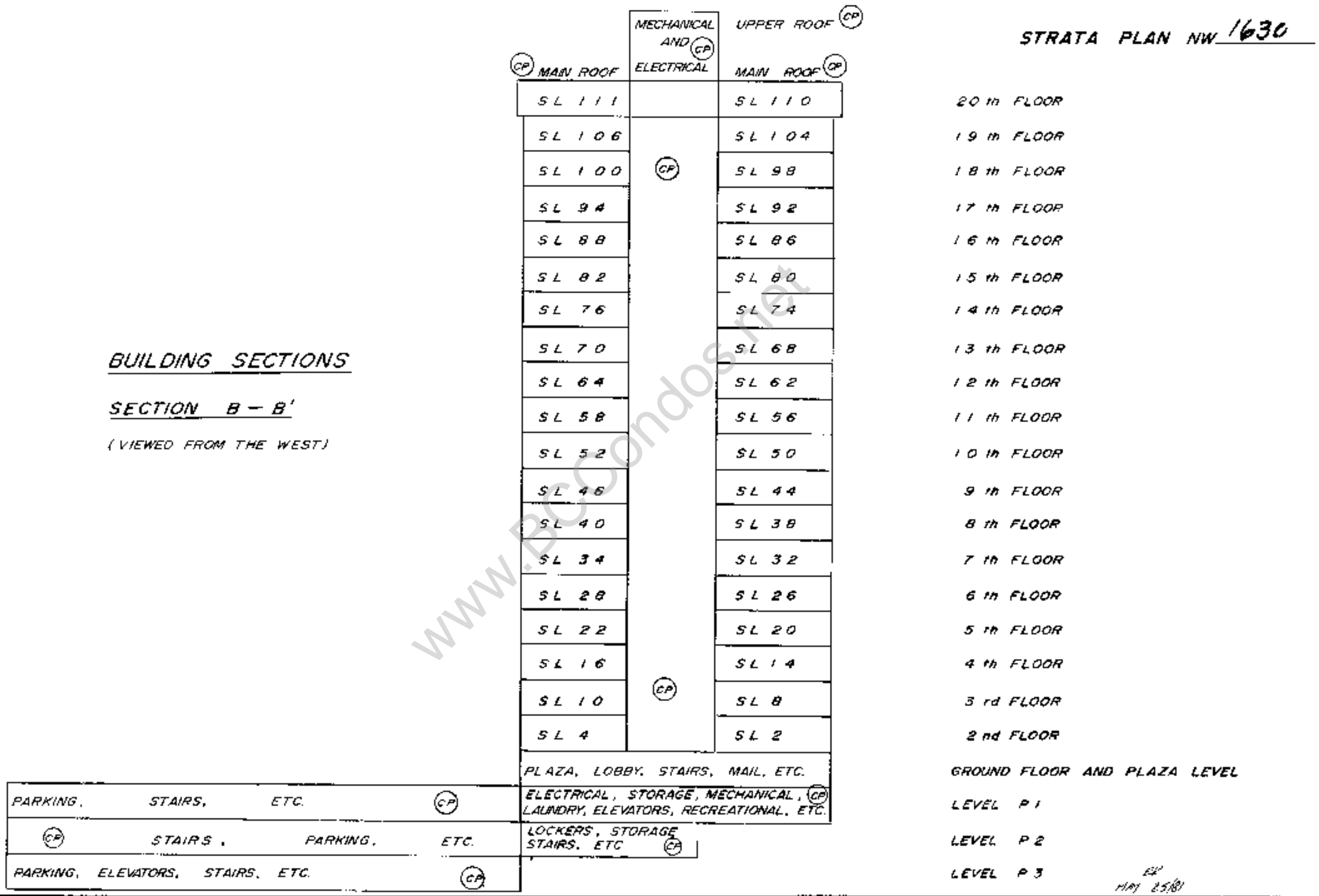

EL
MAY 25/81

FILE 6744 (S)(E)

STRATA PLAN NW 1050

EAST TOWER

LEVEL P3

SCALE 1 : 250

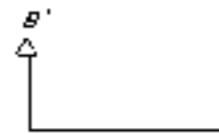
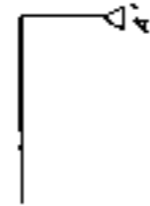

ELEVATOR
VESTIBULE
AND
STAIRS

STAIRS
CP
3.48

PARKING
± 1589 m²

CP

NOTE :
DIMENSIONS AND AREAS
ON THIS SHEET ARE
APPROXIMATE, DERIVED
FROM ARCHITECT'S PLANS.

WWW.BCCcondos.net

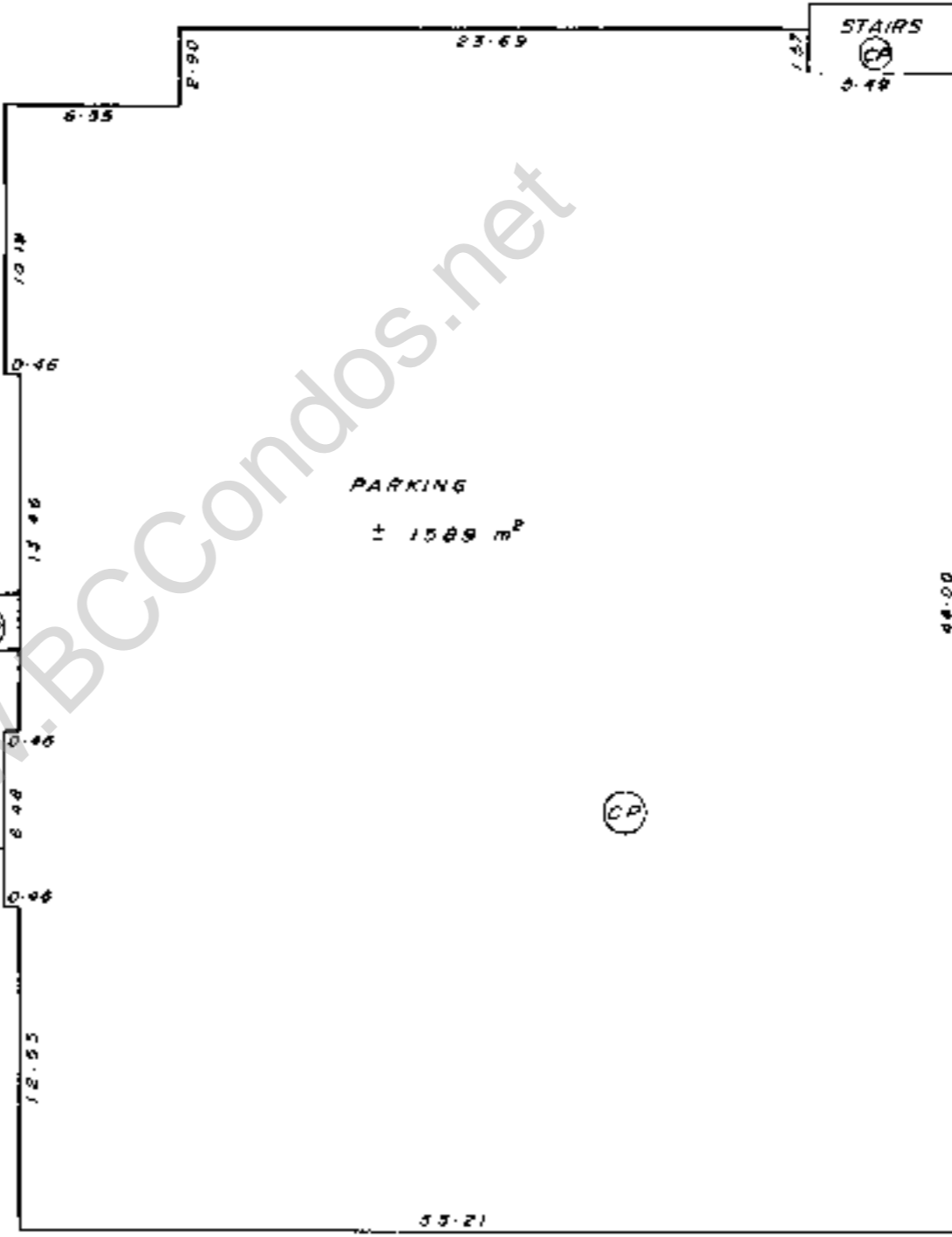

EE MAY 25/01
FILE 6744 (S)(E)

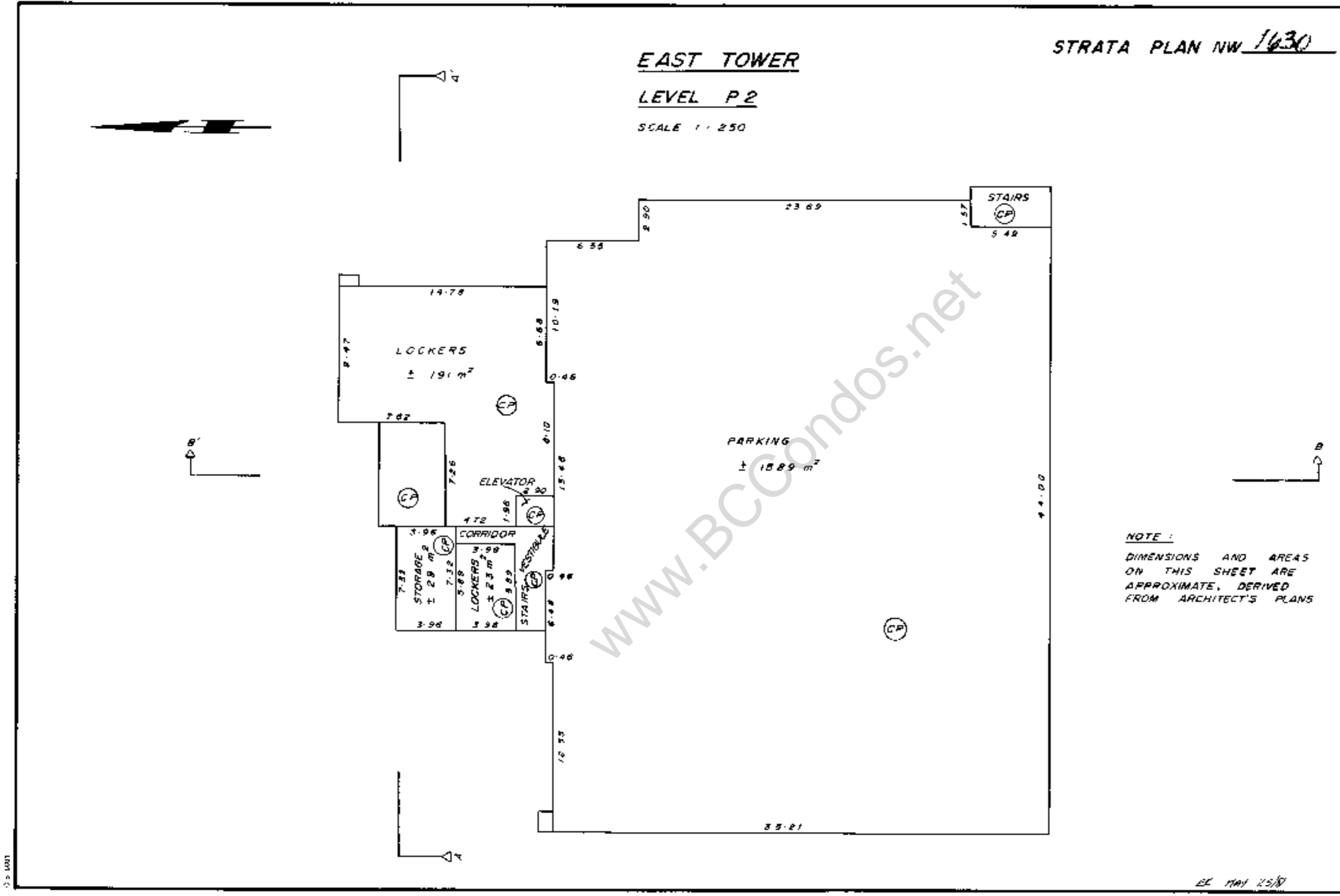

STRATA PLAN NW 1630

EAST TOWER

LEVEL P1

SCALE 1:250

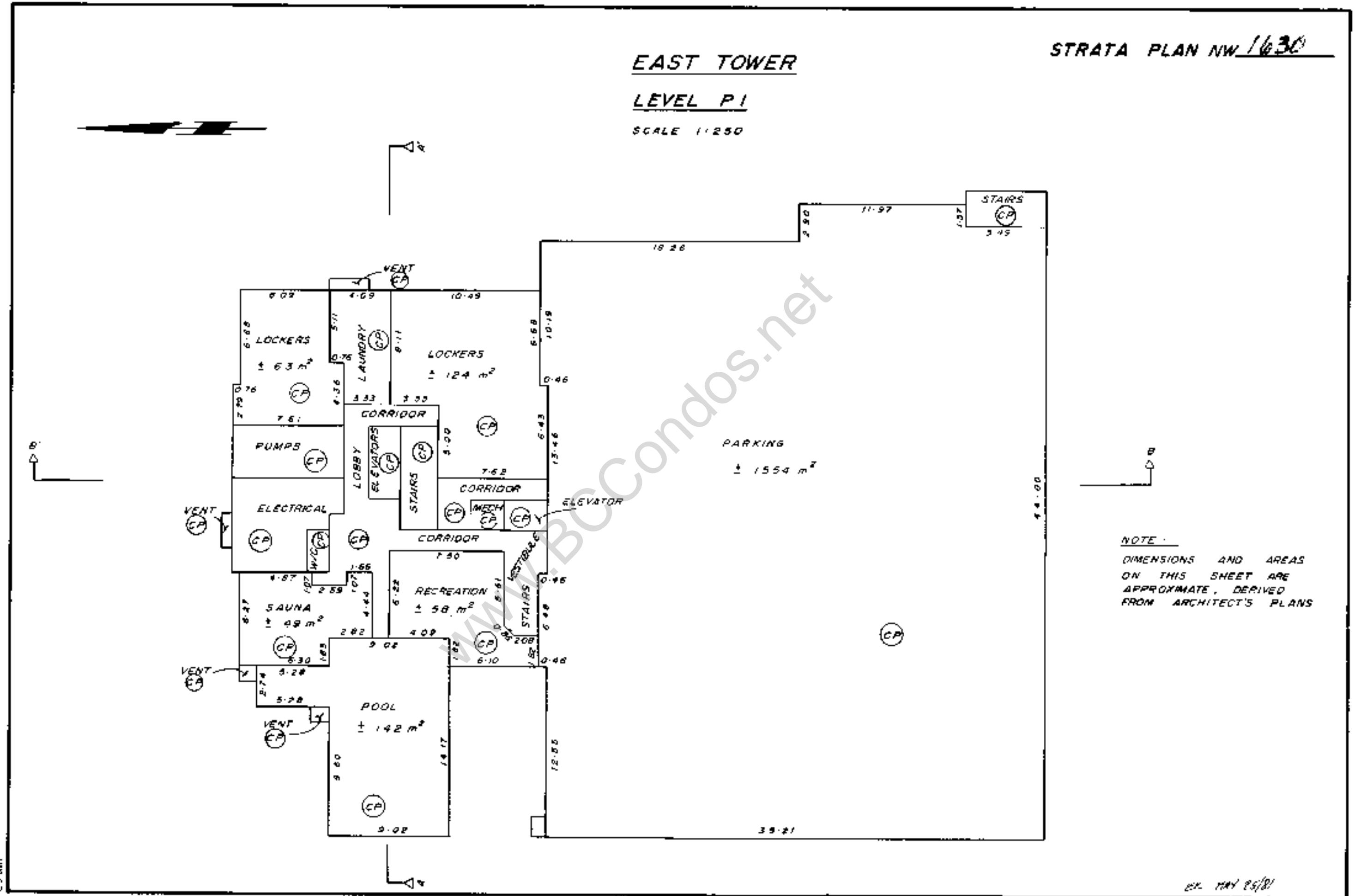

NOTE:
 DIMENSIONS AND AREAS
 ON THIS SHEET ARE
 APPROXIMATE, DERIVED
 FROM ARCHITECT'S PLANS

EX. MAY 25/98
 FILE 6744 (S)(E)

STRATA PLAN NW 1630

EAST TOWER

GROUND FLOOR AND PLAZA LEVEL

SCALE 1:250

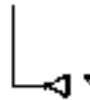
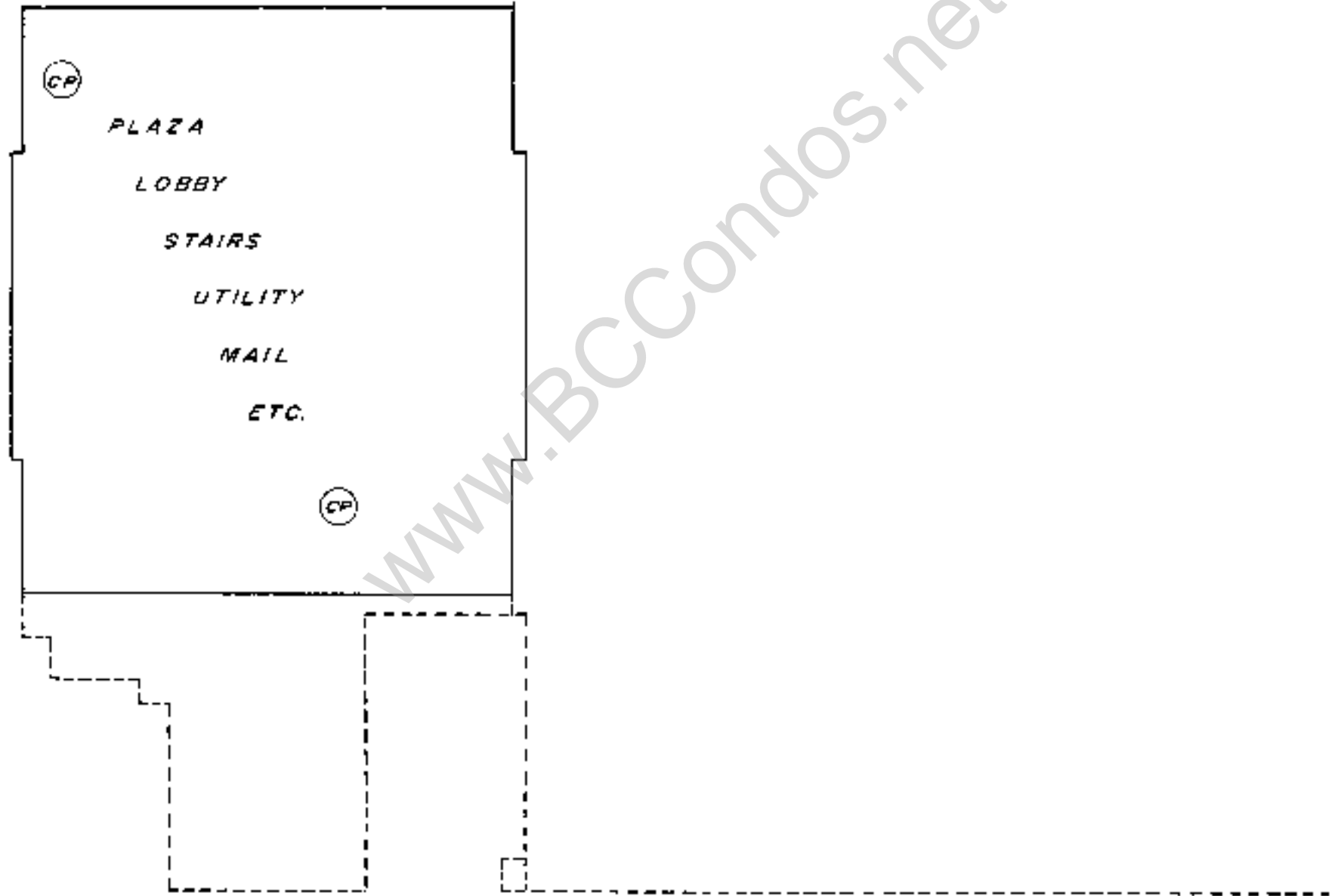
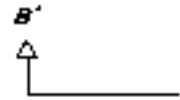

C.S. 0.50

EX 11/1 25/81

FILE 6744 (S)(E)

STRATA PLAN NW 1630

SECOND FLOOR

SCALE 1 : 250

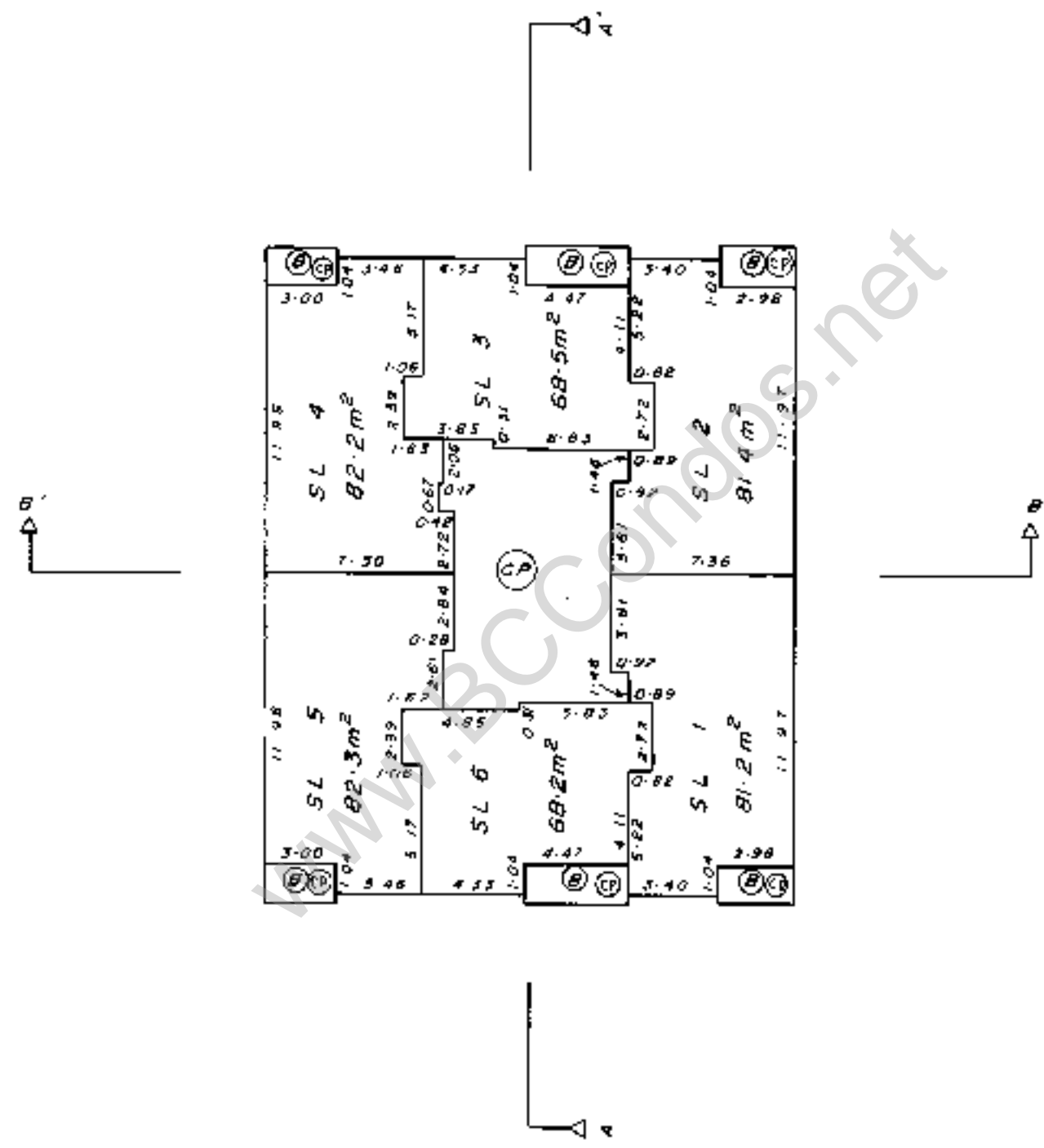

EX MAY 25/81
FILE 6744 (S)(E)

STRATA PLAN NW 16.30

THIRD FLOOR

SCALE 1 : 250

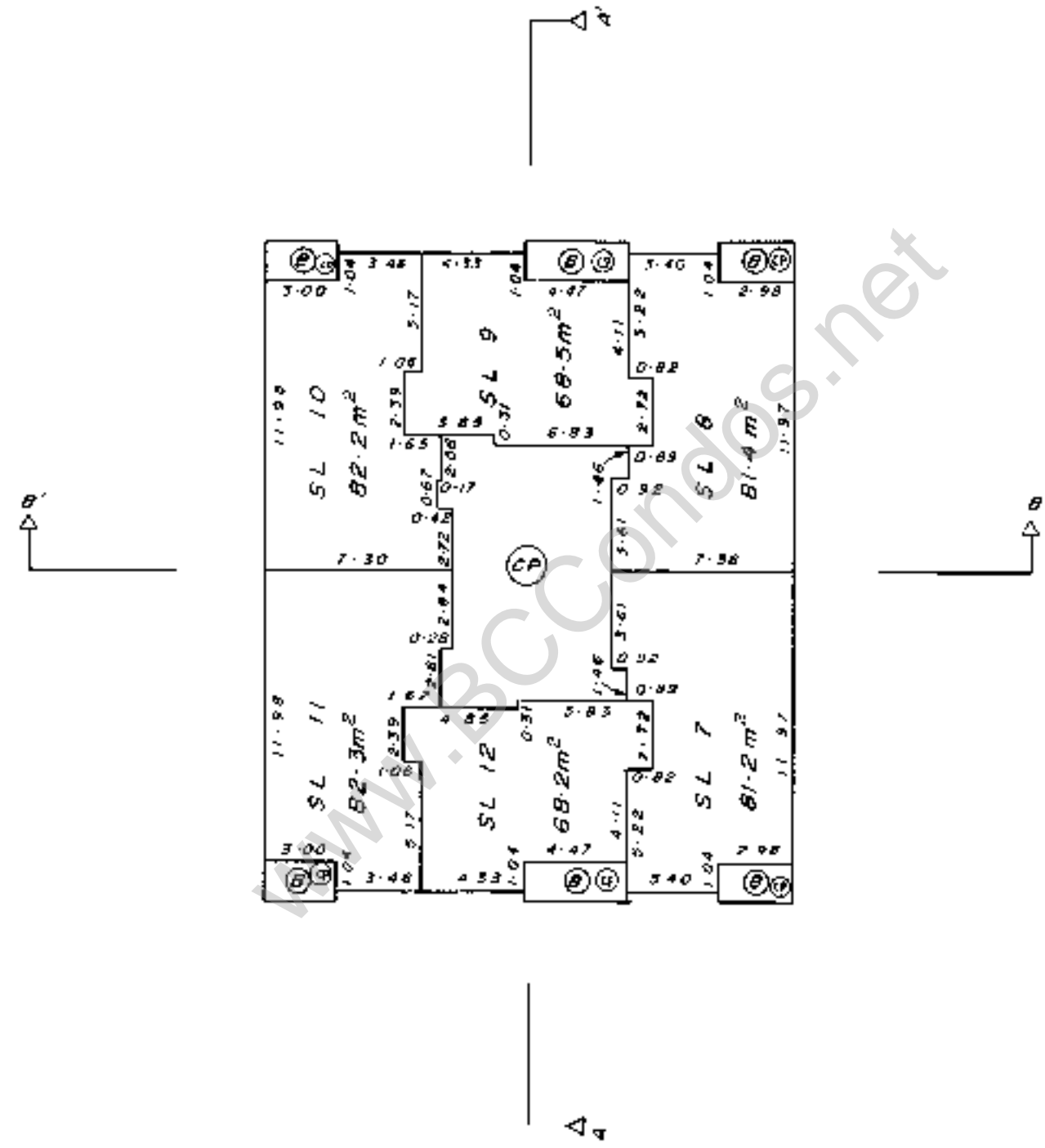

11.5 052.

EX MAY 25/01
FILE 6744 (S)(E)

STRATA PLAN NW 1630

FOURTH FLOOR

SCALE 1 : 250

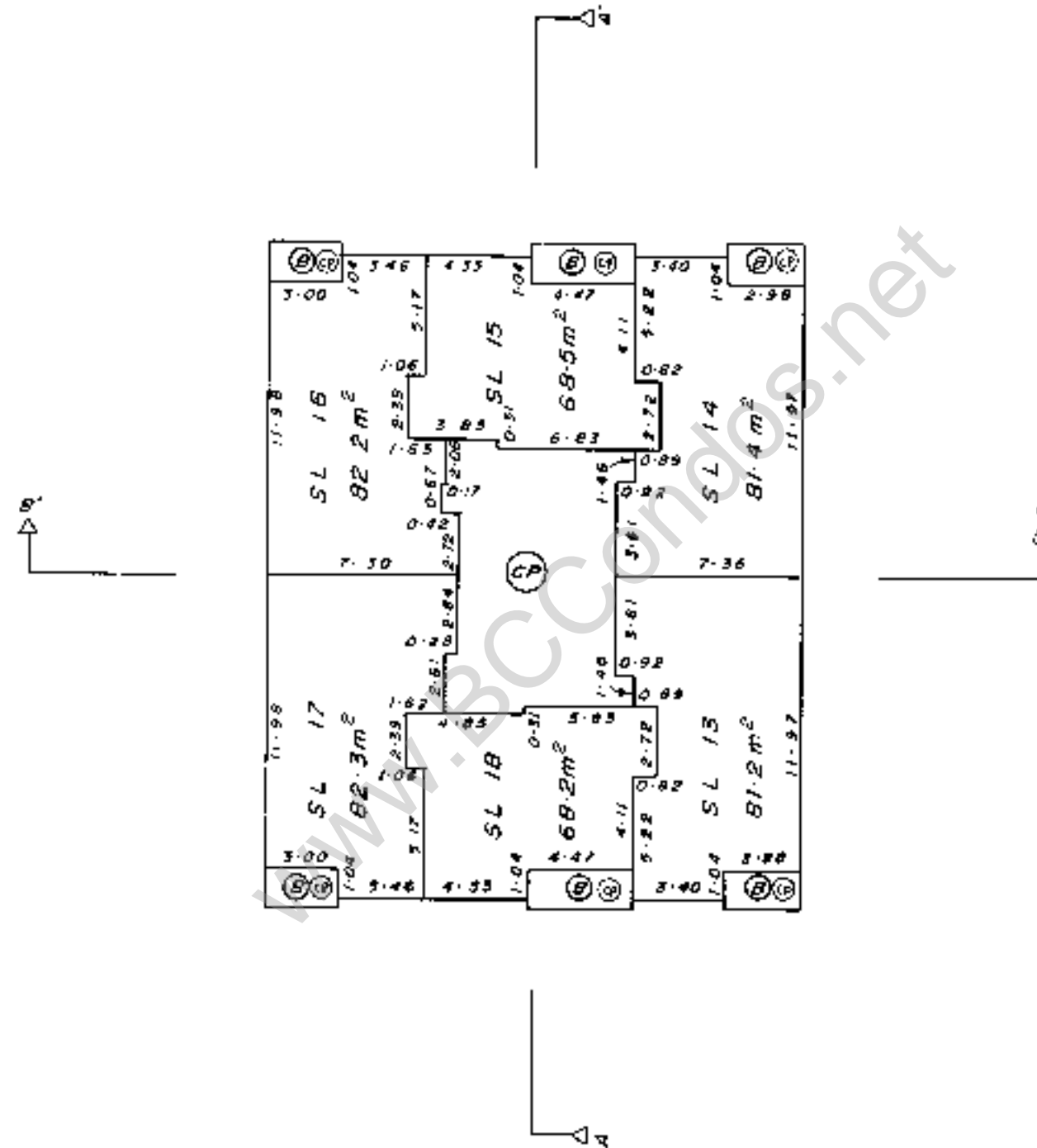

C.S. 946

EK HAH 25/01

FILE 6744 (S)(E)

STRATA PLAN NW 1630

FIFTH FLOOR

SCALE 1 : 250

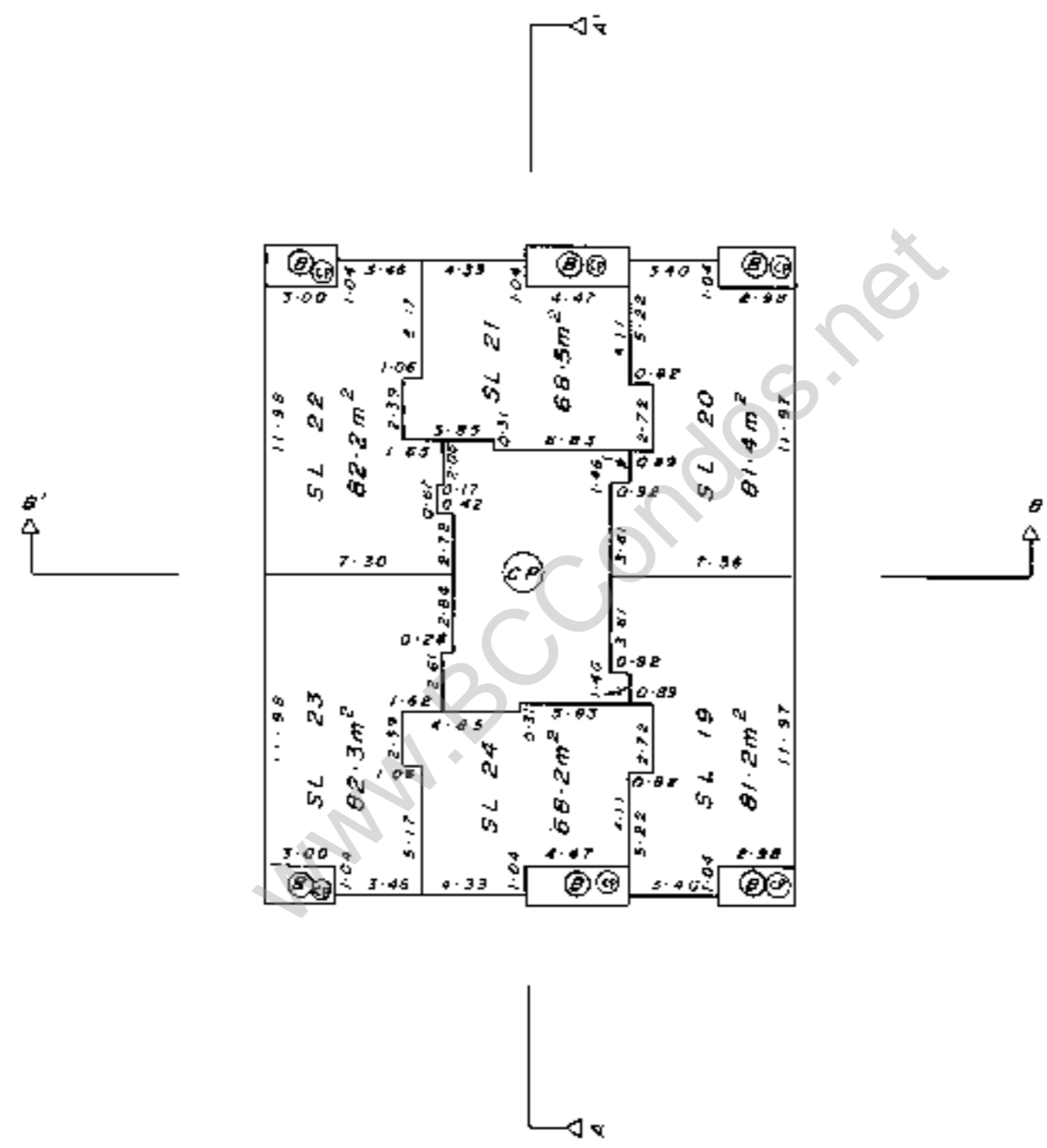

1:25 2000

EX 11A(25/8)
FILE 6744(S)(E)

STRATA PLAN NW 1630

SIXTH FLOOR

SCALE 1" = 250'

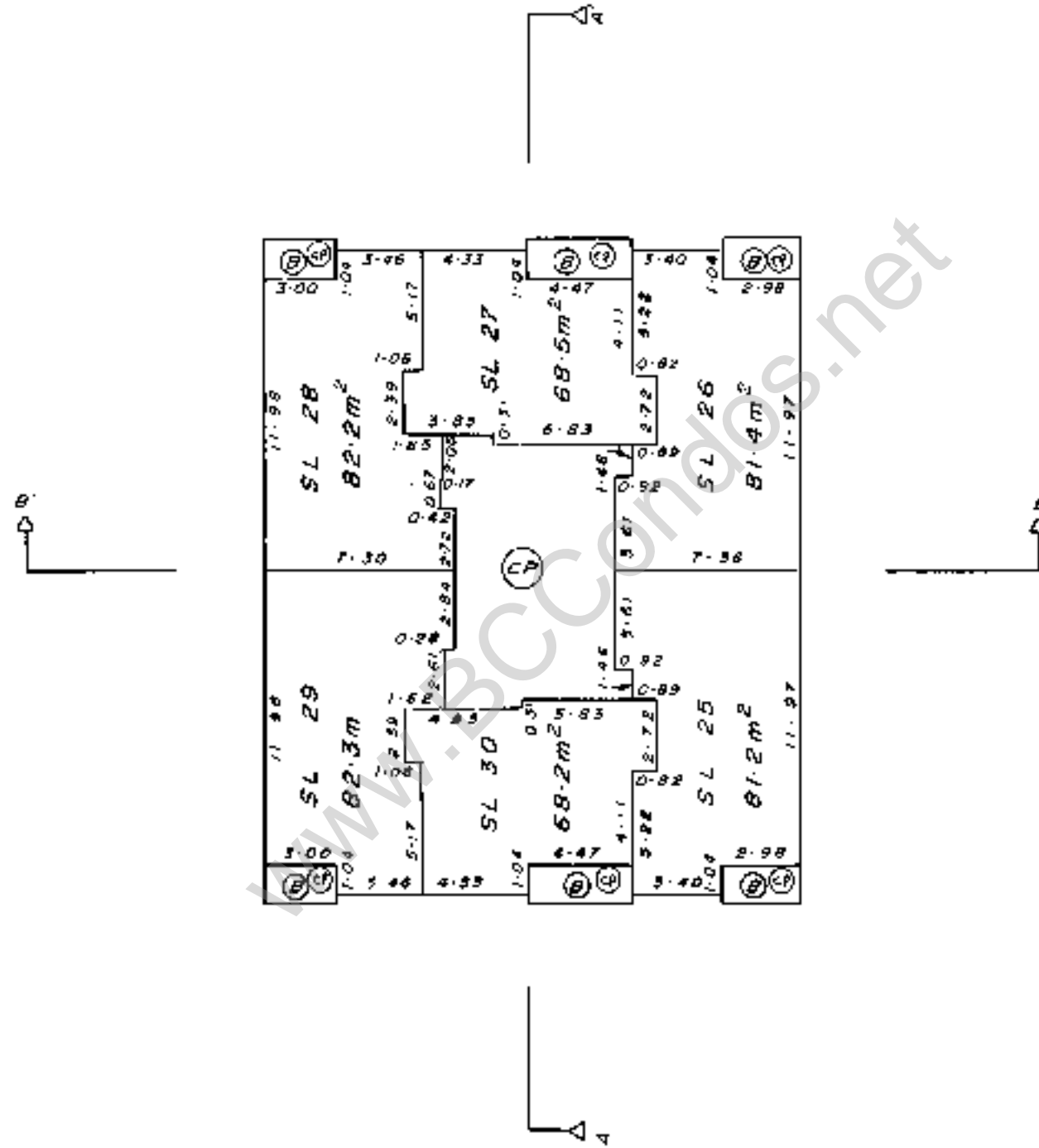

0.25 5081

EE MAY 25/81
FILE 6744 (S)(E)

STRATA PLAN NW 1630

SEVENTH FLOOR

SCALE 1:250

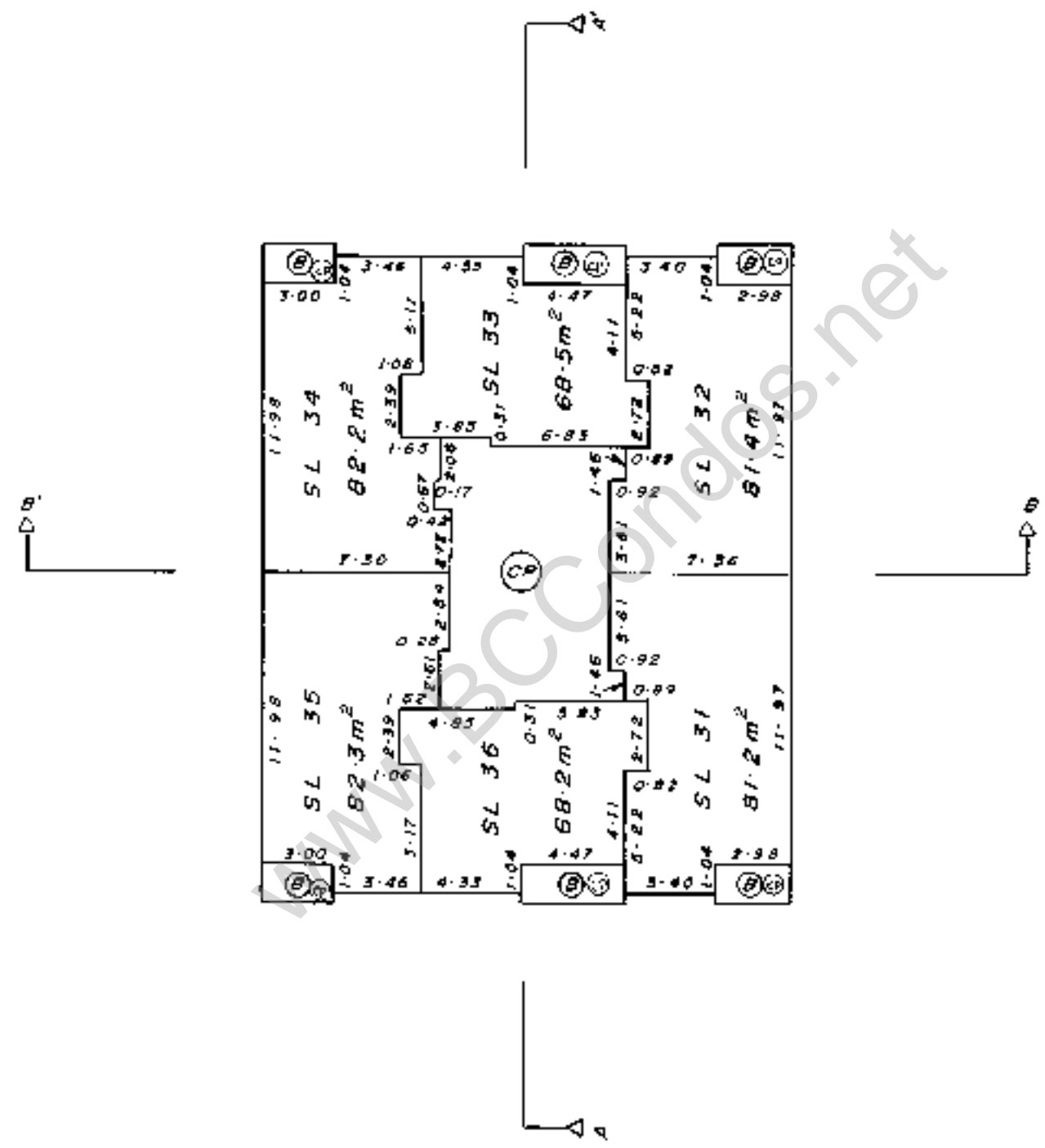

CS 001

EX 11/1 25/81
FILE 6744 (S)(E)

STRATA PLAN NW 1630

EIGHTH FLOOR

SCALE 1 : 250

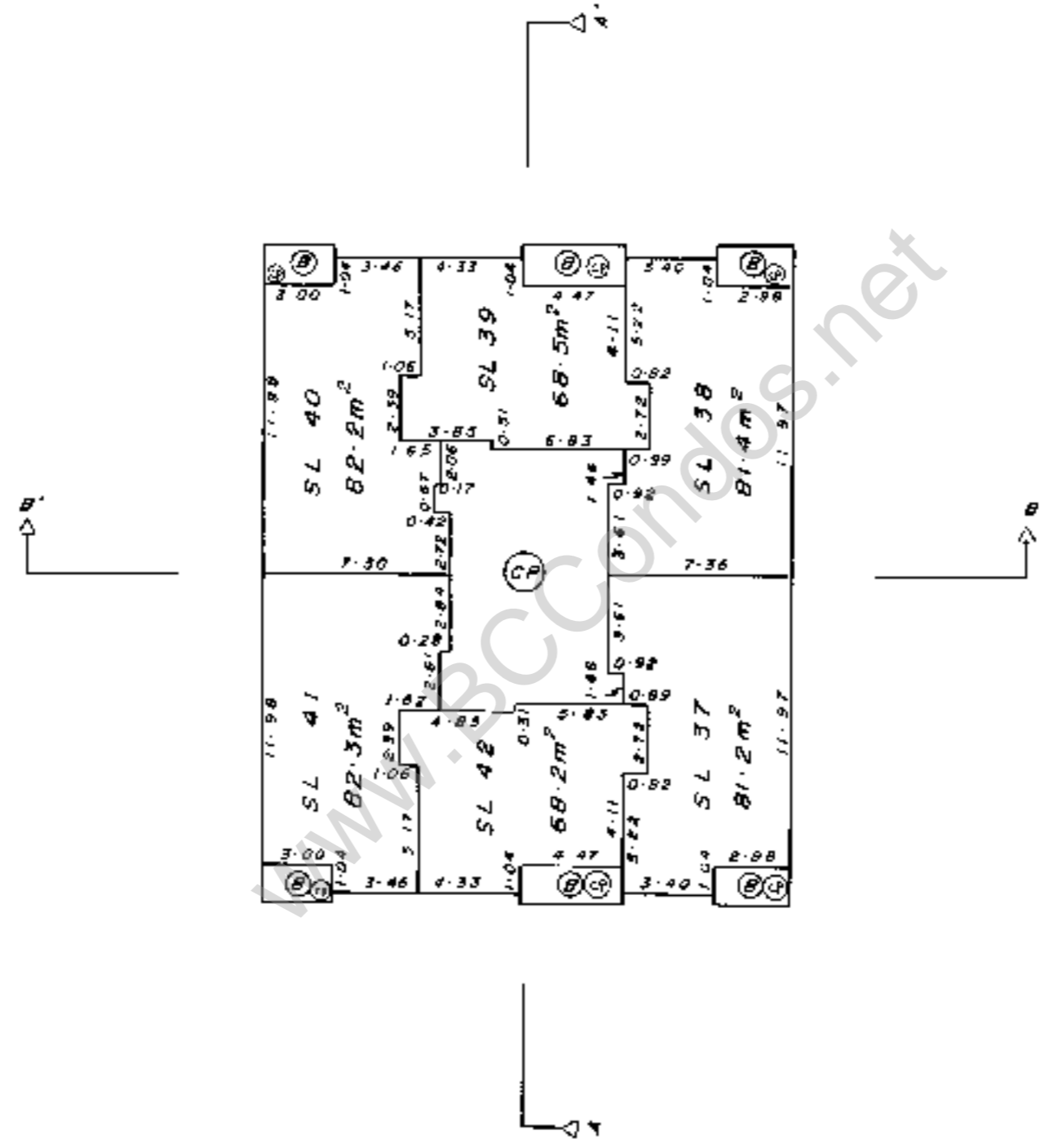

07.10.91

EK 1/18/25/81
FILE 6744 (S)(E)

STRATA PLAN NW 1630

NINTH FLOOR

SCALE 1:250

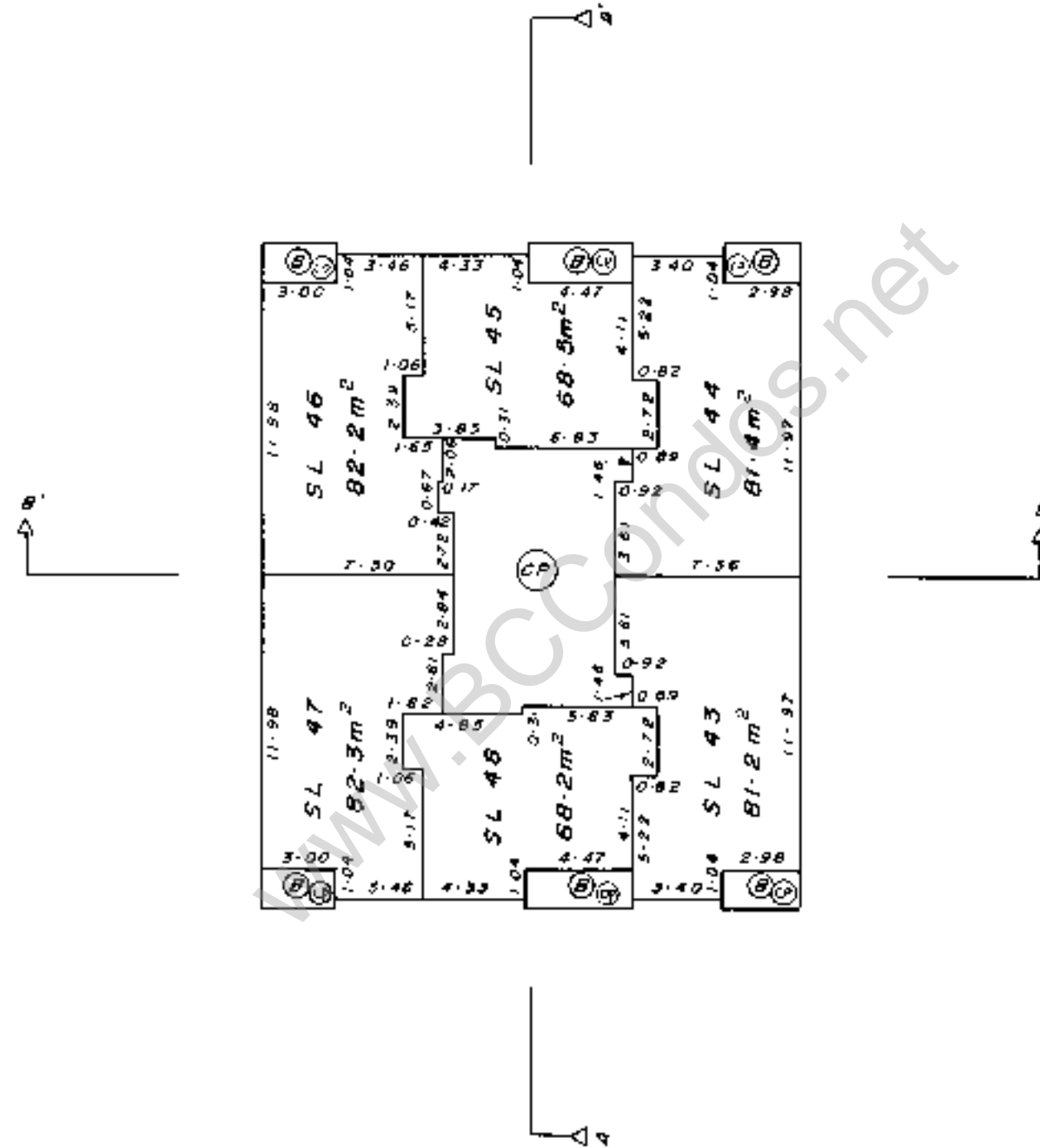

C.S. 25/01

SE MAY 25/81

FILE 6744 (S)(E)

STRATA PLAN NW 1630

TENTH FLOOR

SCALE 1:250

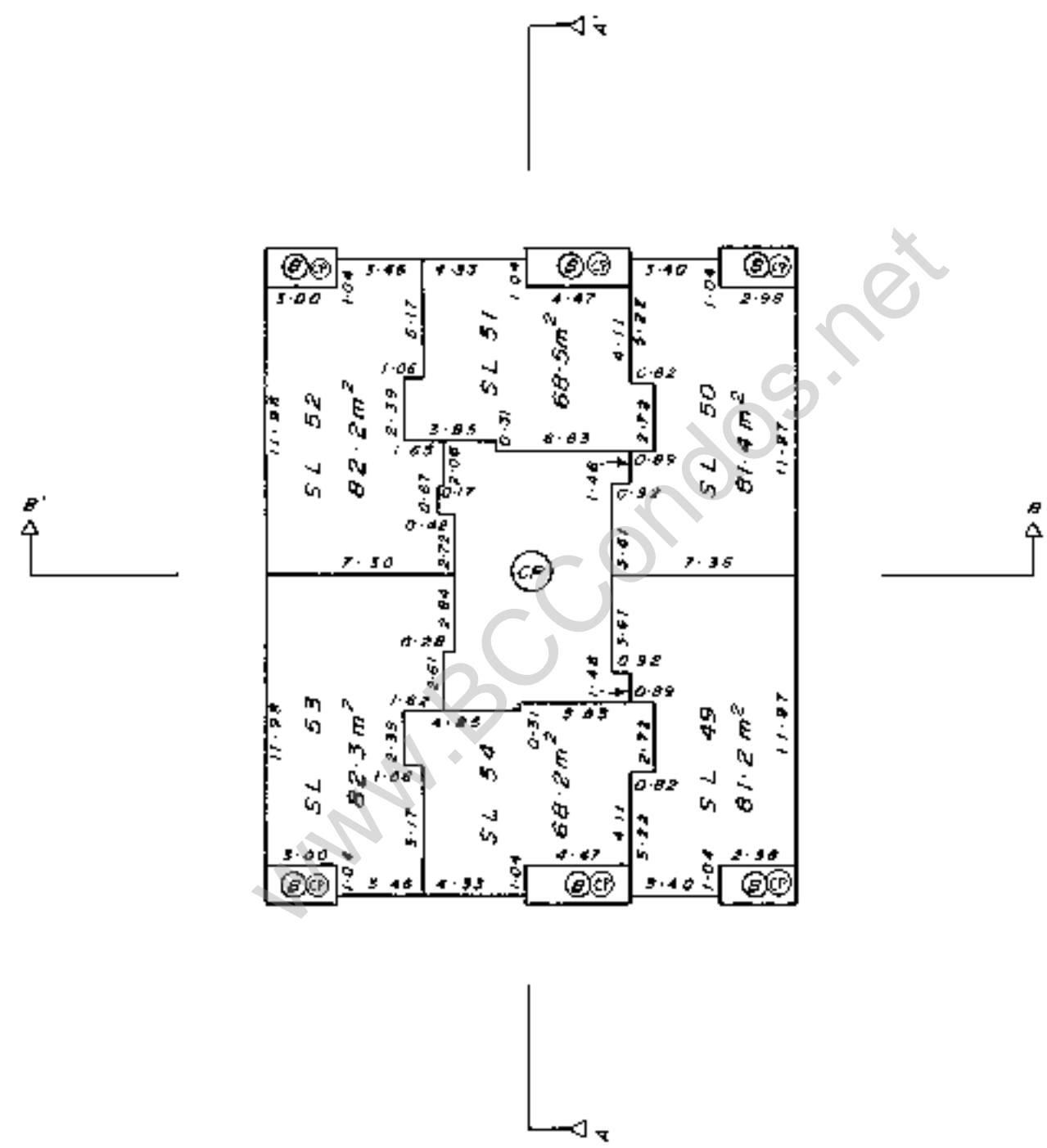

C/S 0017

EL MAY 25/81
FILE 6744 (S)(E)

STRATA PLAN NW 1630

ELEVENTH FLOOR

SCALE 1:250

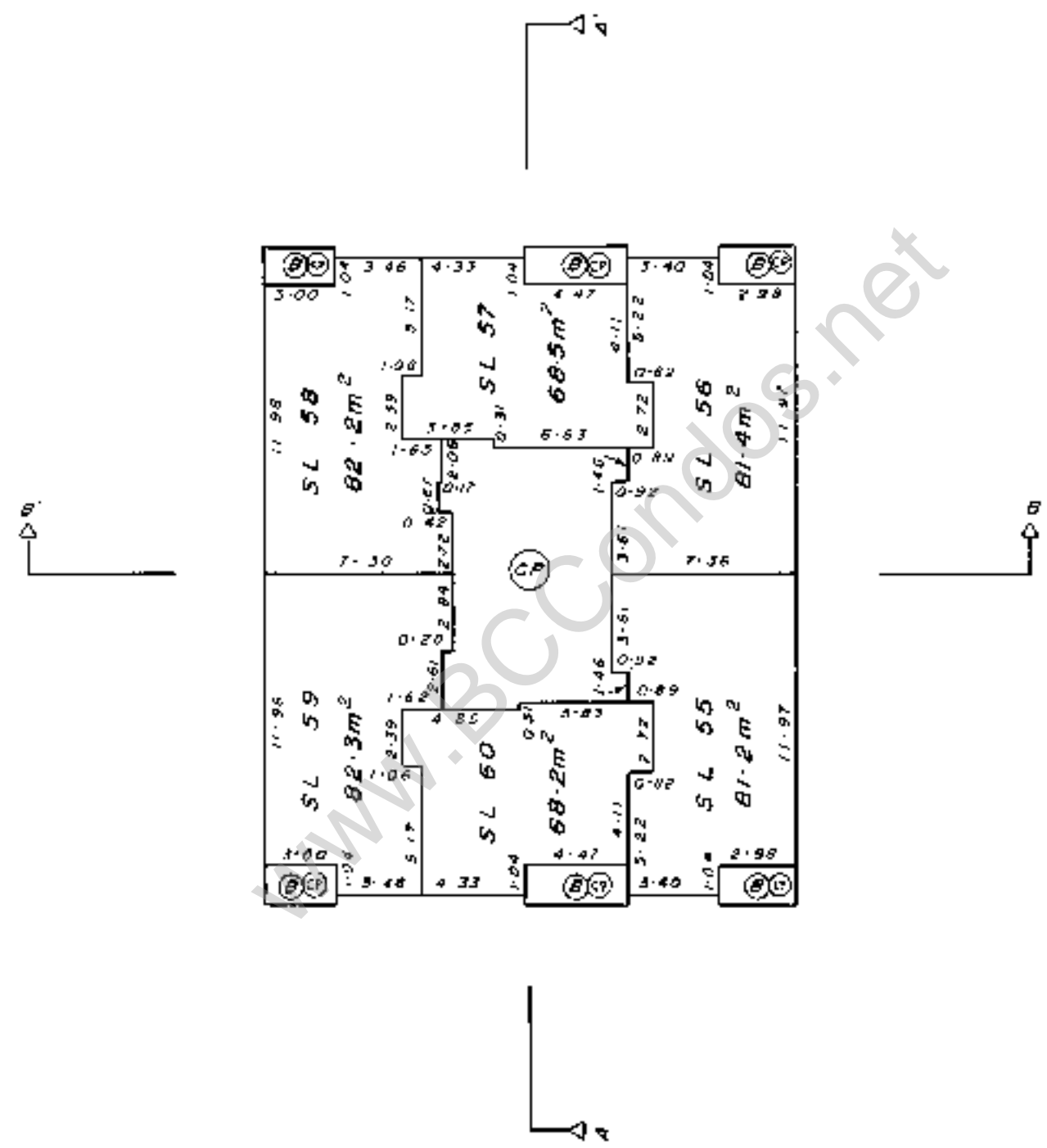

C/S 0007

EX MAY 25/81

FILE 6744 (SKE)

STRATA PLAN NW 1630

TWELFTH FLOOR

SCALE 1 : 250

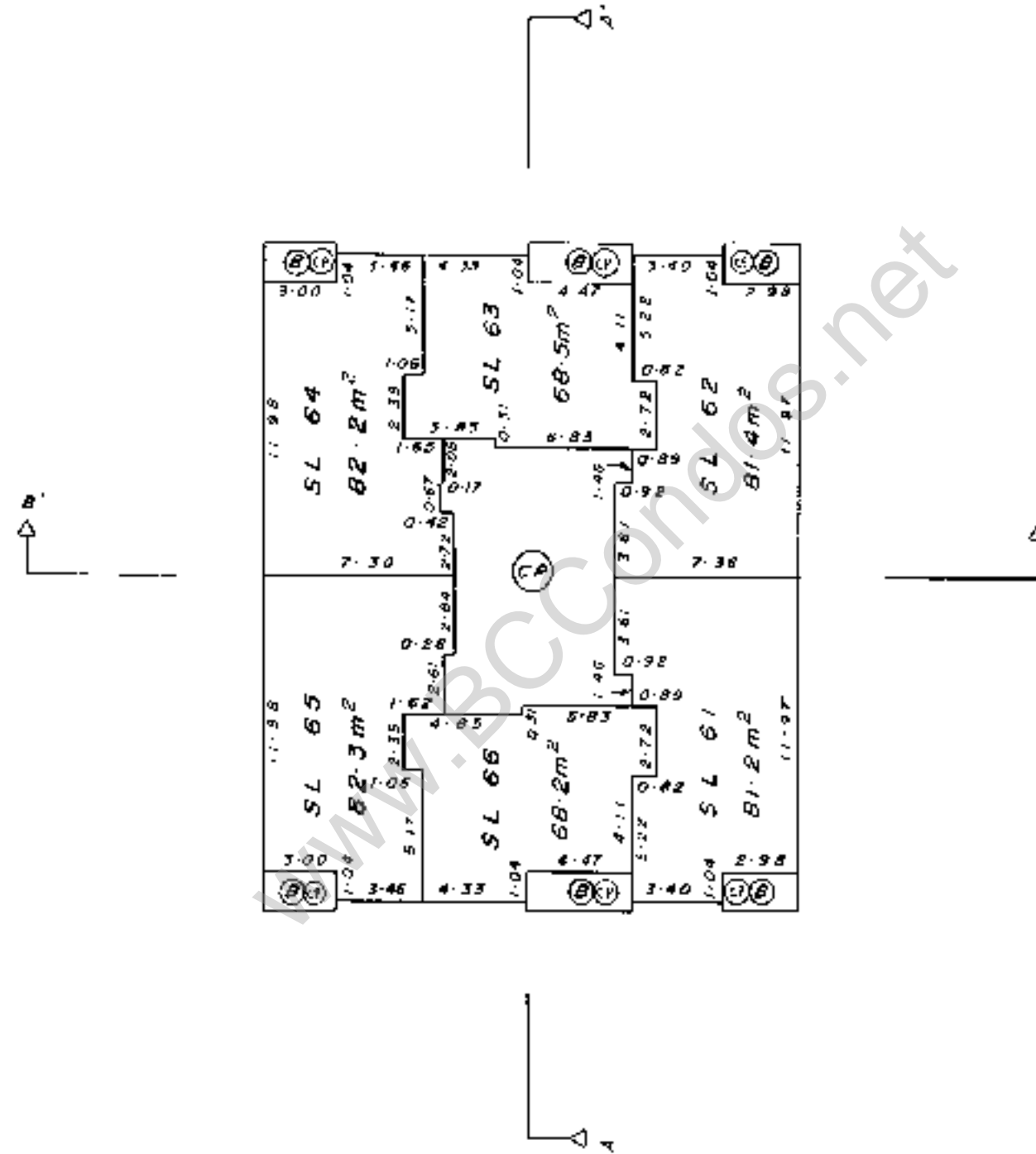

02 2007

EC MAY 25/81
FILE 6744 (S)(E)

STRATA PLAN NW 1/2

THIRTEENTH FLOOR

SCALE 1 : 250

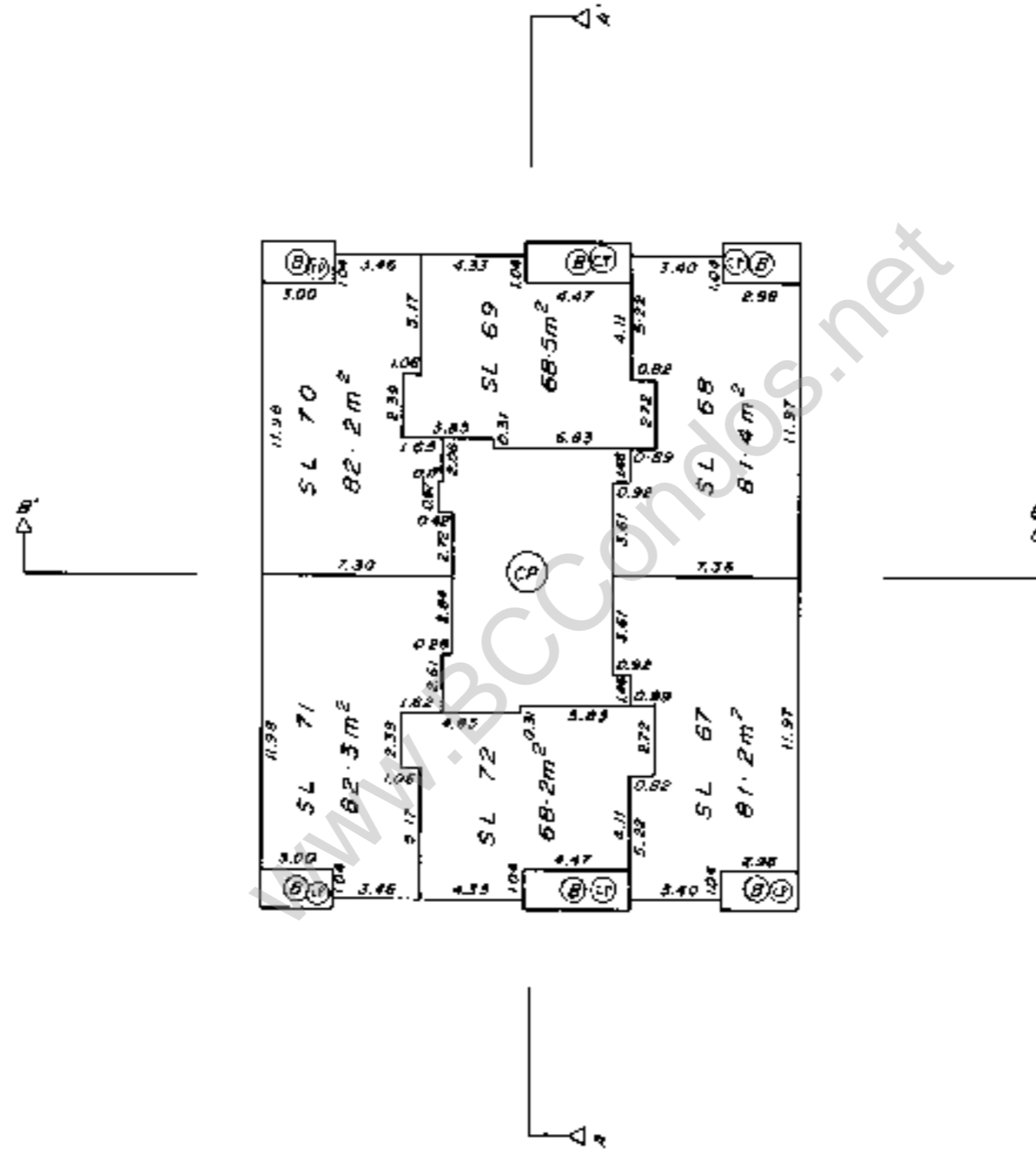

EX MAY 25/21
FILE 6744(S)(E)

STRATA PLAN NW 1630

FOURTEENTH FLOOR

SCALE 1 : 250

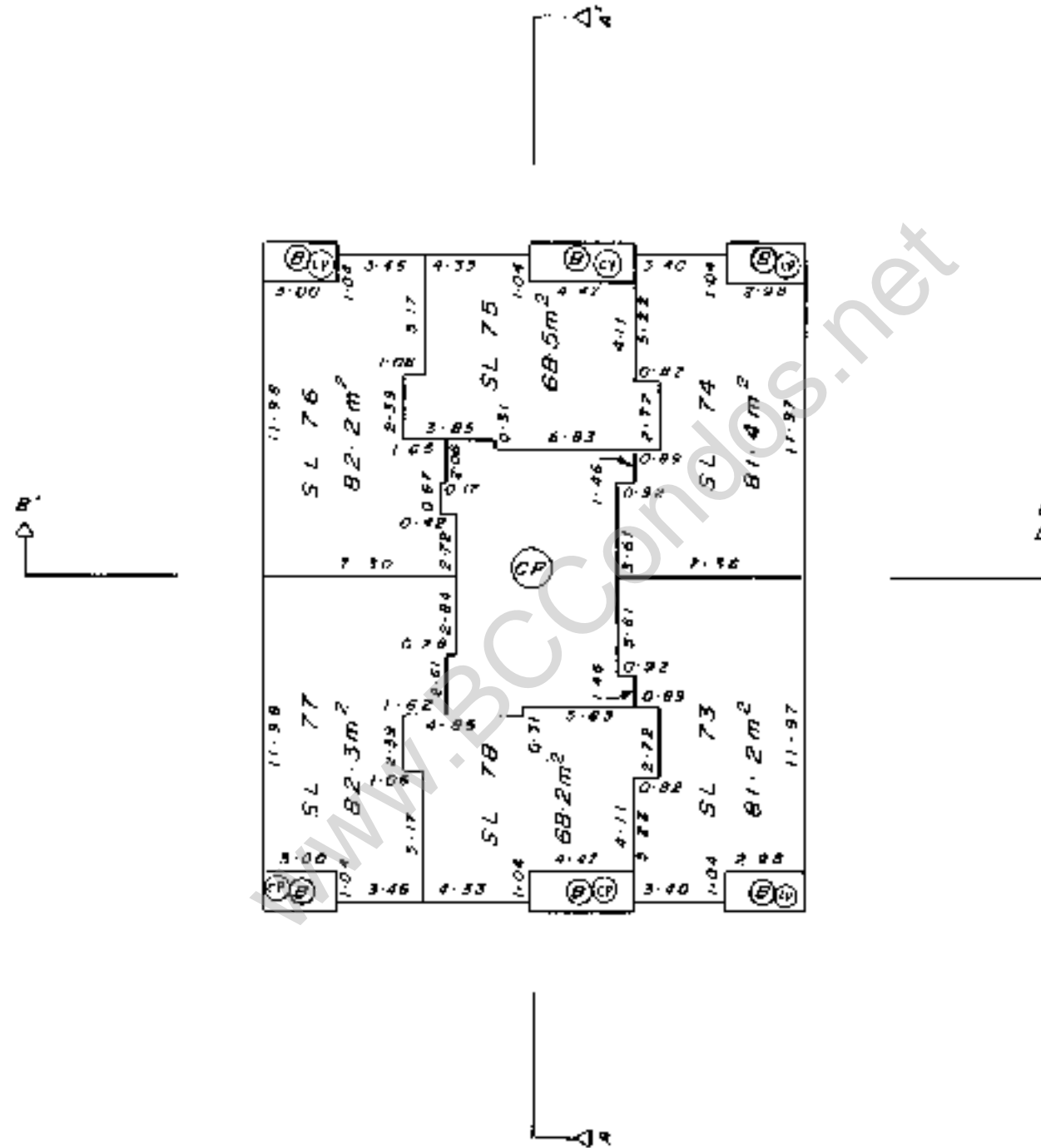

C.S. 504

EK MAY 25/81
FILE 6744 (SNE)

STRATA PLAN NW 1630

FIFTEENTH FLOOR

SCALE 1 : 250

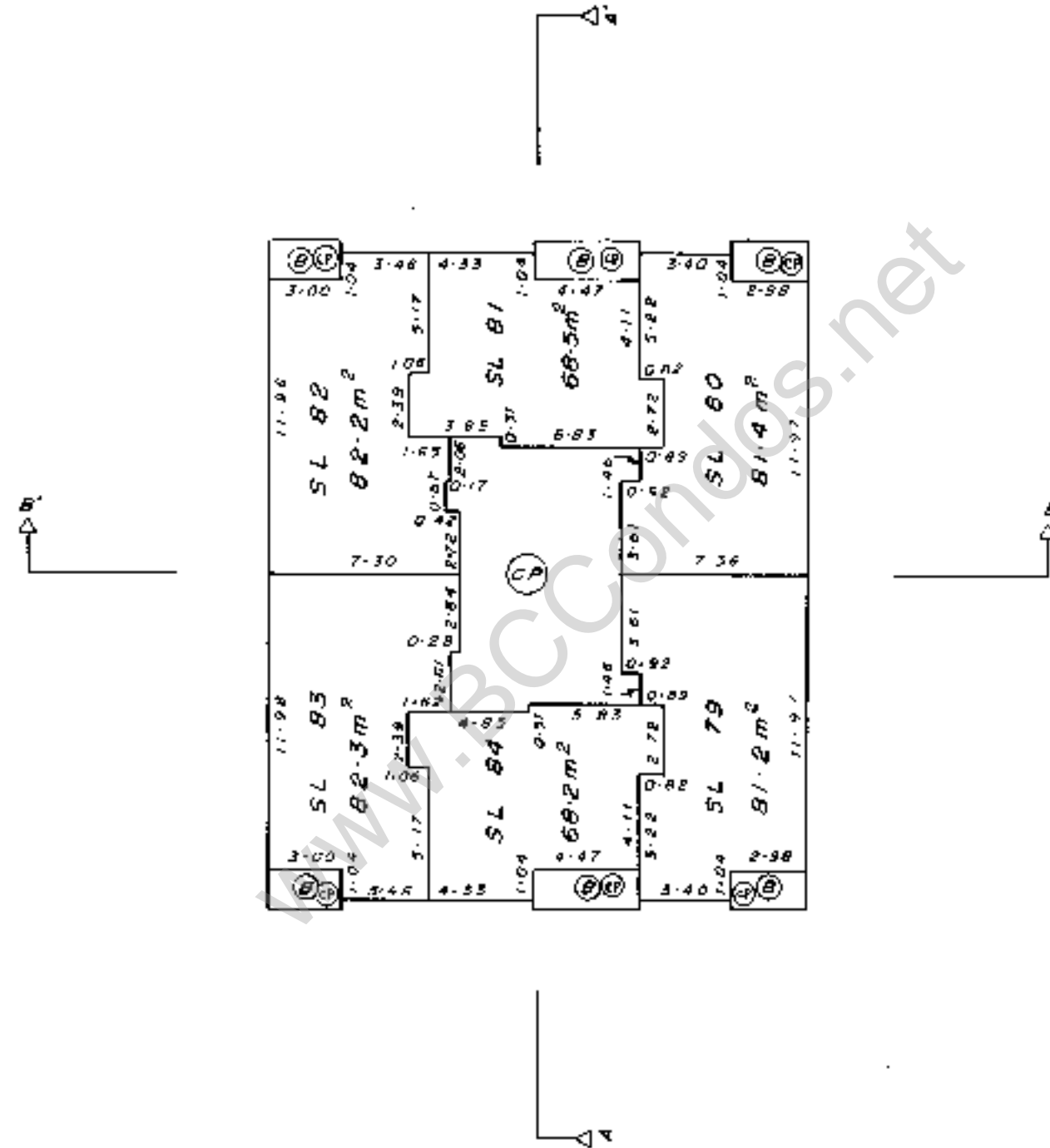

EE MAY 25/81

FILE 6744 (SHE)

STRATA PLAN NW 1426

SIXTEENTH FLOOR

SCALE 1 : 250

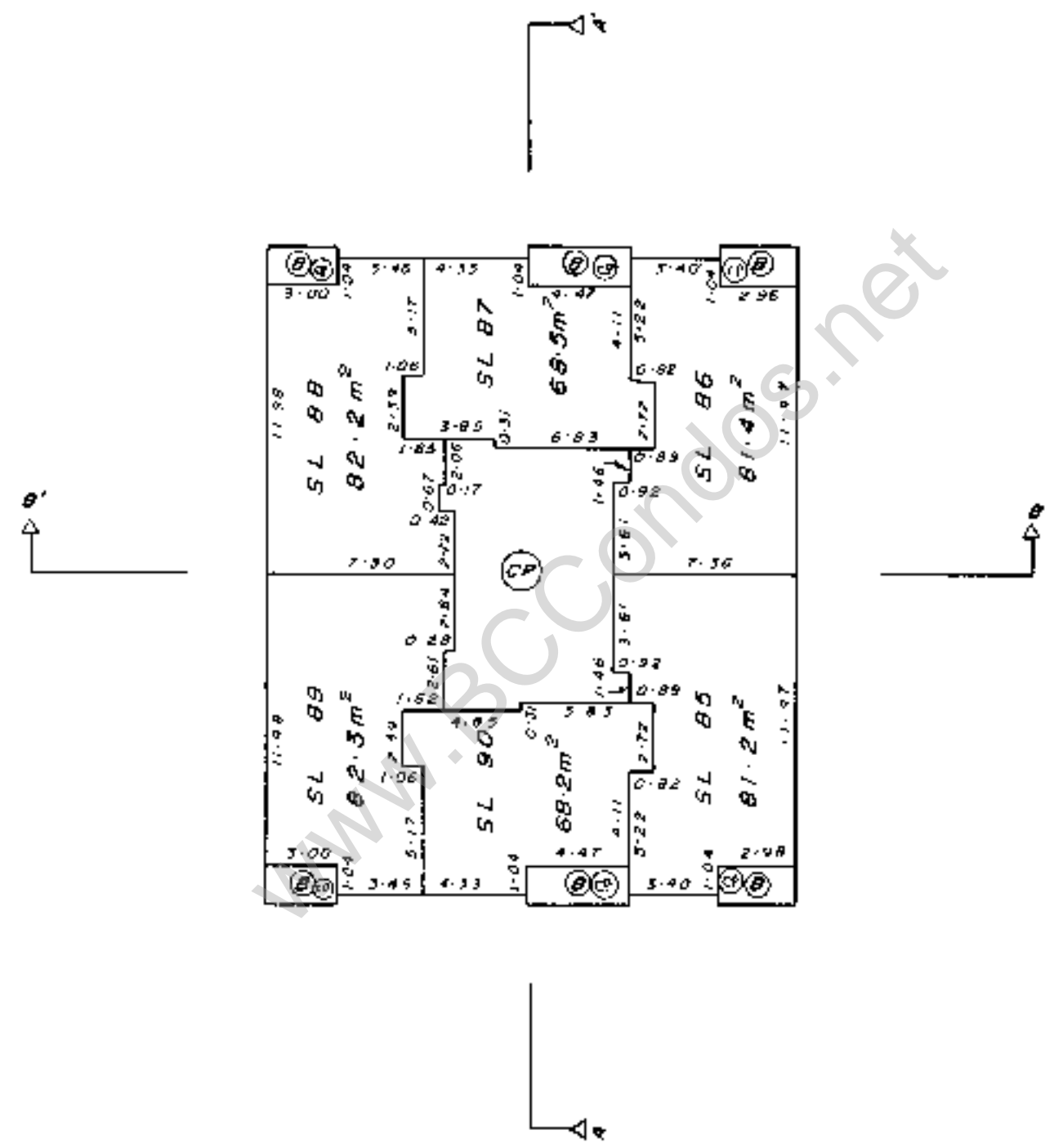

EL MAY 25/81

FILE 6744 (S)(E)

STRATA PLAN NW 1630

SEVENTEENTH FLOOR

SCALE 1 : 250

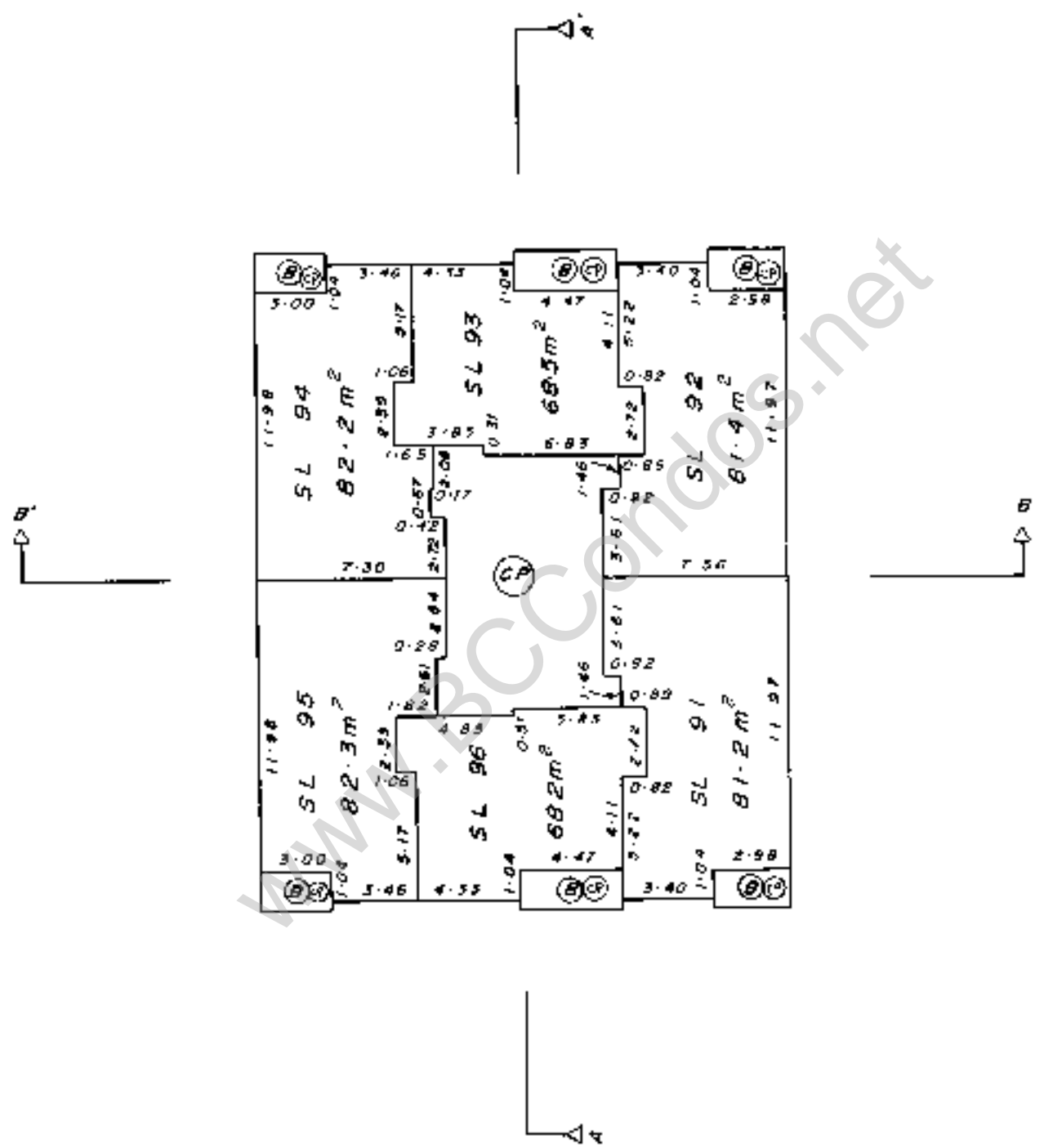

EX MAY 25/81
FILE 6744(S)(E)

STRATA PLAN NW 1/63/1

EIGHTEENTH FLOOR

SCALE 1 : 250

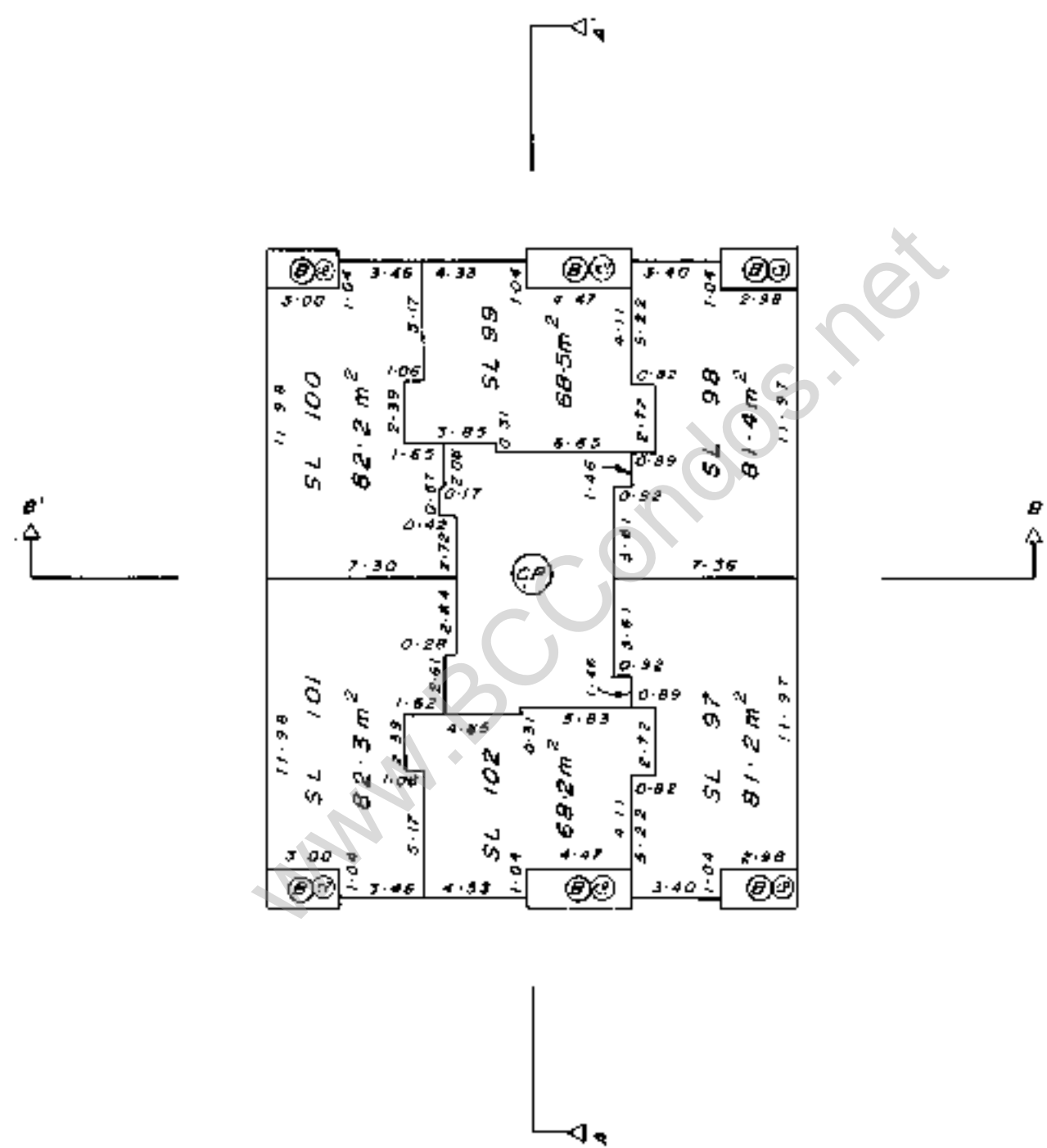

EK 11/17 25/87
FILE 6744(S)(E)

STRATA PLAN NW *1/2*

NINETEENTH FLOOR

SCALE 1 : 250

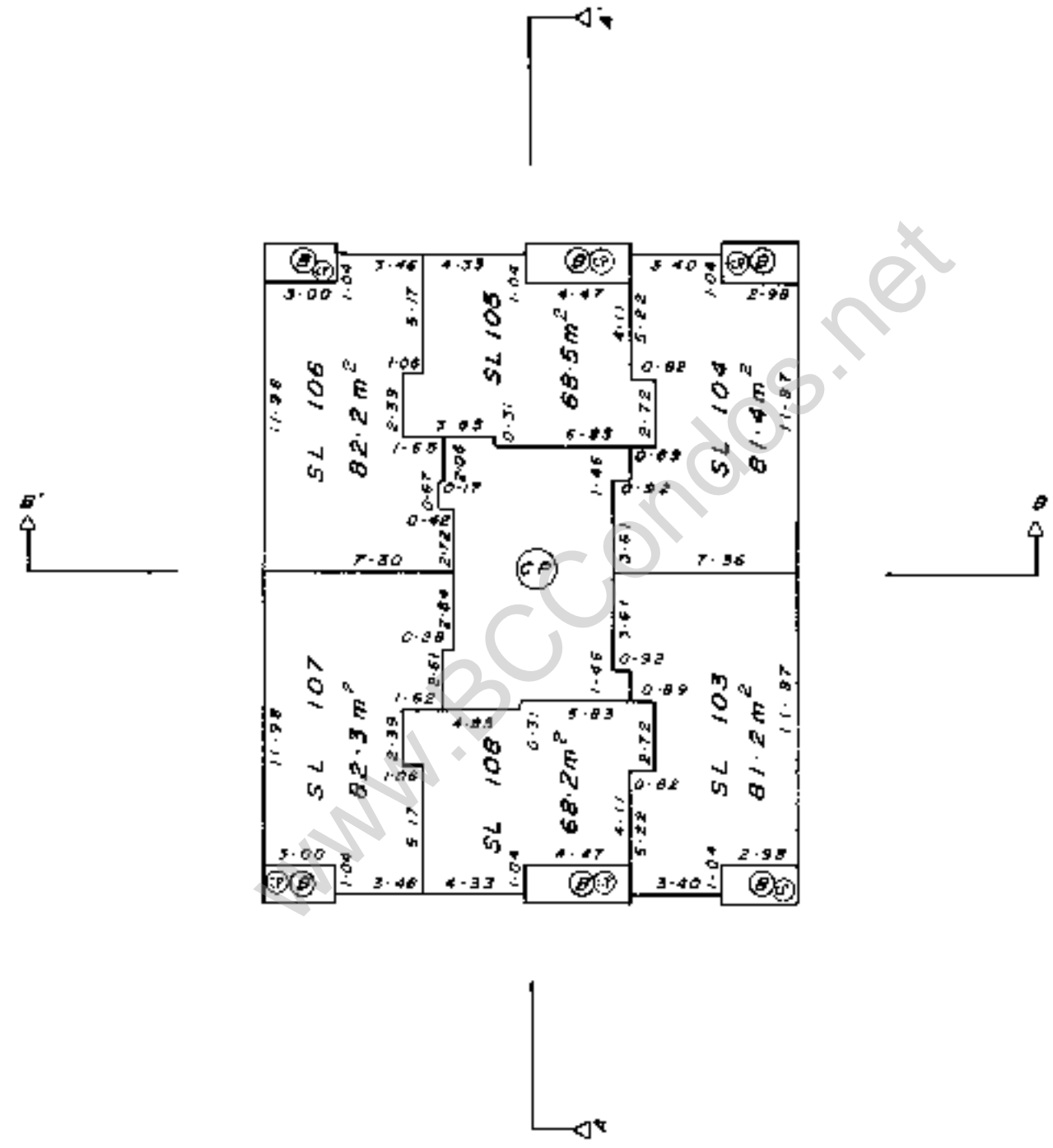

C-5 10/81

EX MAY 25/81
FILE 6744(SXE)

STRATA PLAN NW 102/1

TWENTIETH FLOOR

SCALE 1 : 250

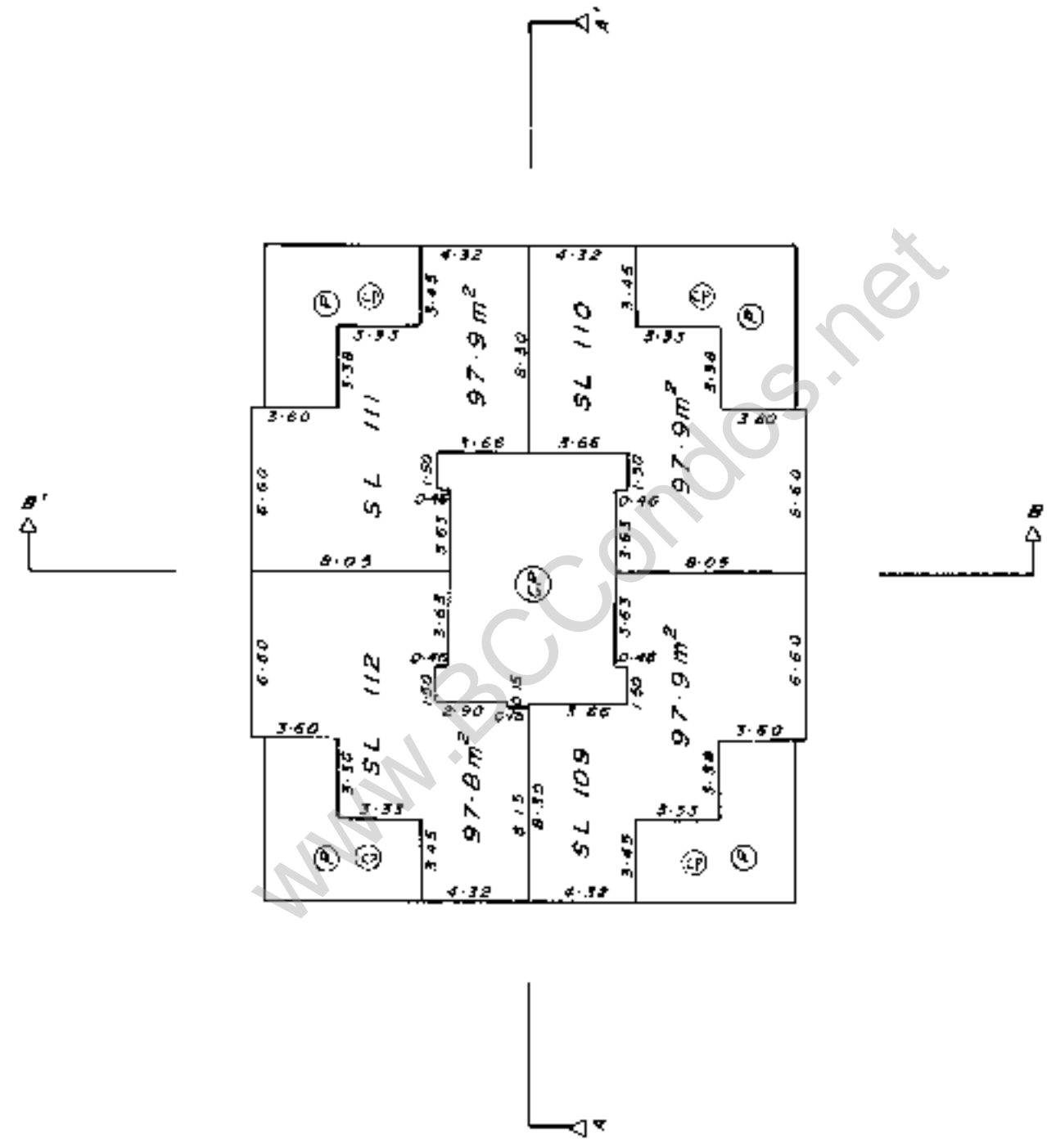

PK MAY 25/81

FILE 6744(SKE)

STRATA PLAN NW 1630

MAIN ROOF LEVEL

SCALE 1 : 250

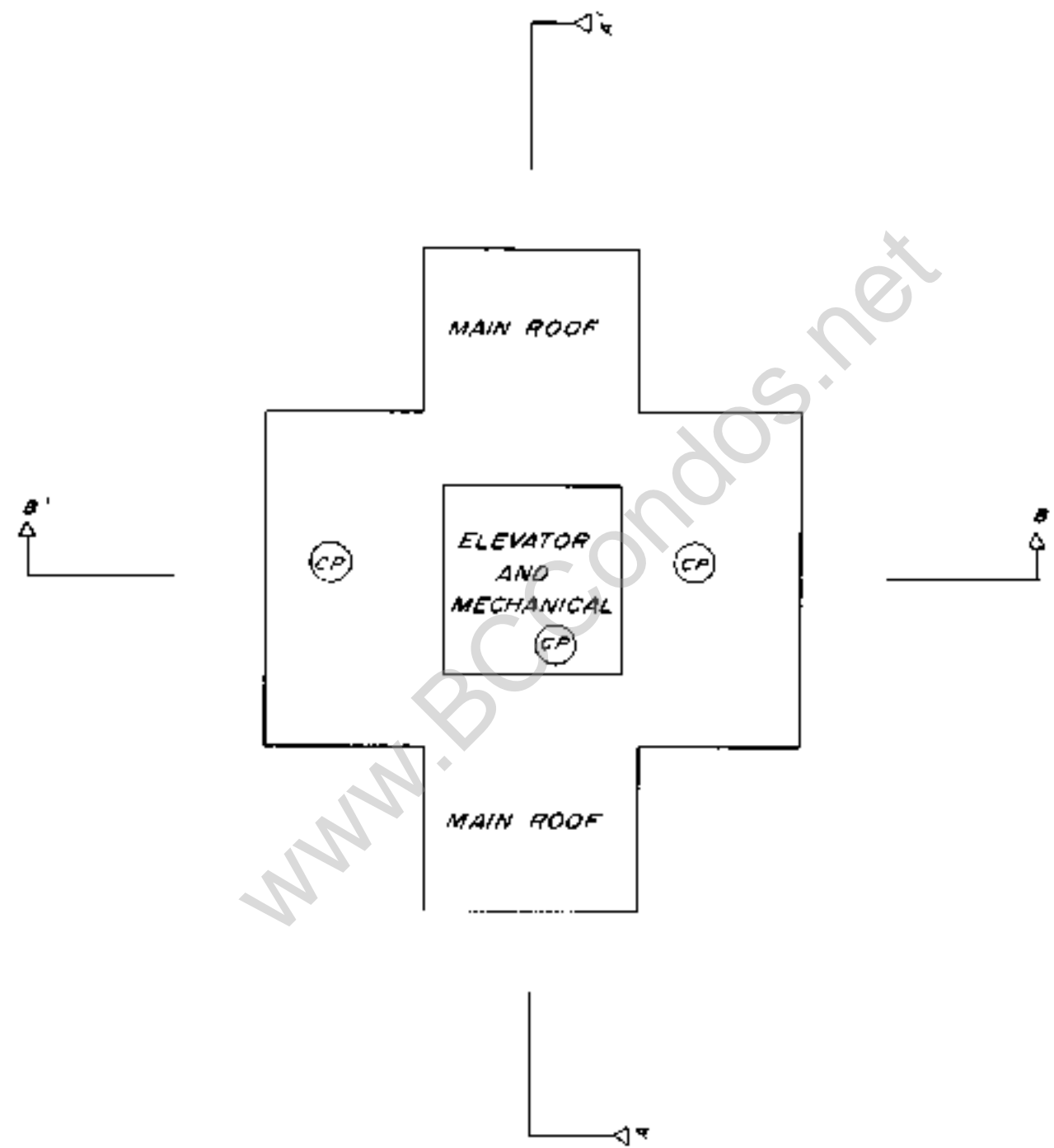

WWW.BCcondos.net

1208 51.3

EL. ART 25181
FILE 6744(S)(E)

STRATA PLAN NW 110.30

ELEVATOR AND MECHANICAL LEVEL

SCALE 1 : 250

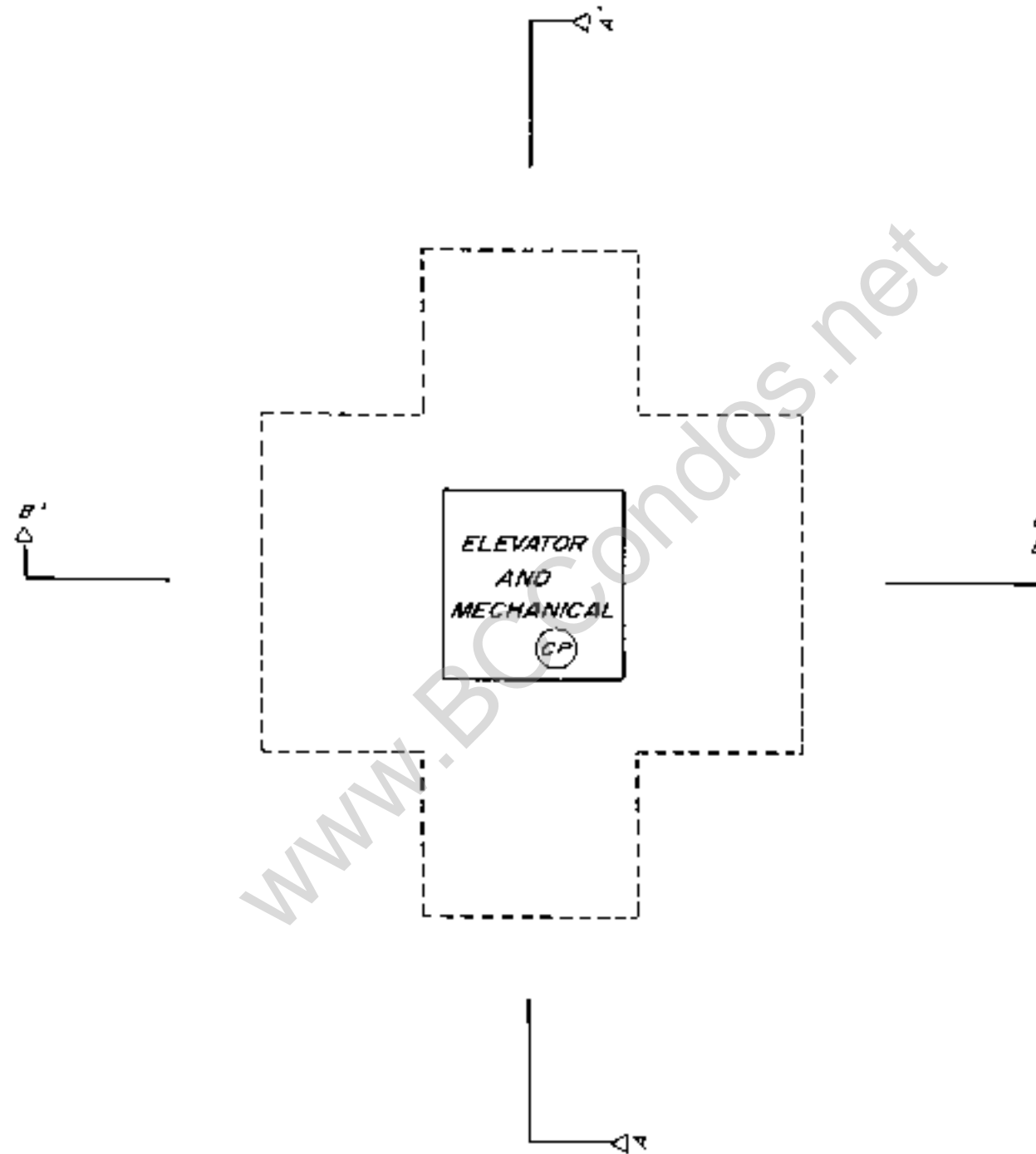

www.BCcondos.net

EK MAY 25/81
FILE 6744(S)(E)

STRATA PLAN NW 1630

UPPER ROOF LEVEL

SCALE 1 : 250

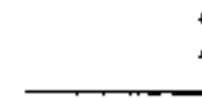
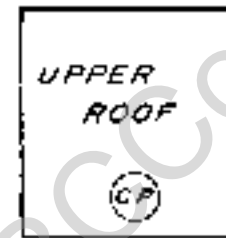
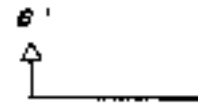
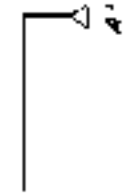

www.BCCcondos.net

EX 111 25/81

FILE 6744 (S)(E)

Property Sheet Closed

Search ALTOS2 or BC Online for Current Information. BC Reg. 76/95



LINDA J O'SHEA, Registrar
Vancouver/New Westminster Land Title Office

STRATA PLAN NW

DEALINGS AFFECTING THE COMMON PROPERTY

REGISTRATION		DOCUMENT		REGISTRATION		DOCUMENT	
NUMBER	DATE	DATE	NATURE OF PARTICULARS	NUMBER	DATE	DATE	NATURE OF PARTICULARS
CLAIM BY 174435 By 175863	12.3.82 14:14		PARTEC SYSTEMS LTD 13.11.82				HERE TO IS ANNEXED EASEMENT BY 175868 OVER PART SHOWN HATCHED (PLAN 64931) STRATA PLAN NW 1629
EASEMENT By 175863	4.10.82 14:40		PART (PLAN 64924) APPURTENANT TO STRATA PLAN NW 1629				HERE TO IS ANNEXED EASEMENT BY 175869 OVER PART (PLAN 64931) OF STRATA PLAN NW 1629
EASEMENT By 175864	4.10.82 14:40		APPURTENANT TO STRATA PLAN NW 1629				HERE TO IS ANNEXED EASEMENT BY 175870 OVER STRATA PLAN NW 1629
EASEMENT By 175865	4.10.82 14:40		PART IN HEAVY OUTLINE (PLAN 64931) APPURTENANT TO STRATA PLAN NW 1629	EASEMENT By 175870	4.10.82 14:40		APPURTENANT TO STRATA PLAN NW 1629
			HERE TO IS ANNEXED EASEMENT BY 175865 OVER PART IN HEAVY OUTLINE (PLAN 64931) STRATA PLAN NW 1629				HERE TO IS ANNEXED EASEMENT BY 175870 OVER STRATA PLAN NW 1629
EASEMENT By 175866	4.10.82 14:40		APPURTENANT TO STRATA PLAN NW 1629				
			HERE TO IS ANNEXED EASEMENT BY 175866 OVER STRATA PLAN NW 1629				
EASEMENT By 175867	4.10.82 14:40		PART SHOWN HATCHED (PLAN 64931) APPURTENANT TO STRATA PLAN NW 1629				
			HERE TO IS ANNEXED EASEMENT BY 175867 OVER PART SHOWN HATCHED (PLAN 64931) STRATA PLAN NW 1629				
EASEMENT By 175868	4.10.82 14:40		PART SHOWN HATCHED (PLAN 64931) APPURTENANT TO STRATA PLAN NW 1629				

24 MAY 25/81
FILE 6744 (S)(E)