



ASTON

A SELECTION OF
PRESTIGIOUS 3-BEDROOM
TOWNHOMES FROM
LISTRAOR'S OAK STREET
LUXURY COLLECTION

PREVIEW PACKAGE

BUILT BY
LISTRAOR

MARKETING
AND SALES BY

BLVD

REFINED WESTSIDE LIVING



TIMELESS DETAILING AND NATURAL WARMTH



EXCLUSIVE OUTDOOR LIVING SPACES



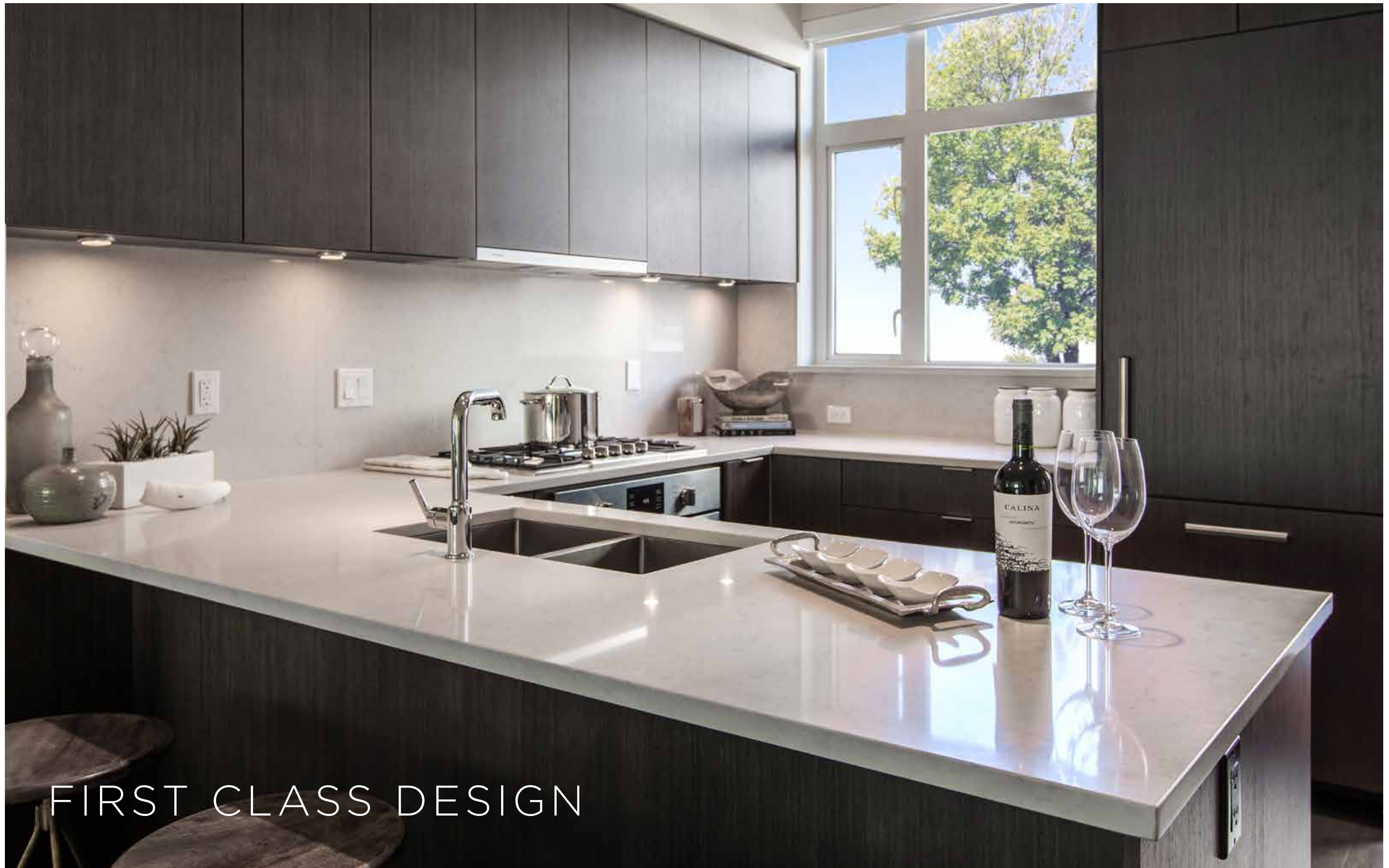

FIRST CLASS DESIGN

CONTEMPORARY COMFORT

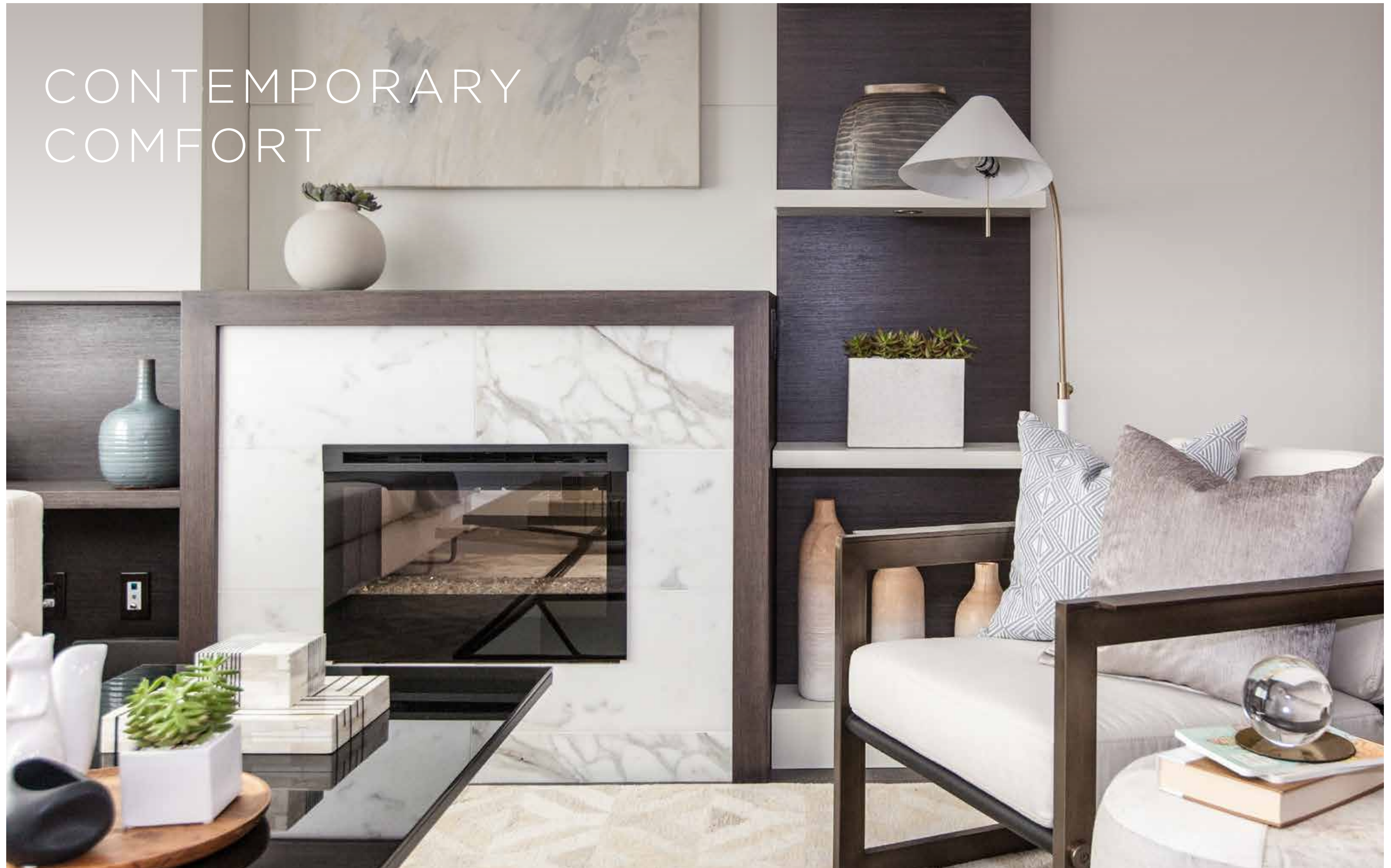

THE ART OF
LIVING WELL



ASTON

FOUR LEVELS OF FANTASTIC SPACE



A

THE FINER THINGS. FINELY CRAFTED.

1

GOURMET KITCHENS FEATURE MODERN CABINETS, SOFT-CLOSE HINGES, SOLID QUARTZ COUNTERTOPS AND INTEGRATED BOSCH APPLIANCE PACKAGE

2

OPEN AND SPACIOUS LIVING ON THE MAIN FLOOR ALLOWS FOR A SEAMLESS AND ENGAGING ENVIRONMENT TO BE ENJOYED BY FAMILY AND FRIENDS

3

EXTEND LIVING OUTSIDE WITH AN ENTERTAINMENT-SIZED PATIO AND ROOF TOP BALCONY

4

GENEROUS IN-HOME STORAGE AND LOWER-LEVEL FLEX SPACE PROVIDES A GREAT ENTERTAINMENT ROOM, IN-HOME GYM OR OFFICE

5

SPA-INSPIRED ENSUITES FEATURE DOUBLE VANITY SINKS WITH SOLID QUARTZ COUNTERTOPS AND BACKSPLASH

6

MASTER BEDROOMS ARE A PRIVATE OASIS WITH A LARGE WALK-IN CLOSET AND PRIVATE BALCONY TO ENJOY MORNING COFFEE

7

MULTIPLE WINDOWS THROUGHOUT EACH HOME DELIVER AMPLE NATURAL LIGHT TO ILLUMINATE EVERY SPACE INCLUDING THE GOURMET KITCHEN

8

ENGINEERED WIDE-PLANK KENTWOOD HARDWOOD FLOORING THROUGHOUT MAIN LIVING SPACES

9

SPACIOUS SECOND BEDROOM FUNCTIONS AS ADDITIONAL MASTER BEDROOM WITH WALK-IN CLOSET AND PRIVATE ENSUITE BATHROOM

10

CONVENIENT DIRECT IN-HOME ACCESS TO TWO SIDE-BY-SIDE PARKING SPACES



ASTON

FEATURES

ASTON HOMES ARE METICULOUSLY
ENGINEERED FOR SPACIOUS FAMILY
LIVING AND EXUDE A REFINED LAYOUT
SHOWCASING LUXURIOUS FEATURES

ENTICING MODERN EXTERIORS

- Contemporary West Coast design and striking white-brick architecture by Raymond Letkeman Architecture
- Natural wood highlights and lush landscaping add warmth to an established entry pavilion
- Private landscaped courtyard with secluded private patios

INSPIRING INTERIORS

- Choose from two contemporary colour schemes: Light, led by warm grey, and Dark, featuring natural brown tones
- Engineered wide-plank Kentwood hardwood flooring in Quartz anchors living spaces
- Lush 100% wool carpet in bedrooms, hallways and lower flex space
- Overheight 9' ceilings in main living areas provide an air of openness
- Electric fireplace with millwork mantle and Calcutta marble surround
- Generous use of potlights throughout the main floor
- Brushed oak stair railing with tempered glass infill
- Full size energy efficient washer and dryer by Whirlpool

GOURMET KITCHENS

- Caesarstone quartz countertops with corresponding full height backsplash in London Grey
- Stainless steel undermount double-bowl sink with:
 - High-speed Waste King garburator
 - Contemporary single-lever chrome faucet by Kohler
- Elegant custom raised cabinetry in Wordly Gray or modern flat panel available in dark stained Oak
- Sleek Brushed edge-pull cabinet hardware with soft close doors and drawers
- Convenient under-cabinet task lighting
- Premium Bosch stainless steel appliance package collection:
 - Integrated 30" Refrigerator with bottom freezer
 - Gas cooktop with wok station and separated self-cleaning wall oven
 - Powerful Faber 600 CFM hood fan
 - Fully integrated energy efficient dishwasher

TRANQUIL BATHROOMS

- Smooth Caesarstone quartz countertops and backsplash in London Grey or Misty Carrera
- Classic porcelain tile flooring in Oyster Grey
- Crisp white undermount rectangular basin sink
- Modern over-counter powder room sink set on floating vanity
- Modern deep soaker bathtub surrounded by luxurious white ceramic tile
- Sleek polished chrome accessories and faucets by Kohler
- Water efficient dual flush, soft-close toilets
- Ensuite accent wall finished with matte porcelain tile in Bianco or Grogio

ADDITIONAL COMFORTS

- Extensive engineered soundproofing measures including triple glaze architectural windows
- Direct in home access to two side-by-side parking spaces included within most three bedroom homes
- Generous in home storage and lower level flex space, designed for family living
- Spacious private master bedroom patio decks
- High efficiency air source heat pump controlled by the Nest learning thermostat
- Pre-wired for security
- Constructed to Built Green Gold and EnerGuide 84 Standards
- Travellers Insurance Company of Canada 2-5-10 Comprehensive Warranty
 - Two years on labour and materials
 - Five years on building envelope
 - Ten years for structure

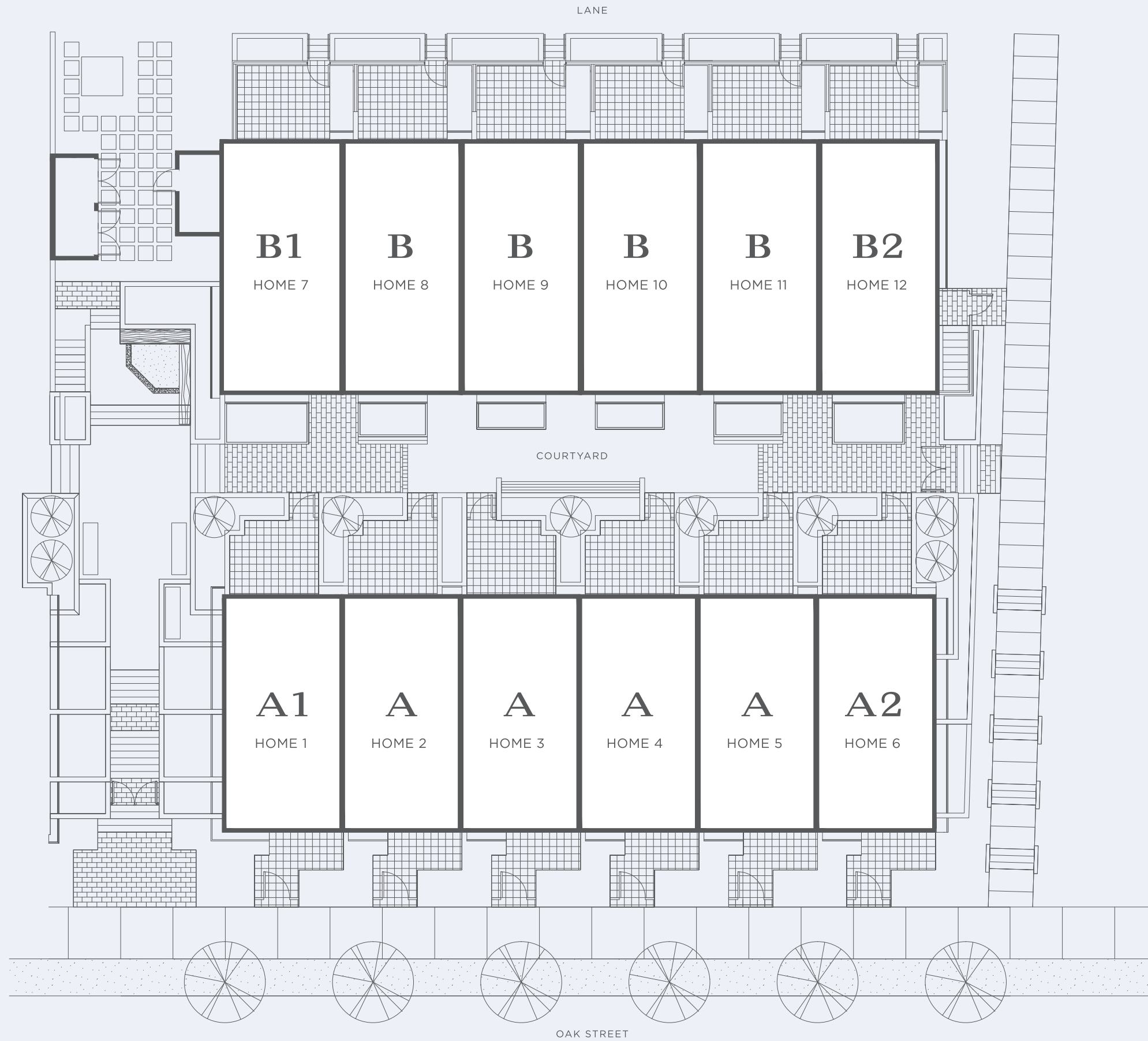

SITE PLAN

Dimensions, sizes, specifications, layouts and materials are approximate only and subject to change without notice. E&OE.



PLAN A1

3 Bedroom
+ Den & Flex
1,630 sq.ft

HOME 1



B1	B	B	B	B	B2
A1	A	A	A	A	A2

Dimensions, sizes, specifications, layouts and materials are approximate only and subject to change without notice. E&OE.



PLAN A

3 Bedroom
+ Den & Flex
1,618 sq.ft

HOMES 2, 3, 4, 5



Dimensions, sizes, specifications, layouts and materials are approximate only and subject to change without notice. E&OE.



PLAN A2

3 Bedroom
+ Den & Flex
1,630 sq.ft

HOME 6



B1	B	B	B	B	B2
A1	A	A	A	A	A2

Dimensions, sizes, specifications, layouts and materials are approximate only and subject to change without notice. E&OE.



PLAN B1

3 Bedroom
+ Den & Flex
1,755 sq.ft

HOME 7

B1	B	B	B	B	B2
----	---	---	---	---	----

A1	A	A	A	A	A2
----	---	---	---	---	----

Dimensions, sizes, specifications, layouts and materials are approximate only and subject to change without notice. E&OE.



PLAN B

3 Bedroom
+ Den & Flex
1,746 sq.ft

HOMES 8, 9, 10, 11

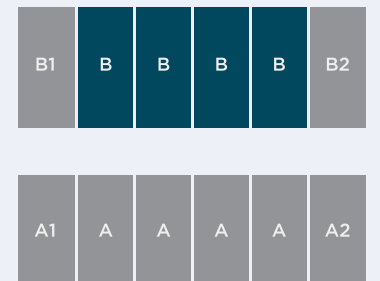

Dimensions, sizes, specifications, layouts and materials are approximate only and subject to change without notice. E&OE.



PLAN B2

3 Bedroom
+ Den & Flex
1,765 sq.ft

HOME 12

B1	B	B	B	B	B2
----	---	---	---	---	-----------

A1	A	A	A	A	A2
----	---	---	---	---	----

Dimensions, sizes, specifications, layouts and materials are approximate only and subject to change without notice. E&OE.