



Benchlands

REGISTER NOW

BENCHLANDS

THE BENCHLANDS NEIGHBOURHOOD DELIVERS A VARIETY OF HOMESITES WITH BIG, BIG VIEWS.

You'll love life up on the hill. Big views, larger lots, all set amongst vast expanses of granite outcroppings and ponderosa pine. Mere minutes to both tee-off at the golf course and take-off from the airport, the Benchlands offer the best of the Okanagan without the hustle and bustle of the city.

SITE PLAN



AMENITIES

The Benchland's 240-degree view offers an unbeatable vistas of Lake Okangan. The Centre Club, exclusive to residents and their guests, boasts a swimming pool, tennis and multi-sport courts, fitness centre, and coffee shop. Just steps from your front door is an entryway to our 25 km trail network as it winds to the upper reaches of Lakestone, and down to the lake.

CENTRE CLUB

SITE PLAN

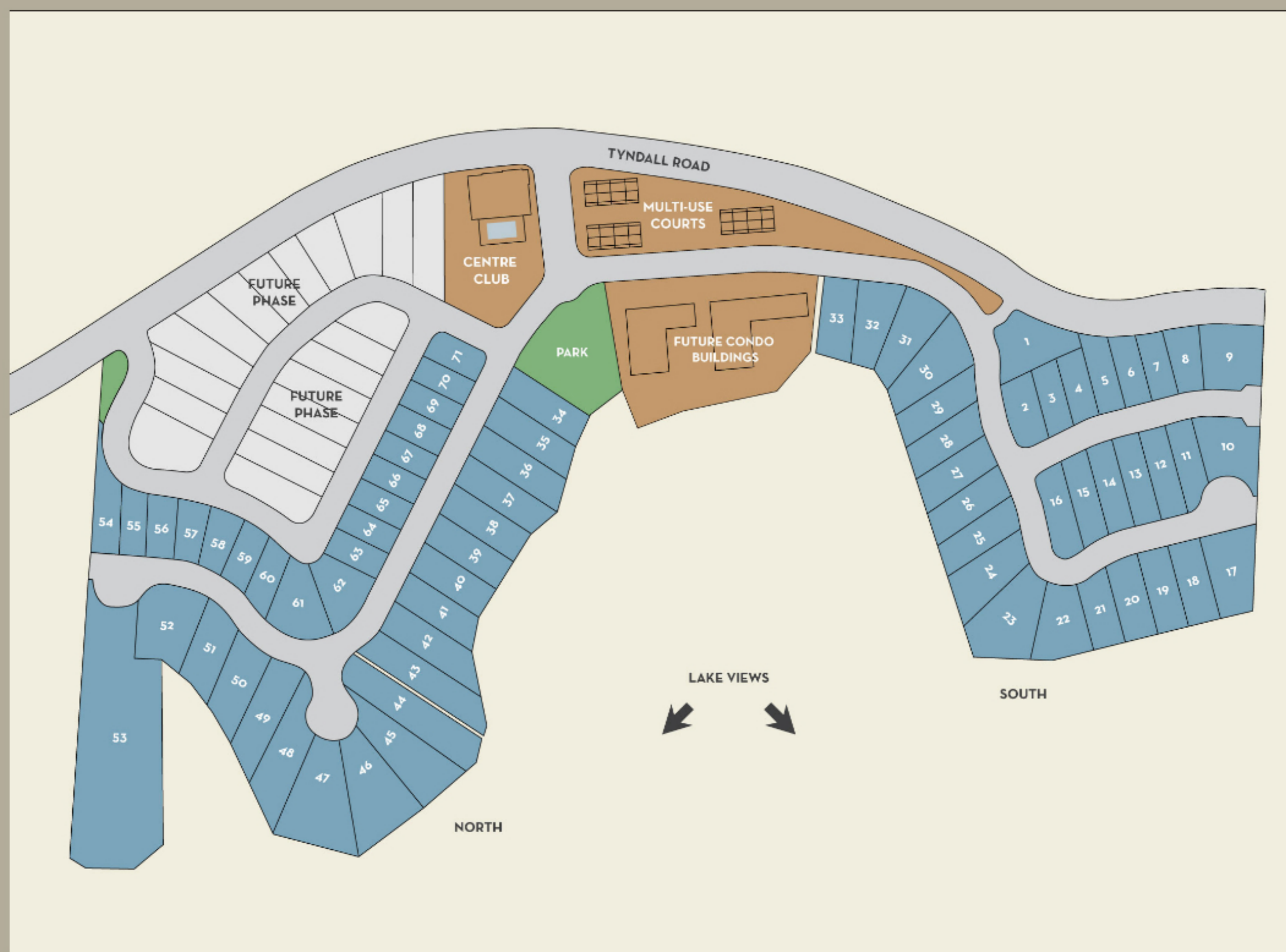

WATERSIDE

LEARN MORE



LAKE COUNTRY

LEARN MORE



THE DEVELOPER

LEARN MORE

REGISTER NOW

LAKESTONE
COME HOME TO THE LAKE

Lakestone is located in prime Lake Country, an extraordinary natural environment.



Latest News

- Lake Club Opens!
May 18, 2016
- Surf's up!
May 10, 2016
- Best construction year ever
January 12, 2016

MACDONALD
DEVELOPMENT CORPORATION

Vancouver Office
11th floor - 938 Howe Street
Vancouver, B.C. V6Z 1N9
Phone: 604.331.6018
Fax: 604.331.6048

COMMUNITY AMENITIES

THE LAKE CLUB

This spectacular \$3.5 million facility sets a new standard for amenities, offering a wide range of activities for pleasure-seekers of all varieties. Lakestone's Lake Club has lived up to its vision of being unrivalled in the Okanagan.

The Lake Club is the perfect setting to gather with family, meet new neighbours and reconnect with old friends. The views are endless, and the memories created will last a lifetime.

THE FEATURES

- Fully equipped fitness centre
- Swimming pool and two hot tubs
- Kayak and paddleboard storage just steps from the beach
- Outdoor kitchen, BBQ, and entertainment area on the pool deck
- Covered rooftop terrace with fireplace and casual seating
- His and hers change rooms with both indoor and outdoor shower facilities
- Direct access to Lakestone Beach



Pool and Clubhouse

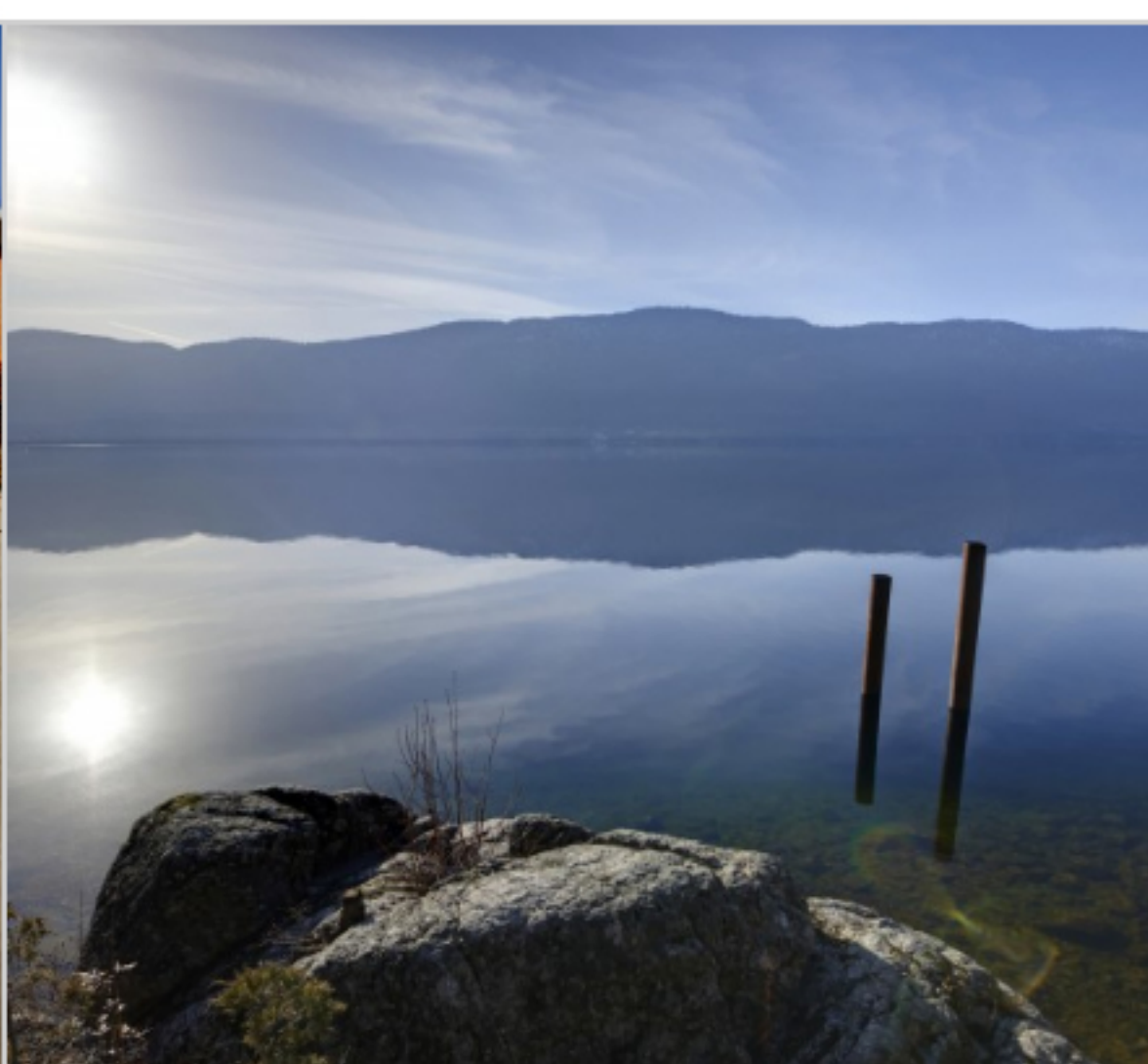

Future Home Of Community Dock



Pool With Clubhouse



Exquisitely Built Amenities



Large Private Patio With Stunning Views



State Of The Art Gym

THE CENTRE CLUB

This soon-to-be centerpiece of the Benchlands neighbourhood will become the heart of the Lakestone community. A coffee shop and mail services will make the Centre Club the place to meet your neighbours and create new friends.

The architecture for the Centre Club is "Contemporary Park Board", recalling the stone and wood structures often found in historic parks throughout the world. The style is at once familiar, yet appropriate for a forward-looking community like Lakestone.

THE FEATURES

The Club features a large workout room and yoga studio with adjacent change rooms and coffee shop. Everything opens up onto the pool terrace, where you can drink in west-facing lake views and beautiful landscaping from the hot tub or pool. Tennis and multi-sport courts, plus open space to toss a Frisbee or walk the dog, are also featured by this Benchlands amenity.

LAKESTONE BEACH

Steps down the trail from the Lake Club is direct lake access. The beach area features an attractive timber pavilion, reflecting the architectural style of Lakestone. Picnic tables and loungers are also available for waterside relaxation. Kayak racks and storage for rowboats and paddleboards allow you to take advantage of all the lake has to offer.

The natural lake bed and vegetation have been retained to protect this significant Kokanee spawning ground, with specific locations provided for kayak or paddleboard launching. A quiet water area in front of the club's dock is perfect for a swim, paddle or sail, away from powered watercraft. A second community dock 150 metres south of the beach provides those with powered watercraft a location to pick up friends and family for a day on the water.

TRAIL SYSTEM

A 25 km network of excellent hiking trails runs from the lake shore to Summit Park, spanning a 300-metre grade. Views from the summit are panoramic. With Duck, Wood and Kalamalka Lakes to the east, and Okanagan Lake to the north, west and south, these vistas are truly unparalleled in the Okanagan Valley.

The trail hierarchy ranges from narrow historical animal tracks to wider pathways with strategically chosen lookout points. Small parks situated throughout the trail system provide hikers with the opportunity to catch their breath while taking in the views. A series of trail head markers at specific entry points serve to orient hikers so they can navigate specific routes throughout the site.

SUMMIT PARK

Perched on the highest point of land at Lakestone, Summit Park is a peaceful space. A primary destination for hikers, the park can also act as an activity space for special events such as movie nights or small performances in a natural amphitheater setting. Minimal in its programming, Summit Park acts as a serene counterpoint to the wide variety of activities available at Lakestone.

[REGISTER NOW](#)

LAKESTONE
COME HOME TO THE LAKE

Lakestone is located in prime Lake Country, an extraordinary natural environment.



Latest News

- Lake Club Opens!
May 18, 2016
- Surf's up!
May 10, 2016
- Best construction year ever
January 12, 2016

MACDONALD
DEVELOPMENT CORPORATION

Vancouver Office
11th floor - 938 Howe Street
Vancouver, B.C. V6Z 1N9
Phone: 604.331.6018
Fax: 604.331.6048