

## THE VILLAGE

The Pacific Landing village is located at Havenwood, a gently sloping 12-acre estate on Victoria's West Shore. The property fronts Esquimalt Lagoon, a protected bird sanctuary adjacent to the Strait of Juan de Fuca with the Olympic Mountains in the background.

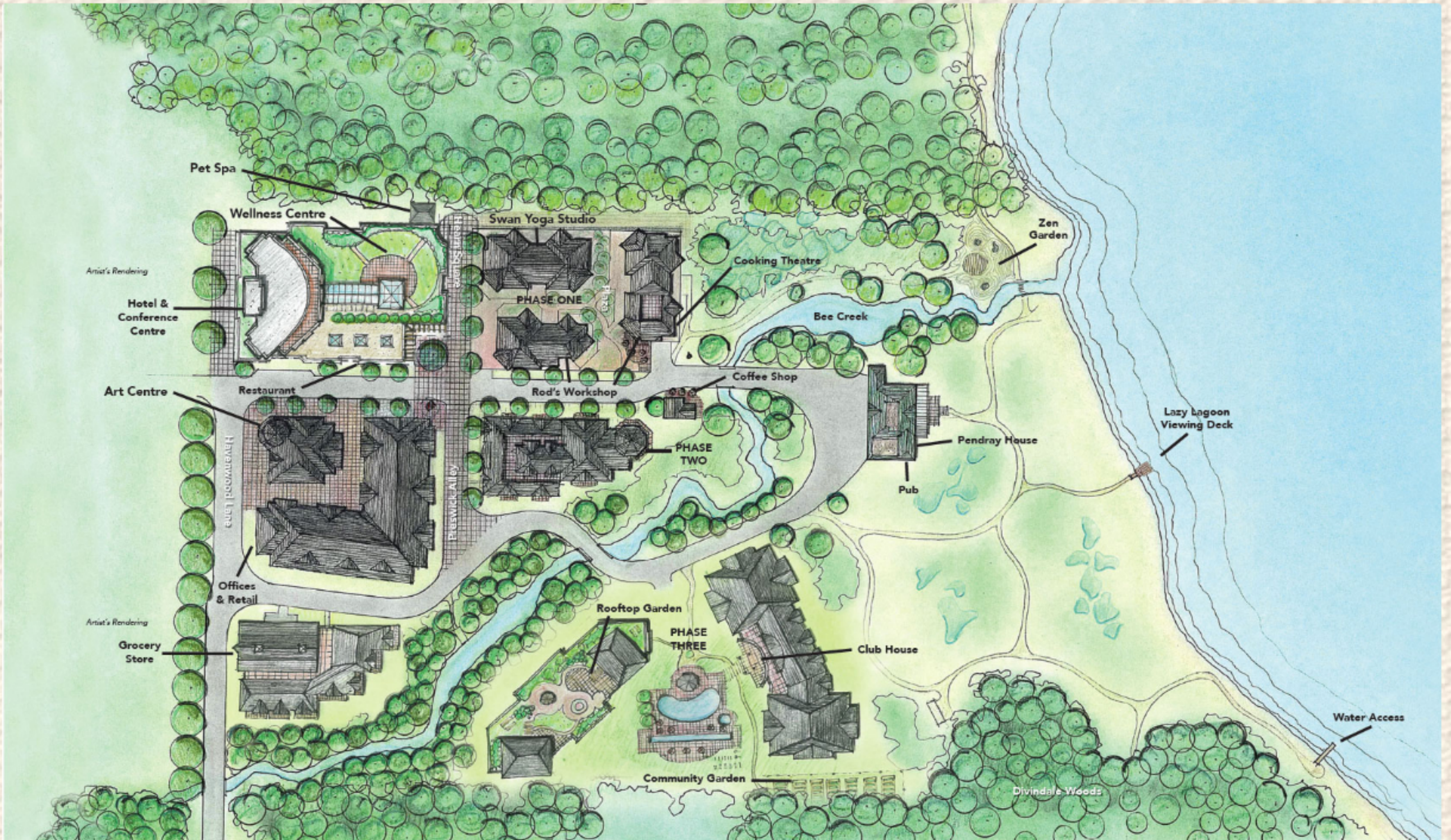

### Havenwood features:

- 650-feet of shoreline
- Old growth forest next door with some of BC's largest fir trees
- Direct access to over 500 acres of walking and biking trails
- Views of the Pacific Ocean, downtown Victoria and the Olympic Mountains
- The lower span of Bee Creek, which bubbles under stone bridges on the property

### Planned Amenities To Include:

- Clubhouse
- Cooking Theatre and BBQ pavilion
- Arts Centre and Gallery
- Workshop
- Swan Yoga Studio and fitness room
- Lap and Swimming pools
- Kayaking on Esquimalt Lagoon
- Coffee shop, Restaurant, Pub
- Hotel with business services and Conference Spaces
- Eastern and Western Medical centres, Wellness Space
- Destination Grocery Store
- Pet Facility
- Zen Garden with Oceanfront Views

## FEATURES AND FINISHES

### EXTERIOR

- historic subculture
- durable hardie-board with cultured stone accents
- spacious balconies
- 30 year asphalt shingle roof

### AMENITIES FOR PHASE 1

Yoga & exercise room, cooking theatre, community garden & workshop

See Them

### INTERIOR

- choice of three color schemes: Beach, Forest & Village Walk
- solid core fir front doors with keyless entries
- modern "square line" cabinets with soft closing hinge
- solid quartz counter tops in kitchens and baths
- porcelain tile in bathrooms and entrances
- Nu-heat tile floors in bathroom
- hardwood floors
- 100% wool berber carpets

- 9 and 10 foot coffered ceilings with recessed lighting
- custom 2" faux wood blinds
- gas fireplaces
- french style patio doors
- BBQ gas outlets on spacious patios
- designer series plumbing fixtures through out
- three choices of Premium appliances
- high efficiency front load washer and dryer
- secured heated parking and storage

### SPECIAL FEATURES

- high efficiency gas hot water on demand system for each residence
- solar panels to service common area energy needs
- variety of upgrades available

The developer reserves the right to make minor modifications to building design, specifications, features and finishes. This is not an offering for sale.

## DUNSMUIR HOUSE

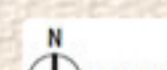

Dunsmuir House features a private yoga studio on the top floor, overlooking the tree tops. Take a yoga class, tae kwon do or simply use the universal exercise equipment at your leisure.

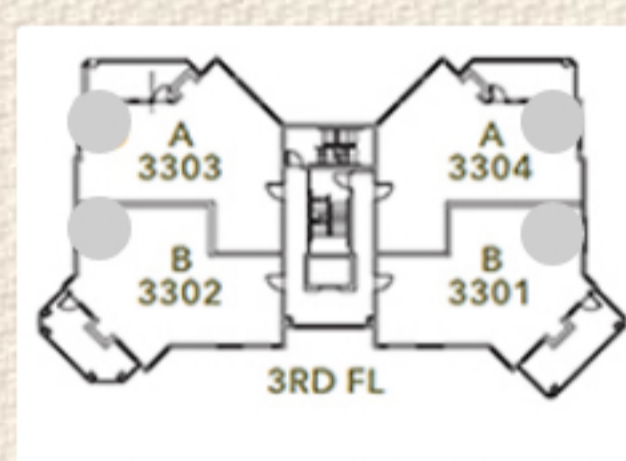
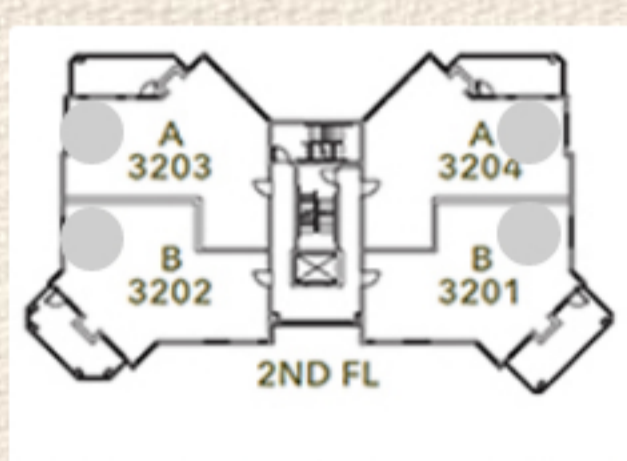
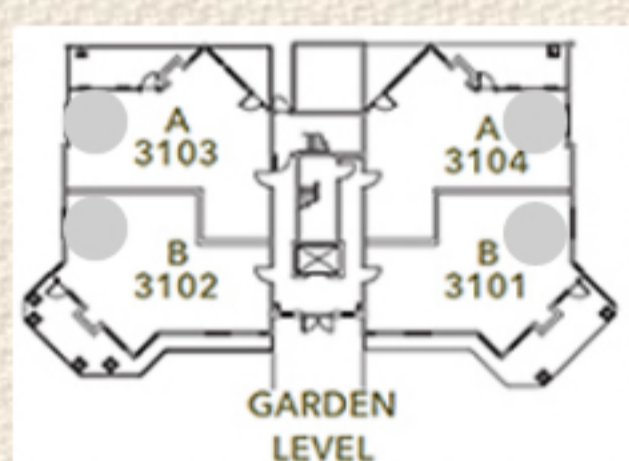

## BRETON PLACE

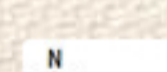

Breton Place features nine luxury homes over three stories

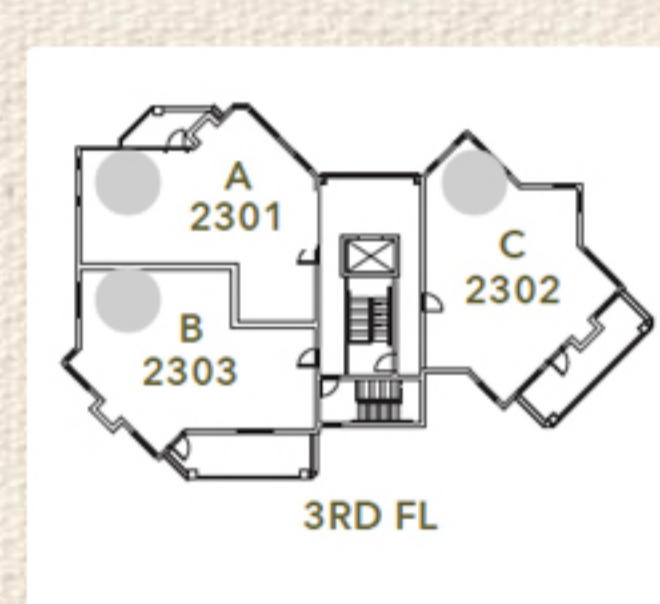
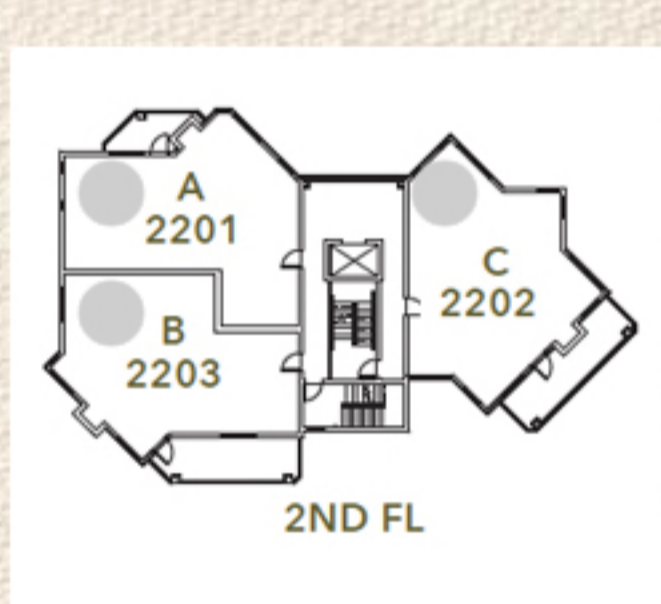
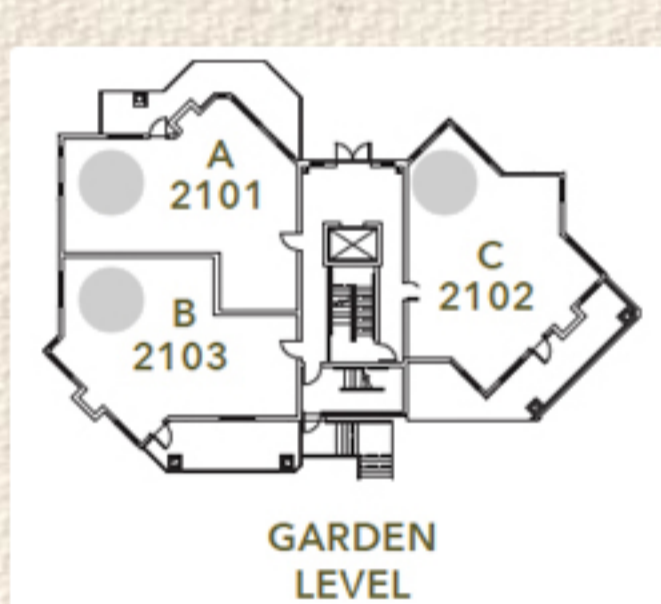

## HATLEY MANOR

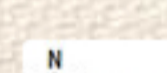

HATLEY MANOR houses a state of the art Cooking Theatre with outdoor lounge and BBQ area plus a workshop space for those creatively inclined.

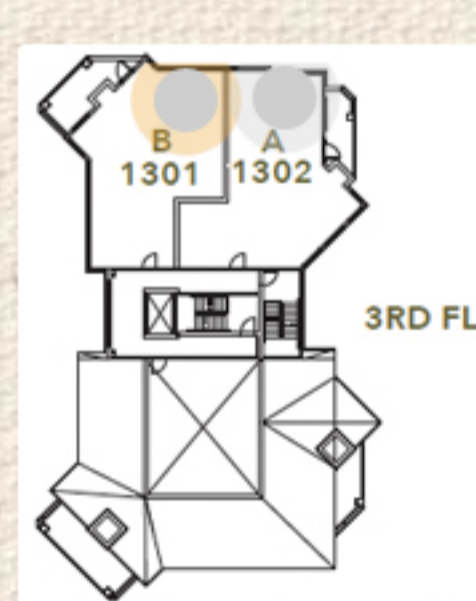
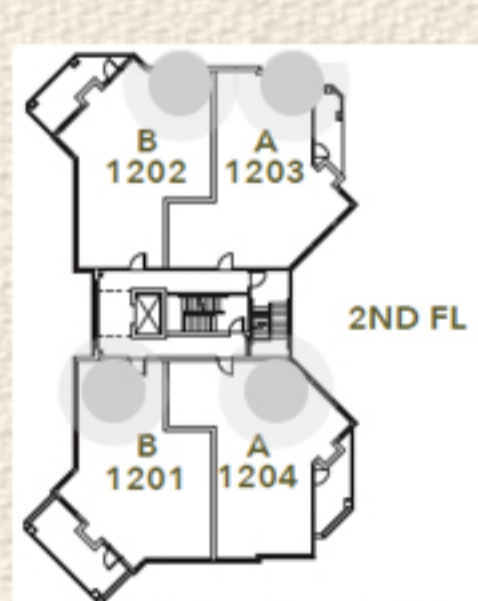
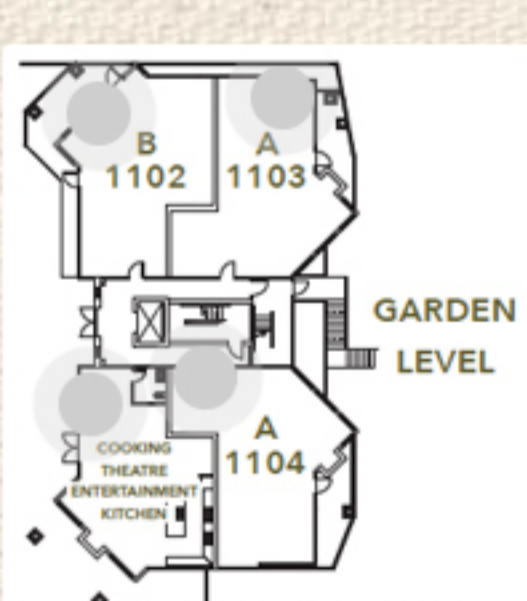

## AMENITIES FOR PHASE 1

### COOKING THEATRE

The cooking theatre is a fully commercially equipped dream kitchen that will allow you to feed your creativity.



### THE SWAN YOGA STUDIO

For centuries people have engaged in the art of yoga to find inner peace. The yoga studio is perched on the top floor of Dunsmuir House overlooking the Divindale woods enhancing the experience of finding serenity.



### ROD'S WOOD WORKSHOP

Bring out your inner woodworker at the, fully equipped, Rod's workshop.

