

# ICONIC HOMES



FIVE EXQUISITE CRAFTSMAN-INSPIRED ROWHOMES AND ONE UNPARALLELED UPPER FLAT DESIGNED AND BUILT BY THE AIREY GROUP FOR DISTINGUISHED URBAN LIVING

Nestled into a quiet corner of Kerrisdale, Bishop is defined by elegant design. Timeless craftsman inspired architecture is complemented by contemporary details, creating a classic expression that perfectly suits the heritage of the community. The residences are surrounded by mature greenery, providing a park-like setting that evokes the serenity of the parisian countryside. The result is an enclave with unparalleled privacy, while being closely connected to all the conveniences of Vancouver's vibrant city life.

The homes are oriented to emphasize natural light. From morning until dusk they are bathed in a warm glow that is enhanced by expansive layouts. Bishop homes offer a unique sense of space and flow, with intuitive plans that make hosting and entertaining easy, and family relaxation time special. The interiors evoke the character of dignified old world estates, anchored by rich hardwood flooring and accented with thoughtful elements such as a gas fireplace, soft carpeting, and expansive windows offering lush garden views. For a breath of fresh air step out on your private balcony or patio, which features a gas barbeque connection, and take in the warmth of the late afternoon.



EXTERIORS DESIGNED WITH WARMTH AND EXCEPTIONAL DETAIL.



KITCHEN

LIVING

ENSUITE

MASTER BEDROOM

KITCHENS ENGINEERED TO ENTERTAIN



SITE PLAN

PLAN A

PLAN B

PLAN C

PLAN D

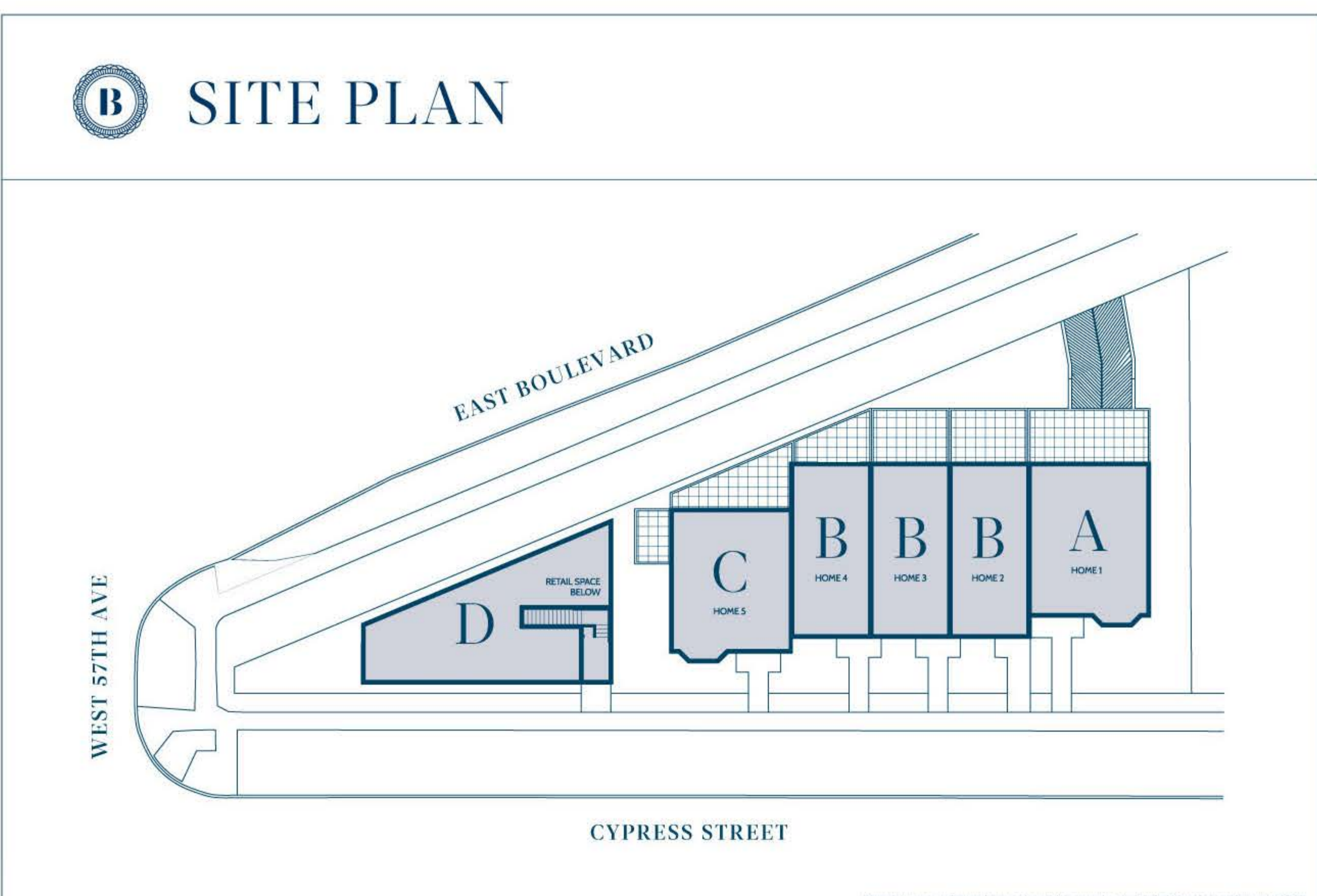

DOWNLOAD PDF



Register your interest in this landmark opportunity

REGISTER

# PARADISE FOUND



## PARISIAN COUNTRYSIDE LIVING IN THE MIDDLE OF THE CITY

Life is all about relationships with your family and friends, your neighbours, your community. Uniquely situated in the very heart of Vancouver, Bishop offers the opportunity to create close connections with the people and places you care most about, with a central location surrounded by simple daily luxuries and the exciting cultural mosaic of city life.

Just across the street is a fresh food grocer, restaurants and cafés. The tea shops and boutiques of Kerrisdale are a short stroll away. You are minutes from Southlands, with exceptional golf clubs and equestrian facilities, plus countless public parks, green spaces and community centres. And if you need to go further afield, you are just a short ride from Granville Street, a key north-south conduit that will take you to the airport, premium shopping along South Granville, UBC, downtown Vancouver and more.

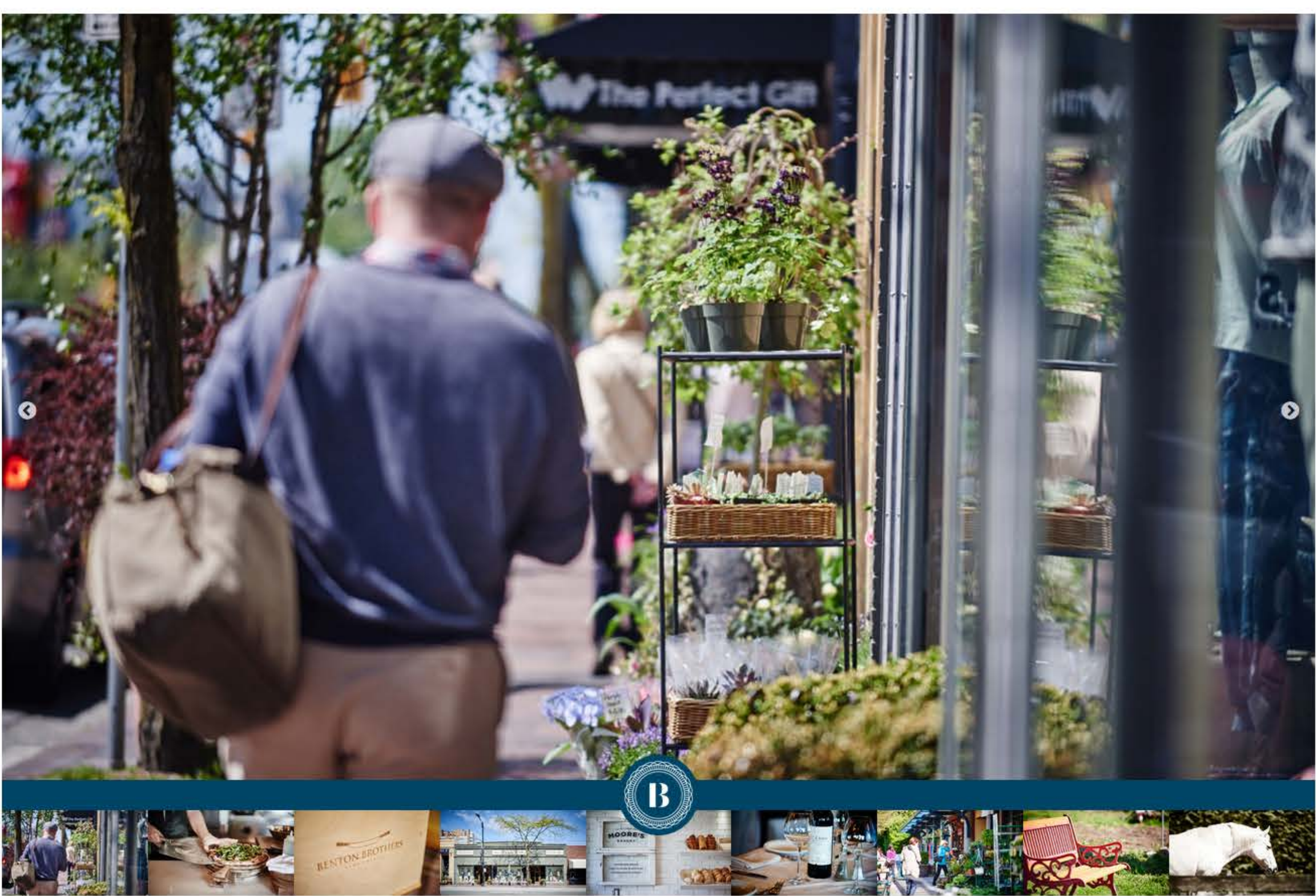

**SHOPPING**

1. Choices Market
2. Westwood Organic Produce
3. Kerrisdale Pharmacy
4. BC Liquor Store
5. Remton Brothers Fine Cheese
6. Issa Bella Boutique
7. Hills Of Kerrisdale

8. Shoppers Drug Mart
9. Marketplace TGA
10. Village VJA Wines Dunbar
11. London Drugs
12. Oakridge Center
13. Thomas Hobbs Florist

**RECREATION**

1. Southlands Riding Club
2. McCaery Golf Course
3. Point Grey Golf & Country Club
4. Kerrisdale Community Centre
5. Devine Fitness & Pilates
6. Kerrisdale Cyclone Taylor arena
7. YMCA of Greater Vancouver
8. The Daily Method
9. Pacific Spirit Regional Park
10. The Arbutus Club

**SCHOOLS**

1. DR & E McKechnie Elementary
2. Maple Secondary
3. Maple Grove Elementary
4. Crofton House School
5. Kerrisdale Elementary School
6. Little Flower Academy
7. St Cecelia's School
8. UBC

**RESTAURANTS & CAFES**

1. Senoua
2. Bubbis
3. Sofia Mediterranean Kitchen
4. Minceva's
5. Ajlaji Suedi Bar
6. Bean Around the World Cafes
7. Michele Cake Shop
8. Caffè Arrighino
8. Ensboung

**BANKS**

1. TD Canada Trust
2. BMO Bank of Montreal
3. HSBC Bank Canada
4. BDC Royal Bank



Register your interest in this landmark opportunity

REGISTER



# ENHANCING COMMUNITIES

MANY HANDS MAKE A BEAUTIFUL HOME

DEVELOPER

## THE AIREY GROUP

Howard Airey founded a modest architectural practice in 1987 that rapidly grew into one of the most respected names in West Coast residential design. Today, The Airey Group is a leading design and property development company with a legacy of excellence and many notable multi-family and residential projects in its portfolio. Airey homes are recognized for their intelligent design and architectural excellence, and for their ability to enhance the neighbourhoods they inhabit. Drawing on a 25-year background in custom residential architecture, Airey continues to set new standards for the industry on each new project. Bishop is no exception, with exquisite craftsman-inspired homes featuring refined, contemporary interiors that are both intuitive and inviting.

CONSTRUCTION

### TRILLIUM PROJECTS

Founded by a small team of real estate professionals, Trillium Project Management has been engaged in residential construction throughout British Columbia since 2005. With initial expertise in high-end single-family homes, the award-winning firm soon expanded to multi-family projects. Trillium's passion for residential development and construction translates into a commitment to providing the highest quality homes. With a foundation built on expertise, integrity, and results, Trillium prides itself on continually surpassing client expectations. This dedication to building thoughtful and unique residences is evident in Bishop, a Trillium constructed property.

INTERIOR DESIGN

### OCCUPY DESIGN

Jen Eden has been a leading member of the Vancouver design community for the better part of a decade. Today, Jen is the owner and principal of Occupy Design, a boutique Gastown-based interiors firm that specializes in multi-family developments. On every project, the team at Occupy works to enhance the symbiotic relationship between happy people and beautiful spaces. Occupy strives to find the perfect balance between form and function, and to create new experiences of living well. With Bishop, Jen and the Occupy team have created elegant and sophisticated interiors with a fresh palette and warm details, offering a peaceful living experience amid the conveniences of an urban Vancouver setting.

**BISHOP**  
KERRISDALE



LOCATION  
HOMES  
TEAM  
CONTACT  
REGISTER

**EXCLUSIVE  
ACCESS**

BOOK YOUR PRIVATE APPOINTMENT NOW  
TO DISCOVER MORE ABOUT THIS VERY  
RARE KERRISDALE OFFERING

**604.537.1985**  
info@bishopkerrisdale.com

info@bishopkerrisdale.com

**604.537.1985**  
57TH & CYPRESS - KERRISDALE

This is not an offering for sale. Any such offerings may only be made with a Disclosure Statement. E.&O.



**B C C O N D O S . N E T**



DEVELOPED BY



AIREY

MARKETING  
AND SALES BY

**BLVD**

Bishop  
West 57th Avenue & Cypress Street, [Vancouver](#)  
By [The Airey Group](#)



Bishop  
Last Updated: Jul 13, 2015  
SUMMARY  
6 Units

-

#### AVAILABLE SIZES

From 1345 SqFt

Up to 1894 SqFt

#### FOR SALE

[3 Plans](#)

\$/SqFt avg.

#### Description

Bishop is a new condo and townhouse development

By [The Airey Group](#)

currently under construction at West 57th Avenue & Cypress Street, [Vancouver](#). The development is scheduled for completion in 2016. Sales for available units start from \$1,269,800. The development has a total of 6 units.

#### Development Details

Building Type:

Condominium

Townhouse

Ownership:

Condominium

Status:

Selling

Sales/Rentals Started:

-

Construction Status:

Construction

Estimated Completion:

2016

Ceilings:

-

Website:

[bishopkerrisdale.com](http://bishopkerrisdale.com)

Builder(s):

[The Airey Group](#)



Architect(s):

-

Interior Designer(s):

[Occupy Design](#)

Marketing Company:

[BLVD Marketing Group](#)

Sales Company:

[BLVD Marketing Group](#)

Sale Prices

Sale Prices - Available Units:

from \$1,269,800

Cost to Purchase Parking:

-

Cost to Purchase Storage:

-

C.C / Maint:

-

Deposit Structure:

-

Co-op Fee Realtors:

-

% Sold:

-

West 57th Avenue & Cypress Street, Vancouver, British Columbia, Canada



### Development Summary

Bishop is a limited collection of stately European-inspired homes located in the heart of the West Side's established Kerrisdale neighbourhood. Five exquisite three-bedroom rowhomes from 1,556 - 2,002 sq.ft. are complemented by one unparalleled 1,345 sq.ft. two-bedroom upper flat. Designed and developed by The Airey Group, these distinguished residences redefine contemporary urban living.

### Features & Finishes

Bishop features beautiful craftsman-inspired elements with contemporary details for a pristine, timeless exterior aesthetic. Each unique residence features grand interiors with abundant windows that take advantage of Bishop's spectacular natural light and lush garden views. Designed with elegant entertaining and relaxation in mind, each layout features premium finishes, including beautiful engineered hardwood floors, elegant bay windows and luxurious gas fireplaces. Sophisticated chef's kitchens feature polished quartz countertops, sleek shaker-style cabinetry and top-of-the-line appliances, including an integrated stainless steel fridge, gas range, hood fan and built-in dishwasher.

