



HAMILTON STATION

Pre-register NOW!

Affordability that doesn't compromise style and quality;
location that affords the lifestyle you want.

You've found it at Hamilton Station.

[Read more](#)

welcome to
Hamilton Station



© Copyright 2008 Hamilton Projects Ltd. All rights reserved.



© Copyright 2008 Hamilton Projects Ltd. All rights reserved.

* The developer reserves the right to make modifications to floor plans, dimensions, materials, and specifications to maintain the high standard of this development. All finishes and dimensions are subject to change. E. & O.E



features

FIRST IMPRESSIONS

- Durable and fire-resistant fibre-cement HardiPanel trim
- Exterior 12x12 columns
- Wood-shingled gables
- Vinyl siding
- Professionally designed and richly landscaped grounds
- Quiet tree-lined boulevards and slate patterned walkways
- Community courtyard
- 30-year warranty on fiberglass membrane asphalt shingled roofs
- Spacious decks and patios
- Two-car garages

SENSE & SECURITY

- Pre-wired for in-home security system
- Roughed in central vacuum system
- Telephone, cable and high speed internet access in all rooms
- Third party insurance from National Home Warranty provides:
 - ▶ 2-Year warranty for parts and labour
 - ▶ 5-year warranty for building envelope
 - ▶ 10-year warranty for structural defects
- Supplementary Maintenance Operations Program provides:
 - ▶ Documented independent review of maintenance history
 - ▶ Quality assurance reviews of building envelope
 - ▶ Continual construction/maintenance deficiencies reviews
 - ▶ Follow-up to ensure any maintenance issues are addressed
 - ▶ Enhanced property value, comfort and security
- Warranty Resource Program

ADDED CONVENIENCE

- Nearby shops, outlet stores, and services at the newly-developing Queensborough Landing
- Walking distance to Alexander Hamilton Elementary School, Hamilton Community Centre and the neighbourhood playground and sports field, McLean Park
- Access to Vancouver's efficient system of bus and skytrain links

THE INSIDE STORY

- Two designer colour palettes to choose from
 - ▶ Berry Lane
 - ▶ River's Edge
- Electric heating on all floors
- Oversized windows
- Open plans on main level with 9ft ceilings
- Granite countertops
- Hardwood laminate and large hand-set tile flooring
- Electric fireplaces with sculpted mantle
- Robust baseboards and door casings
- Crown mouldings in all formal areas
- Double-glazed vinyl windows and sliding glass doors
- Stylish paneled interior doors
- Durable and stain resistant carpeting
- 50 gallon (US) electric hot water tank

Gourmet Kitchens

- Black and stainless steel, 21 or 23-cubic foot, frost-free refrigerator
- Black and stainless steel, self cleaning electric range
- Quiet, energy efficient stainless steel dishwasher
- Over the range stainless steel microwave / hood fan
- Energy efficient washer and dryer
- Double stainless steel sink
- Polished chrome faucet with pull-out vegetable sprayer
- Full height ceramic tile backsplash
- In-sink waste disposal

Indulgent Bathrooms

- Polished chrome or satin nickel bath fixtures and hardware
- Ceramic tile surround accents in bath and shower
- Vanity mirror with cosmetic sconce lighting
- Designer-selected, easy care tiles



HAMILTON STATION

604.274.7326 | www.HamiltonStation.ca



B C C O N D O S . N E T



Pre-register NOW!

[Read More](#)

Floor Plans

- [Site Plan](#)
- [Plan A](#)
- [Plan A1](#)
- [Plan A2](#)
- [Plan A4](#)
- [Plan B](#)
- [Plan C](#)
- [Plan D](#)
- [Plan E](#)
- [Plan G](#)

Hamilton Homes

BRAGGING RIGHTS. It's about feeling proud about where and how you've chosen to live. It's having your own, new, contemporary home set amidst landscaped courtyards and gardens and so stylishly appointed with stately columns and imposing wood accents.

THE INSIDE STORY

It's about living in a home filled with touches that inspire and delight. Your bath beckons and pampers with luxurious appointments, designer tile accents and chic sconce lighting. Your kitchen is state-of-the-art with its gleaming black and stainless-steel Energy Star appliances that are as practical and durable as they are beautiful. You have a cozy fireplace to curl up to, and many other energy efficient features, including double-glazed windows that will keep you comfortable year round.

PEACE OF MIND

All Hamilton Station homes are pre-wired for in-home security systems and covered by third party insurance from National Home Warranty.

A supplementary maintenance program is in place which provides quality assurance reviews of the building envelope, ongoing maintenance reviews with follow up to ensure deficiencies are addressed. That will ensure your property value, and your investment, is well-protected.

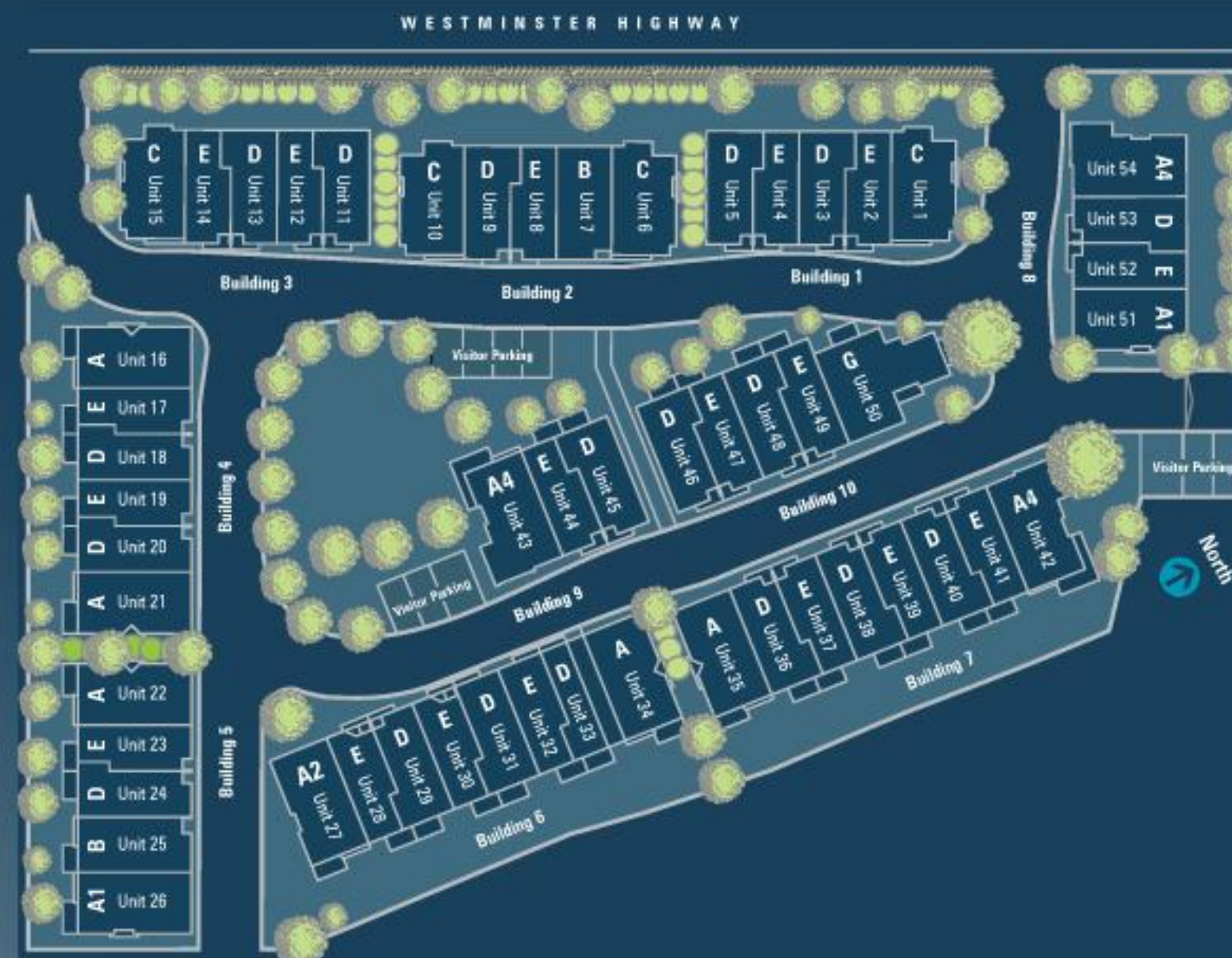

[Download PDF](#)



HAMILTON STATION

© Copyright 2008 Hamilton Projects Ltd. All rights reserved.

604.274.7326 | info@HamiltonStation.ca

*The developer reserves the right to make modifications to floor plans, dimensions, materials, and specifications to maintain the high standard of this development. All finishes and dimensions are subject to change. E. & O.E

BCCONDOS.NET

Pre-register NOW!

[Read More](#)

Features

FIRST IMPRESSIONS

- Durable and fire-resistant fibre-cement HardiPanel trims
- Exterior 12x12 columns
- Wood-shingled gables
- Vinyl siding
- Professionally designed and richly landscaped grounds
- Quiet treed boulevards and slate patterned walkways
- Community courtyard
- 30-year warranty on fiberglass membrane asphalt shingled roofs
- Spacious decks and patios
- Two-car garages

SENSE & SECURITY

- Pre-wired for in-home security system
- Roughed in central vacuum system
- Telephone, cable and high speed internet access in all rooms
- Third party insurance from National Home Warranty provides:
 - 2-Year warranty for parts and labour
 - 5-year warranty for building envelope
 - 10-year warranty for structural defects
- Supplementary Maintenance Operations Program provides:
 - Documented independent review of maintenance history
 - Quality assurance reviews of building envelope
 - Continual construction/maintenance deficiencies reviews
 - Follow-up to ensure any maintenance issues are addressed
 - Enhanced property value, comfort and security
- Warranty Resource Program

ADDED CONVENIENCE

- Nearby shops, outlet stores, and services at the newly-developing Queensborough Landing
- Walking distance to Alexander Hamilton Elementary School, Hamilton Community Centre and the neighbourhood playground and sports field, McLean Park
- Access to Vancouver's efficient system of bus and skytrain links

THE INSIDE STORY

- Two designer colour palettes to choose from
 - Berry Lane
 - River's Edge
- Electric heating on all floors
- Oversized windows
- Open plans on main level with 9ft ceilings
- Granite countertops
- Hardwood laminate and large hand-set tile flooring
- Electric fireplaces with sculpted mantle
- Robust baseboards and door casings
- Crown mouldings in all formal areas
- Double-glazed vinyl windows and sliding glass doors
- Stylish paneled interior doors
- Durable and stain resistant carpeting
- 0 gallon (US) electric hot water tank

Gourmet Kitchens

- Black and stainless steel, 21 or 23-cubic foot, frost-free refrigerator
- Black and stainless steel, self cleaning electric range
- Quiet, energy efficient stainless steel dishwasher
- Over the range stainless steel microwave / hood fan
- Energy efficient washer and dryer
- Double stainless steel sink
- Polished chrome faucet with pull-out vegetable sprayer
- Full height ceramic tile backsplash
- In-sink waste disposal

Indulgent Bathrooms

- Polished chrome or satin nickel bath fixtures and hardware
- Ceramic tile surround accents in bath and shower
- Vanity mirror with cosmetic sconce lighting
- Designer-selected, easy care tiles

[Download Features PDF](#)



© Copyright 2008 Hamilton Projects Ltd. All rights reserved.



HAMILTON STATION

604.274.7326 | info@HamiltonStation.ca

* The developer reserves the right to make modifications to floor plans, dimensions, materials, and specifications to maintain the high standard of this development. All finishes and dimensions are subject to change. E. & O.E.

BCCONDOS.NET

Pre-register NOW!

[Read More](#)



Community

LIFE STYLE

Hamilton Station is at the forefront of new residential development for Richmond that embraces both urban and rural lifestyles. The unmistakable look of quality-construction complimented by professionally landscaped yards, grounds attractively delineated by slate-patterned walkways along with a community courtyard gives these homes maximum street appeal that belies their affordability. The fifty-four townhomes of Hamilton Station make a grand entrance into the trendy but affordable residential area that borders Richmond and New Westminster.

FAMILY

The daily commute to school is just a five-minute walk to Alexander Hamilton Elementary, and with the adjacent family-friendly community center and playing field at McLean Park, you'll never hear, "there's nothing to do". Weekend outings to the Fraser River Discovery Center or a hike through Iona Regional Park are not just fun, but also educational. EXPLORE, PLAY AND RESTORE. When it's 'time for me', what revitalizes you? A luxurious day at the Spa? Swinging a club on one of the many local scenic golf courses? Dropping your line without caring if you catch anything? The crunch of snow as you cross-country ski through a mountain pass? Or will you be found strolling the banks of the Fraser River in quiet contemplation? By car, or a few steps to public transit, wherever you yearn to go... you can get there from Hamilton Station.

DEVELOPMENT LOCATION

22788 Westminster Highway
Richmond, British Columbia

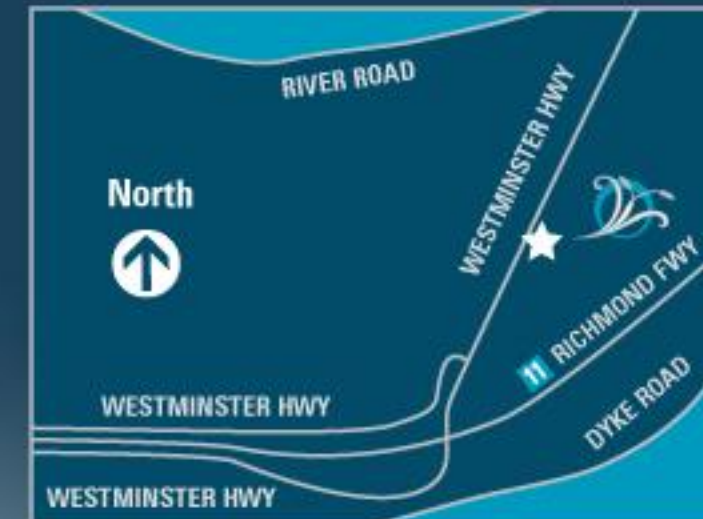

elegant
DEVELOPMENT INC.

MINHAS
GROUP

National
Home Warranty
BUILT ON INTEGRITY

© Copyright 2008 Hamilton Projects Ltd. All rights reserved.



HAMILTON STATION

604.274.7326 | info@HamiltonStation.ca

* The developer reserves the right to make modifications to floor plans, dimensions, materials, and specifications to maintain the high standard of this development. All finishes and dimensions are subject to change. E. & O.E

BCCONDOS.NET

Pre-register NOW!

[Read More](#)



About Elegant

OUR PROMISE TO CREATE EXCELLENCE IS IN OUR NAME. That promise is fulfilled by our team... experienced and dedicated professionals whose ten years of innovative design and construction have created some of the Lower Mainland's most innovative and talked-about single-family and townhome residential developments.

And, that promise is backed with the assurance of a five-year building envelope and ten-year structural warranty... and our compliance with the National Home Warranty and Warranty Resource Programs.

OTHER DEVELOPMENTS

Chelsea Estates



Located in central Richmond, BC Chelsea Estates' beautiful architecture and highly desirable location has made it one of our most successful projects to date. Having an outstanding sales start, Chelsea Estates sold more than 70% of the units within one month of the official launch. Marketing Chelsea Estates we used state of the art 3D renderings, as well as an interactive touch-screen website. Chelsea Estates is a remarkable new collection of 32 English-Tudor-style homes, gracefully designed to compliment its natural setting, Chelsea Estates will offer a modern lifestyle with classic old world flair. Home owners will enjoy a quiet surrounding along with refined manicured lawns, and a tranquil English inspired courtyard. Construction is set to begin early spring 2008, and so far things are coming along smoothly in all aspects. Projected Completion December 2008.

[View Website](#)

Meritage Lofts



Located in central BC, in the town of Penticton, Meritage Lofts has an original design, a very appealing location and is 80% sold. The Okanagan has much to offer including beautiful lake beaches, fine wineries, world class golf courses, and gorgeous summertime weather. Meritage Lofts, is nine suites of unique living space. Creative, well built, and practical, this metropolitan influenced brick design is complimented with stylish and contemporary finishes, familiar to Vancouver's Yaletown district. Meritage Lofts boasts 18' lofts with Mezzanines, vaulted open spaces, floor to ceiling windows, spacious decks, gorgeous view, expansive kitchens, wide plank hardwood floors, lots of natural light and free flowing spaces full of exciting possibilities. Meritage Lofts completed in September 2008.

Navigator's Cove



Located close to the water, Navigator's Cove was inspired by the Fraser River and its rich Maritime history. That inspiration weaves its way through the design and architectural details of these two-and three-level townhomes. With an emphasis on quality and durability, the townhomes feature superior materials including corrugated steel, hand-hainted Hardi-Plank™ and cedar shake siding reminiscent of the historic fishing buildings. A lighthouse-inspired tower adds character and warmth to the homes.

Navigator's Cove was designed to withstand the elements and resist water penetration, maintaining its appearance for years.



HAMILTON STATION

© Copyright 2008 Hamilton Projects Ltd. All rights reserved.

604.274.7326 | info@HamiltonStation.ca

* The developer reserves the right to make modifications to floor plans, dimensions, materials, and specifications to maintain the high standard of this development. All finishes and dimensions are subject to change. E & O E

BCCONDOS.NET

Pre-register NOW!

[Read More](#)



Contact

SALES & MARKETING BY:

REMAX Westcoast Steveston Real Estate
Unit 100 - 12235 No. 1 Road
Richmond, British Columbia
Canada V7E 1T6

Telephone: 604.274.7326
Fax: 604.274.7320

email: info@HamiltonStation.ca

DEVELOPMENT LOCATION

22788 Westminster Highway
Richmond, British Columbia

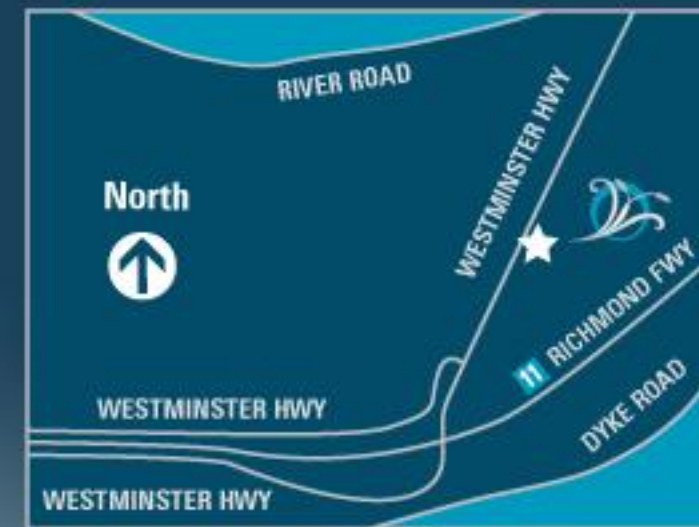

elegant
DEVELOPMENT INC.

MINHAS
GROUP

National
Home Warranty
BUILT ON INTEGRITY

© Copyright 2008 Hamilton Projects Ltd. All rights reserved.



HAMILTON STATION

604.274.7326 | info@HamiltonStation.ca

* The developer reserves the right to make modifications to floor plans, dimensions, materials, and specifications to maintain the high standard of this development. All finishes and dimensions are subject to change. E. & O.E

BCCONDOS.NET