

REGISTER NOW



BINNING TOWER  
ON THE PARK · POINT GREY

BINNING TOWER · LOCATION · FLOORPLANS · FEATURES · VIEWS · DEVELOPER · CONTACT

# LOCATION

INSPIRED BY NATURE, REFINED BY CULTURE.

The Binning Tower residences offer a rare combination of nature and culture, in an unrivalled Vancouver location.

[LEARN MORE](#) ▶



LOCATION

The Binning Tower residences offer a rare combination of nature and culture...



RESIDENCES

Like a beautiful wardrobe and the promise of an elegant evening...



FEATURES

A home that reflects joy and delight in the everyday. Smartly styled and...

## BINNING TOWER

Binning Tower at Wesbrook, University of British Columbia (UBC) is an unprecedented investment in the future – a lifestyle defined by education, arts, culture and recreation – from the team that also founded The Peter Wall Institute for Advanced Studies in the cultural heart of UBC. The same team was responsible for Wall Centre Downtown, Yaletown Park, Capitol Residences and Wall Centre False Creek, and is currently developing Shannon Wall Centre Kerrisdale and Wall Centre Central Park.



MANAGED BY



MARKETED BY



PRESENTATION CENTRE

5898 GRAY AVENUE,  
WESBROOK VILLAGE, UBC, VANCOUVER  
604-646-1111 [INFO@BINNINGTOWER.COM](mailto:INFO@BINNINGTOWER.COM)



REGISTER NOW

BINNING TOWER  
ON THE PARK POINT GREY

BINNING TOWER • LOCATION • FLOORPLANS • FEATURES • VIEWS • DEVELOPER • CONTACT

# WEST SIDE VANCOUVER

## FRESH AIR OPEN SPACES TRUE LUXURY AT HOME

The location is perfect. Your home at Binning Tower is both scenic and convenient with immediate access to Vancouver's most sought after places, schools, and neighbourhoods.



WEST SIDE VANCOUVER

Your home at Binning Tower is both scenic and convenient...



WESBROOK UBC

Close to Vancouver, you'll live within the vibrant master planned community of...



NATURE AND CULTURE

The Binning Tower residences offer a rare combination of nature and culture...

## LOCATION

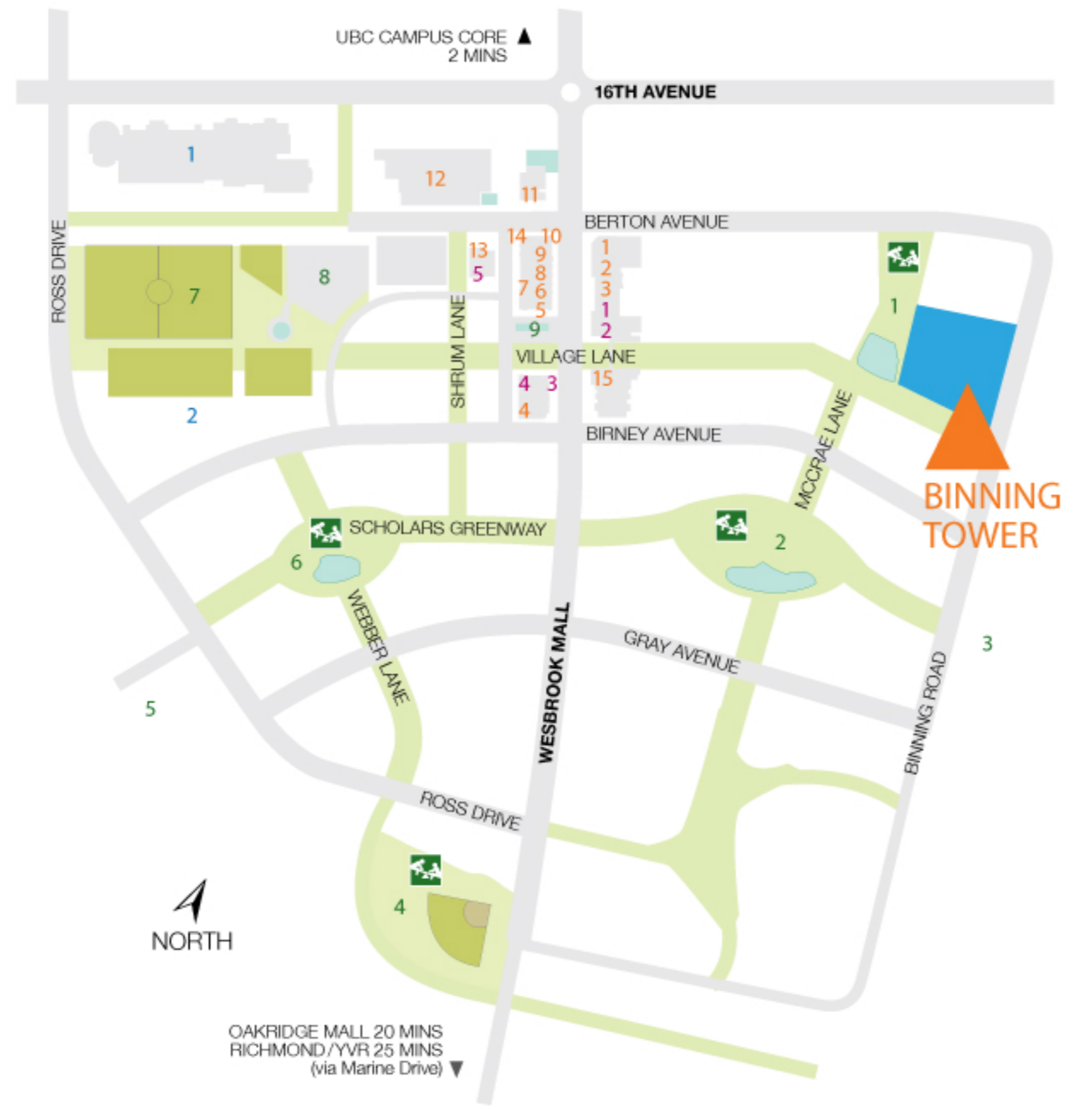

### PARKS & RECREATION

- 1. Khorana Park
- 2. Michael Smith Park
- 3. Pacific Spirit Regional Park
- 4. Nobel Park and Softball Diamond
- 5. UBC Farm Access
- 6. Mundell Park
- 7. Brockhouse Park
- 8. Community Centre
- 9. Norman Mackenzie Square

### SHOPS & SERVICES

- 1. Running Room
- 2. InsureBC
- 3. Wesbrook Village Dental Centre
- 4. Mozart School of Music
- 5. Wesbrook Eyecare
- 6. Vicki's Nail Studio
- 7. More Bikes
- 8. University Barbershop
- 9. Kabro Salon
- 10. Careville Health
- 11. Royal Bank
- 12. Save-On-Foods
- 13. BC Liquor Store
- 14. Wesbrook Seafood Market
- 15. Welcome Centre

### EAT & DRINK

- 1. Jugo Juice
- 2. Menchie's Frozen Yogurt
- 3. Blenz Coffee
- 4. Togo Sushi
- 5. Chef Hung Taiwanese Beef Noodle

### SCHOOLS

- 1. University Hill Secondary
- 2. Future Elementary School
- Playground



PRESENTATION CENTRE  
5898 GRAY AVENUE,  
WESBROOK VILLAGE, UBC, VANCOUVER  
604-646-1111 [INFO@BINNINGTOWER.COM](mailto:INFO@BINNINGTOWER.COM)

REGISTER NOW



# BINNING TOWER

ON THE PARK · POINT GREY

BINNING TOWER · LOCATION · FLOORPLANS · FEATURES · VIEWS · DEVELOPER · CONTACT

## FLOORPLANS

### PRIVACY AND EXCLUSIVITY

Privacy and exclusivity is defined at Binning Tower's collection of deluxe 2-level residences. Each townhome includes a private entry, modern garden space and terraces.

## FLOORPLANS

TYPICAL LEVEL: 2-11

TYPICAL LEVEL: 12-25

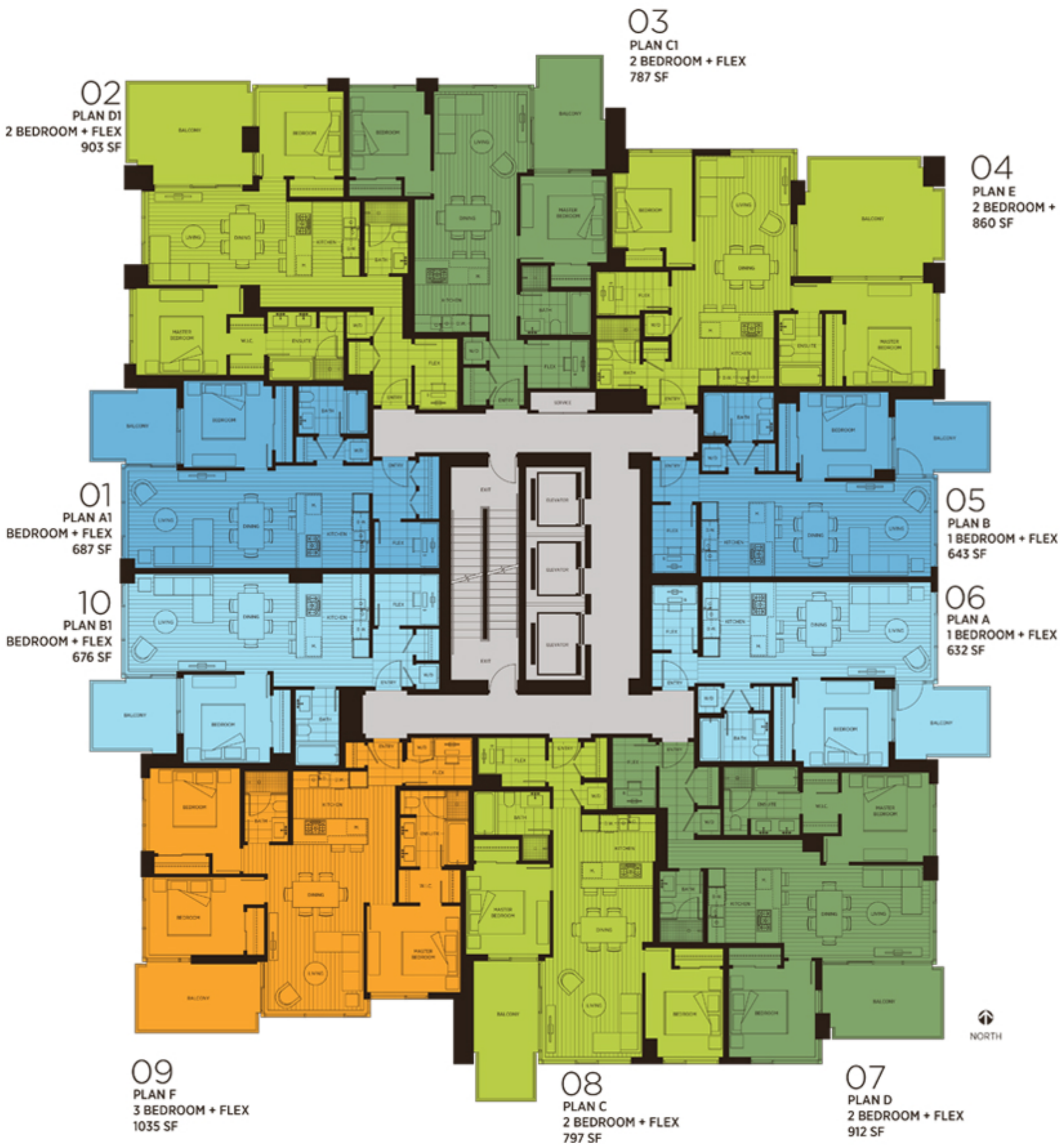

MANAGED BY



MARKETED BY



PRESENTATION CENTRE  
5898 GRAY AVENUE,  
WESBROOK VILLAGE, UBC, VANCOUVER  
604-646-1111 [INFO@BINNINGTOWER.COM](mailto:INFO@BINNINGTOWER.COM)

## FEATURES LIST

## TRUE LUXURY AT HOME

Kitchens designed for living. Well-styled and functional bath. A sense of space. A home that reflects joy and delight in the everyday.



## FEATURES LIST

Kitchens designed for living. Well-styled and functional bath...

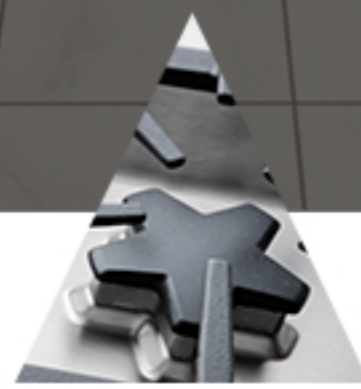

## KITCHENS

Relax and entertain in your elegant armony cucine kitchen featuring...



## A SENSE OF SPACE

Your beautiful new home is designed to be elegant, restful and calm.

## FEATURES

## GOURMET KITCHENS

- ▶ European-inspired kitchens with wood shaker cabinetry and integral handles
- ▶ Durable and sleek quartz composite stone counter and island tops
- ▶ 24" Liebherr fully integrated refrigerator with bottom freezer
- ▶ 30" AEG Masterpiece 5-burner gas cooktop
- ▶ 30" AEG Masterpiece stainless steel built-in wall oven
- ▶ 24" AEG fully integrated dishwasher
- ▶ 24" GE stainless steel built-in microwave
- ▶ Falmecc stainless steel hood fan and shelf unit
- ▶ Contemporary stainless steel kitchen faucet by Grohe
- ▶ Stainless steel double-bowl kitchen sink by Julien
- ▶ Convenient LED and Xenon under-cabinet strip lighting

## INTERIORS

- ▶ Two elegant colour schemes to choose from
- ▶ Forest Stewardship Council (FSC) certified wood entry doors
- ▶ Energy Star energy efficient windows
- ▶ Energy Star water efficient appliances
- ▶ EcoLogo environmentally friendly paints and finishes
- ▶ 8' 5" ceilings in all suites
- ▶ FSC certified engineered wood flooring in wenge or silva throughout
- ▶ Wool blend broadloom EcoLogo carpeting in closets
- ▶ Contemporary roller shade window treatments
- ▶ Durable porcelain floor tile in the entry and second bath
- ▶ All homes are fully air-conditioned for maximum comfort

## UTILITY

- ▶ AEG Lavamat washer and dryer
- ▶ Built-in three-bin recycling centre

## UNIVERSITY NEIGHBOURHOODS ASSOCIATION (UNA)

Residents of Wesbrook, UBC may apply to join the UNA with a UNA Access Card, which provides free access to the UBC Library, Vancouver Public Library, UBC Botanical Garden, Nitobe Memorial Garden and Museum of Anthropology, plus preferred rates at UBC Athletic and Recreational Facilities and other venues. Learn more at [www.myuna.ca](http://www.myuna.ca)

## SPACIOUS BATHS

- ▶ European-inspired bathrooms featuring deluxe vanities with integral handles
- ▶ Polished marble or travertine vanity countertops
- ▶ Frameless glass master shower enclosure
- ▶ Deco-beveled glossy white ceramic wall tile in main bathrooms
- ▶ Polished glass tile (ensuite shower and tub surround)
- ▶ Polished marble tile (ensuite floor and baseboard)
- ▶ Mosaic tile showers in marble or travertine
- ▶ Modern Duravit undermount porcelain vanity basin
- ▶ Streamlined Duravit drop-in bathtub
- ▶ Wide-set modern stainless steel bathroom faucets and tub spouts by Grohe
- ▶ Euphoria low-flow stainless steel rain-shower heads by Grohe
- ▶ Sleek Duravit Starck 3 low-flow, dual-flush, wall-mount toilet

## RESIDENTIAL AMENITIES &amp; TECHNOLOGY

- ▶ Grand residential lobby and entry
- ▶ Private gym and yoga studio
- ▶ Residential amenity lounge with kitchen and meeting areas
- ▶ Outdoor landscaped gardens and terrace
- ▶ Secured parking and storage
- ▶ Secured bicycle storage
- ▶ Electric car charging stations

## 3 BEDROOM HOMEPLANS

- ▶ 36" Gaggenau fully integrated refrigerator with bottom freezer
- ▶ 36" AEG 5-burner gas cooktop
- ▶ 24" AEG fully integrated dishwasher
- ▶ 30" AEG stainless steel double wall oven
- ▶ 24" AEG stainless steel wine cooler with 2 climate zones

## YOUR NEIGHBOURHOOD: WESBROOK

Convenient access to all Wesbrook Village shopping, services and amenities. Learn more at [www.discoverwesbrook.com](http://www.discoverwesbrook.com)

## RESIDENTIAL WARRANTY

National Home Warranty Group Inc.

[Download a PDF of the Features List in Simplified Chinese](#)

[Download a PDF of the Features List in Traditional Chinese](#)

MANAGED BY



MARKETED BY



## PRESENTATION CENTRE

5898 GRAY AVENUE,  
WESBROOK VILLAGE, UBC, VANCOUVER  
604-646-1111 [INFO@BINNINGTOWER.COM](mailto:INFO@BINNINGTOWER.COM)



REGISTER NOW



# BINNING TOWER

ON THE PARK · POINT GREY

BINNING TOWER · LOCATION · FLOORPLANS · FEATURES · VIEWS · DEVELOPER · CONTACT

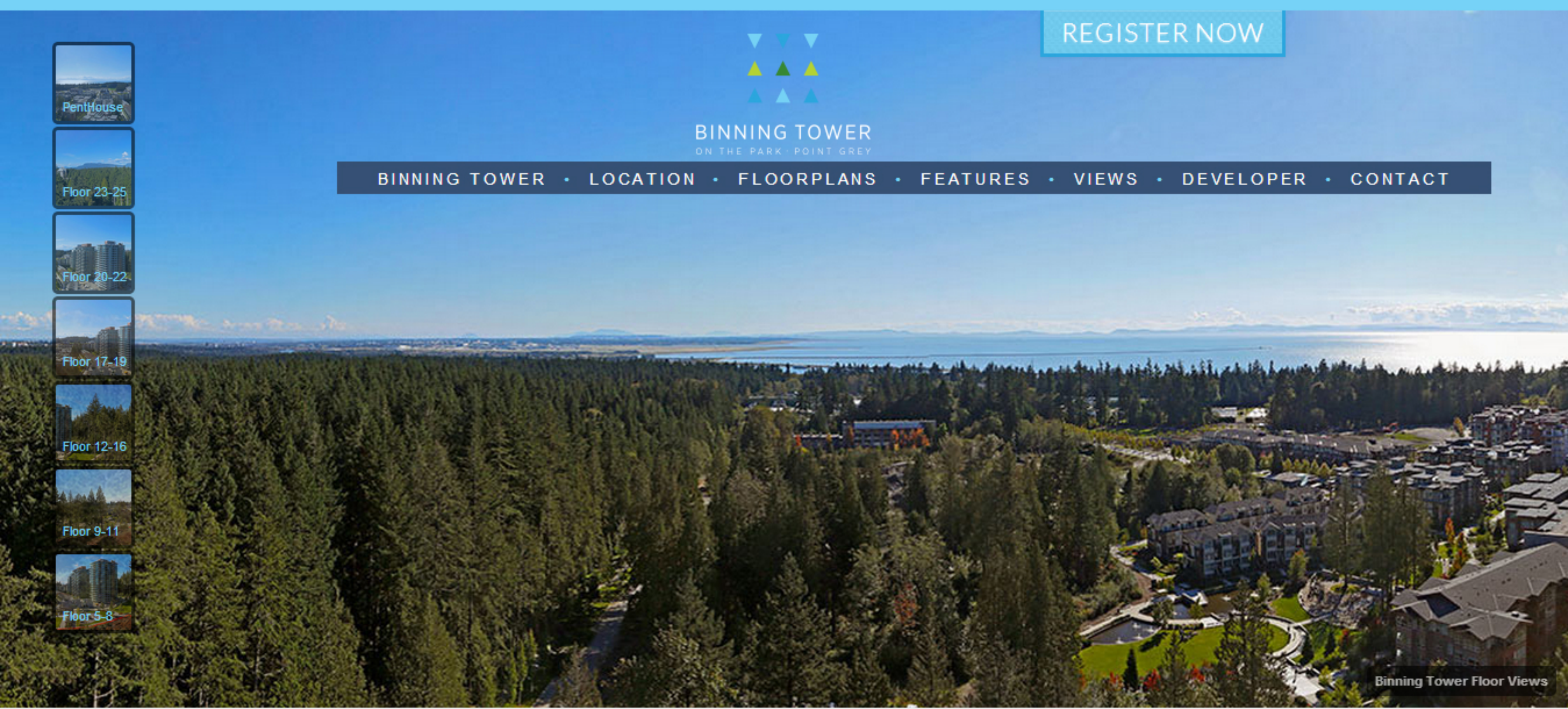

Binning Tower Floor Views

MANAGED BY



MARKETED BY



### PRESENTATION CENTRE

5898 GRAY AVENUE,  
WEBBROOK VILLAGE, UBC, VANCOUVER  
604-646-1111 [INFO@BINNINGTOWER.COM](mailto:INFO@BINNINGTOWER.COM)



REGISTER NOW



BINNING TOWER  
ON THE PARK · POINT GREY

BINNING TOWER · LOCATION · FLOORPLANS · FEATURES · VIEWS · DEVELOPER · CONTACT

# WALL GROUP OF COMPANIES

## AN UNPARALLELED REPUTATION

Built on a legacy of enduring success Wall's experience includes developing thousands of prestigious condominium residences and hotels.

## BINNING TOWER ON THE PARK

Sound investments are made with confidence. The unparalleled reputation of the Wall Group of Companies is built on a legacy of enduring success. The team's experience includes developing thousands of prestigious Vancouver condominium residences and hotels. Today, their uncompromising standards are reflected in every detail of Binning Tower on the park.



Yaletown Park



Capitol Residences



Wall Centre Richmond



2300 Kingsway



Wall Centre Downtown

MANAGED BY



MARKETED BY



PRESENTATION CENTRE

5898 GRAY AVENUE,  
WESBROOK VILLAGE, UBC, VANCOUVER  
604-646-1111 [INFO@BINNINGTOWER.COM](mailto:INFO@BINNINGTOWER.COM)



REGISTER NOW



# BINNING TOWER

ON THE PARK - POINT GREY

[BINNING TOWER](#) • [LOCATION](#) • [FLOORPLANS](#) • [FEATURES](#) • [VIEWS](#) • [DEVELOPER](#) • [CONTACT](#)

## CONTACT US

Phone: 604.646.1111  
Email: [info@binningtower.com](mailto:info@binningtower.com)  
Address: 5898 Gray Avenue, Wesbrook Village, UBC, Vancouver  
Hours: Open Daily 12-5PM, Closed Fridays or by appointment

## CONTACT



**PRESENTATION CENTRE**  
5898 GRAY AVENUE,  
WESBROOK VILLAGE, UBC, VANCOUVER  
604-646-1111 [INFO@BINNINGTOWER.COM](mailto:INFO@BINNINGTOWER.COM)