



FLAGSHIP

→ COMMUNITY

Map



Flagship redefines luxury waterfront living. An integral addition to False Creek's Coopers Quay Neighbourhood, these stunning homes offer an urban waterfront living experience beyond compare. Situated in a private residential area, with Coopers' Park and the seawalk at your door, yet connected to the vibrant bustle of the city including the trendy boutiques, fine restaurants and entertainment of Yaletown as well as the corporate headquarters of the downtown financial district. Flagship brings home the ultimate waterfront living experience in one of the world's most desirable cities.



FLAGSHIP

INTERIORS

FLOOR PLANS

ESPRIT CITY CLUB

CONTACT

CONCORD
PACIFIC





FLAGSHIP

COMMUNITY

→ FLAGSHIP

Building Rendering



Flagship heralds a new age of modern elegance. An impressive double height lobby and soothing reflective ponds greet your arrival. Expansive windows and open balconies showcase water vistas in a design that accentuates and compliments its natural surroundings. Designed by renowned architects Hotson Bakker Boniface Haden and IBI/HB, Flagship features innovative architectural details including an elevator that boasts exhilarating views of the water and city as you ascend to your home,



INTERIORS

FLOOR PLANS

ESPRIT CITY CLUB

CONTACT

CONCORD
PACIFIC





FLAGSHIP

COMMUNITY

FLAGSHIP

→ INTERIORS

Features + Finishes



Luxurious environments perfect for entertaining and private relaxation. Expansive windows, hardwood flooring and gas fireplaces create instant ambience. Imported European kitchens with stone countertops and top of the line appliances provide the perfect balance between functionality and design. The bathrooms rival a fine resort spa. The ensuite features a generous soaker tub and "floating" vanity - with integrated glass sinks - that glows when you enter the room, and a main bath that features a sleek vessel sink and stone countertop. At Flagship you will find gracious living at every turn.

ALL ILLUSTRATIONS REFLECT THE ARTIST'S INTERPRETATION OF THE PROJECT.



FLOOR PLANS

ESPRIT CITY CLUB

CONTACT

CONCORD
PACIFIC





FLAGSHIP

COMMUNITY

FLAGSHIP

INTERIORS

→ FLOOR PLANS

3 bedroom

2 bedroom

2 bedroom + workstation

2 bedroom + den

1 bedroom + guest room

SUITE 01

 [CLICK TO
DOWNLOAD
PRINTABLE PDF](#)

FLOORS 5 - 27

ENCLOSED AREA 1,315 ft²

BALCONY 60 ft²

TOTAL AREA 1,375 ft²

The areas above do not apply to Suite 01 on floors 8, 9, 18, 19 & 20.

FLOORS 8, 9, 18, 19 + 20

ENCLOSED AREA 1,309 ft²

BALCONY 60 ft²

TOTAL AREA 1,369 ft²

The double dotted line refers to the storage on floors 8, 9, 18, 19 & 20.



DIMENSIONS, SIZES AND LAYOUTS ARE APPROXIMATE AND ARE SUBJECT TO CHANGE WITHOUT NOTICE. E. & O.E.

ESPRIT CITY CLUB

CONTACT

CONCORD
PACIFIC





FLAGSHIP

COMMUNITY

FLAGSHIP

INTERIORS

FLOOR PLANS

→ ESPRIT CITY CLUB

Club Renderings



CONTACT

With more than 14,000 square feet of amenities, the Esprit City Club is your exclusive resort at home. Start your morning with a swim in the 60-foot indoor pool, or work out in the fully equipped fitness room. For quieter pleasures, the yoga/Pilates studio is a peaceful place to meditate and rejuvenate. Unwind in the whirlpool, steam room or sauna. Invite friends to a movie in the Hollywood-style screening room or challenge them to a fun game of bowling in the 10-pin bowling alley. And for outdoor leisure, a fleet of kayaks are at your disposal to explore the False Creek scenery by water.



CONCORD
PACIFIC





FLAGSHIP

COMMUNITY

FLAGSHIP

INTERIORS

FLOOR PLANS

→ ESPRIT CITY CLUB

Club Renderings

MAIN LEVEL



 [CLICK TO VIEW LARGER](#)

SECOND LEVEL



 [CLICK TO VIEW LARGER](#)

LOWER LEVEL

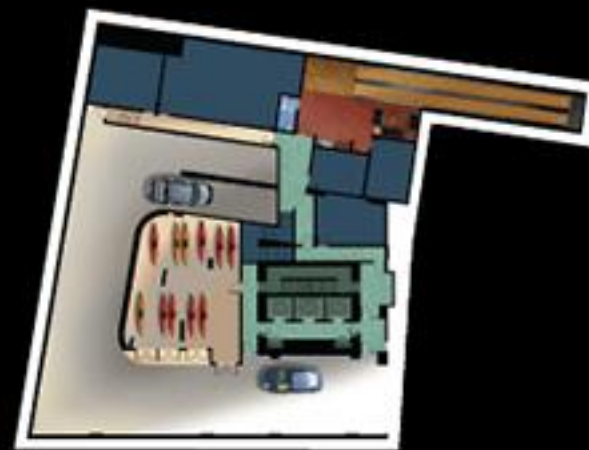

 [CLICK TO VIEW LARGER](#)

ALL ILLUSTRATIONS REFLECT THE ARTIST'S INTERPRETATION OF THE PROJECT.

CONTACT

CONCORD
PACIFIC





FLAGSHIP

COMMUNITY

FLAGSHIP

INTERIORS

FLOOR PLANS

ESPRIT CITY CLUB

→ CONTACT

Email

Presentation Centre Map



Concord Pacific Group is an award-winning developer of master-planned communities. Concord Pacific Place on downtown Vancouver's False Creek waterfront revitalized the area and is now one of the most sought-after neighbourhoods in Canada renowned for both living appeal and homes of escalating value. Concord CityPlace on downtown Toronto's lakefront parallels this success with dynamic urban lifestyles where people work, meet and play. Each is a landmark of excellence in quality construction, amenities and community development.

928 Carrall Street
Vancouver, BC
[Click Here for Map](#)

P 604.899.8800
F 604.899.8000
E marketing@concordpacific.com

For more information on Flagship, the newest development in Concord Pacific Place, [click here](#).

REGISTER

CONCORD
PACIFIC

