

1717 @ 1777

BAYSHORE DRIVE



B C C O N D O S . N E T





THERE IS

EVERY OTHER PLACE

TO LIVE IN

Vancouver.



BCCONDOS.NET





THEN THERE IS

1717 @ 1777

BAYSHORE DRIVE.



B C C O N D O S . N E T



1717 & 1777

Bayshore Drive

LIKE NO OTHER PLACE ON EARTH.

OR ON

Waterfront.



A LOCATION DEFINED BY

THE 1000 ACRES THAT IS

Stanley Park.

VANCOUVER'S FORESTED GEM.



BCCONDOS.NET





For more than 35 years, the Westin Bayshore Hotel has hosted prime ministers, princes and kings of commerce along with movie stars and reclusive millionaires. For people in the city, memories of weddings, family gatherings, romantic evenings and music drifting over the waters still hold magic.

But the past is but a prelude at the Bayshore. This treasured Vancouver landmark continues the tradition with the next phase of Bayshore.

Here, in Coal Harbour with the Coast Mountains set beautifully against the sky, one of the only true urban resort locations in North America has awaited the arrival of 1717 and 1777 Bayshore Drive.

Quintessential Vancouver



B C C O N D O S . N E T



A Resort Neighbourhood

WITH SOME RATHER REMARKABLE

LIQUID ASSETS.



Sharing the Westin Bayshore Hotel's stunning 22-acre Coal Harbour location, Bayshore is about to bring waterfront residential living to the resort level.

A special enclave that takes its character from the waters and green spaces that surround it. Inviting shoreline walkways, a new marina, two city parks and a cascade of waterscapes, all say Bayshore. Here amid the private gardens and fountains is a planned community. Further development will be designed to complement the neighbourhood surroundings.





It is a world where the automobile is superfluous. Downtown is minutes away, but somehow worlds apart. A walkway brings you right into Stanley Park. The shops on Robson are a short stroll away. Theatres. The financial district. The coffee bars of Denman are all laid out at your feet. Prefer to take the shuttle downtown? Your concierge will make all the arrangements.

On the edge of the park, at the entrance to the city, a resort neighbourhood is taking wondrous shape.



"When I was first asked to work on the Bayshore Site, I could not help thinking of it in terms of the tide ebbing and flowing, back and forth twice a day for the last 10,000 years. The buildings are intended to complement the timelessness of the mountains, water and sky in what is a very unique place in the world."

Richard Henriquez





HENRIQUEZ PARTNERS ARCHITECTS

Waterfront Residences

LIKE NO WHERE ELSE ON EARTH.



B C C O N D O S . N E T



THE TWO BUILDINGS ARE CREATED TO TAKE NATURAL ADVANTAGE

OF THE BREATHTAKING

Water, Mountain

With the generous terraces and outdoor spaces, the residences here have the feel and spaciousness of an exclusive penthouse.

Richard Henriquez has utilized the potential of the land to its fullest, personally designing homes with the views that have epitomized Vancouver to many thousands of visitors. The expansive use of light, glass and natural materials enhances rather than competes with Bayshore's unparalleled backdrop.

The stunning architecture with its stepped terraces and gentle curves will become part of a life filled with light and inspiring views. 1717 and 1777 are at a height of 16 stories and form a dramatic sweep to the waterfront. With only 99 suites they represent the ultimate realization of the Bayshore vision.

The common areas are uncommonly beautiful. Designed by Mitchell Freedland, the lobbies combine grandeur with intimacy, open to the views, parkland and surrounding waterfront.

The lobby levels feature some remarkable resort amenities. Spa, exercise facilities and whirlpool overlook the Terraced Lagoon. The sauna, steam room as well as the piano lounge distinguish the residences. A club room with fireplace, art studio, bridge room as well as the paneled billiards room are all part of the Bayshore experience.

From the lobbies, elevators take you to an elegant foyer serving only one to three residences.

Most homes are over 1,700 square feet with the largest penthouse surpassing 6,000 square feet. A long awaited return to generous, gracious living space. The expansiveness of these homes are augmented by high ceilings, sweeping terraces and large balconies.



Views and Park.



Landscaping

THAT IS A REFLECTION OF THE WATERS AND MOUNTAINS AROUND IT.



We owe our exceptional landscape design to the elements that have earned Vancouver a world renowned reputation for stunning beauty. The waters that encompass it, the mountains that give it scale, the parks and gardens that humanize it.

The pool garden brings the feeling of the waterfront right through to the base of the two buildings. Here native plants, flowers and natural vegetation around terraced pools are part of the unique Bayshore design statement.

In this rather unconventional landscape, the waters refer to historic reference points of the original shoreline. Here are echoes of the land division patterns of the past such as the wharves and piers.

This park-like setting will be complemented by two new city parks, meandering paths, inviting lawns and a series of distinctive formal and informal West Coast Gardens. The award-winning landscape architect firm of Durante Kreuk Limited, well known for their downtown Park Place achievement and private garden designs have been chosen to bring the Bayshore vision to fruition.





Water



Interiors

DESIGNED TO THE HIGHEST POSSIBLE STANDARDS.

YOURS.

This is your home as you've always wanted it.

The extent of the customization is unprecedented. You may prefer to have the sunrise glisten across your kitchen or slowly awake you through the windows of your master bedroom. The choice is yours.

Work with your designer or our interior firm McCulloch and Associates, one of Vancouver's most respected residential designers to further make your home a reflection of you and you alone. Select the finishes for your residence beginning with your elegant foyer. Choose from a very special collection of imported marbles, granites, limestones and ceramics. Texture and colour palates from an exclusive selection of carpets,



hardwood flooring and tile. From the solid core doors to finely designed gas fireplaces, Bayshore features reflect uncompromising standards.

Most suites have at least two and a half bathrooms with six fixtures in the Master Suite to envelop you in comfort and refinement. Fixtures such as European styled bidets and custom made shower stalls are a marriage of high design and elegant functionality.

If you see your kitchen as warm and traditional, you'll find we've made the choices very easy. Should you prefer something with a more contemporary feel, the colours, finishes and selection available will give you that designer edge. Counters in granite with custom backsplashes.



Gas or electric cooktops. Superb appliances such as Sub Zero refrigerators and Bosch dishwashers are seamlessly integrated.

The range of standard choices are almost unlimited and you can go on from there. The selection, the designer advice, the time and the ultimate in features to make your kitchen a focal point in your home.

Features like state-of-the-art heat pumps, air conditioning, water purification and the advanced interactive security system as well as secured well-lit underground parking are indicative of the high specifications. They also reflect the fact that energy-efficiency and security are signature benefits of Bayshore.



First, last and always the most notable features of the homes are the large private balconies, villa-like terraces, and panoramic windows. These open onto curtains of mountains, an ever-changing harbour and the timeless beauty of Stanley Park.



THE BAYSHORE

Resort Club

All residents of 1717 and 1777 will become members of the Bayshore Resort Club.

Privileges will extend to the restaurants, lounges, spa and pools of the Westin Bayshore Hotel. As Bayshore Resort Club members the Hotel becomes your guest house. All the guest services at the Westin Bayshore are at your fingertips. Room service, laundry, dry cleaning, housekeeping or even the arrangement of a meeting room.

Your concierge will make reservations for any of the club's myriad of experiences, including boat charters, catering, conference facilities and guest accommodations.

Residents with boats may want the ultimate convenience available at the Bayshore. They may cast off from their berth in our newly redesigned private marina. Berths here in the most desirable location in Vancouver's waterfront will be offered on a purchase or lease basis.

Bayshore is truly Vancouver's only waterfront residential resort.

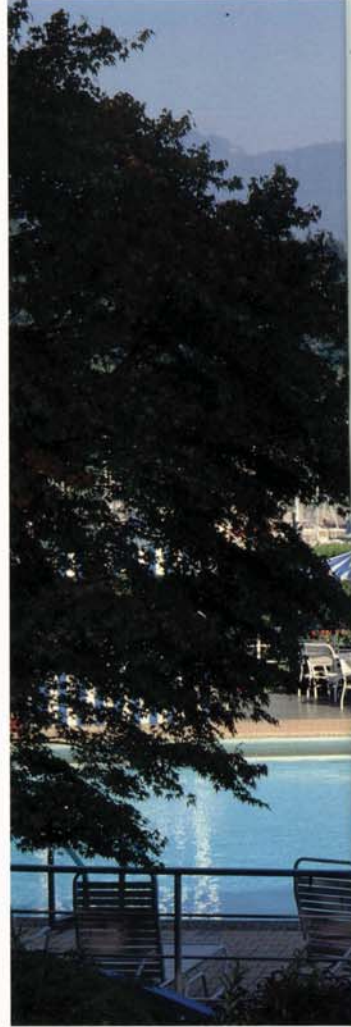



Privileges



B C C O N D O S . N E T





Caesar Park Penha Longa Golf & Resort, Sintra, Portugal



The Westin Resort, Hilton Head Island



Caesar Park Beach and Golf Resort, Cancun, Mexico



The Westin La Paloma, Tucson, Arizona



Aoki Corporation

Aoki Corporation, the proud parent company of Bayshore Gardens Developments Limited Partnership, is a leader in the international construction and hospitality industry.

The colours of Aoki's corporate symbol, green for nature, blue for intelligence and white for technology represent the Company's priorities and the reasons for its 50 years of successful operations internationally. Bayshore is now taking its rightful place amongst Aoki's finest and most distinctive developments in the world.





1717 on the right and 1777 to the left, the premier addresses of the spectacular Bayshore Resort Neighbourhood.

1717 & 1777
BAYSHORE DRIVE

Exclusively Marketed by Royal LePage.

Developed by Bayshore Gardens Developments Limited Partnership, a subsidiary of Aoki Corporation, Suite 1550-1500 West Georgia Street, Vancouver B.C. Canada V6G 2Z6, Telephone (604) 688-1710.

This is not an offering for sale. In the interest of maintaining high standards, the developer reserves the right to modify the specifications and design of the project without prior notice. Actual floor plans, illustrations and dimensions may vary slightly.



BCCONDOS.NET





B C C O N D O S . N E T





BIACASTHORE

Vancouver's busy waterfront residential resort



B C C O N D O S . N E T



BAYSHORE

Vancouver's only waterfront residential resort



B C C O N D O S . N E T





The Westin Bayshore Hotel

A Vancouver landmark for more than three decades

Bayshore

THE TRADITION CONTINUES

SINCE OPENING ITS DOORS IN 1961, The Westin Bayshore Hotel has been a treasured Vancouver landmark. It has set tradition, from the welcoming 'Beefeater' doorman, to the institution of formal Sunday brunch. It is where we have celebrated holidays and special occasions, and where visitors come back to time and time again. It has hosted many of the world's most famous faces including The Prince of Wales and Howard Hughes. It is home to our favourite outdoor pool and proudly boasts the most photographed views in the city.

The Bayshore is, quite simply put, the quintessential Vancouver.

Soon, this magnificent site will experience a remarkable transformation to a contemporary new waterfront residential resort community. -BAYSHORE.



B C C O N D O S . N E T



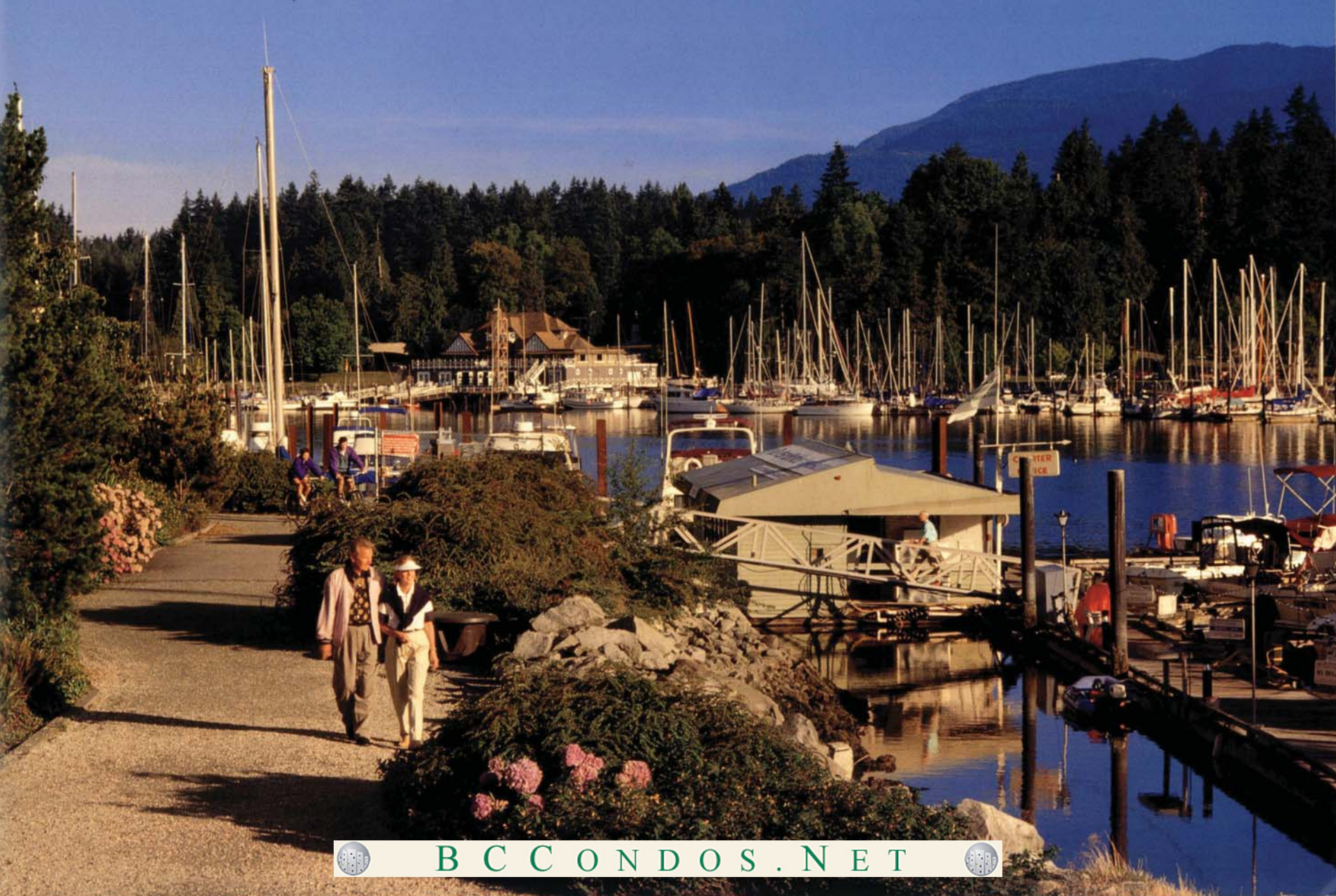

BCCONDOS.NET





A contemporary expression of



BCCONDOS.NET





Bayshore

VANCOUVER'S ONLY WATERFRONT
RESIDENTIAL RESORT

SHARING THE WESTIN BAYSHORE HOTEL'S outstanding 22-acre Coal Harbour location, BAYSHORE will combine the foremost qualities of a waterfront residential community with all of the luxuries of a world-class hotel. The result will be a remarkable new 'residential resort' offering spacious, beautifully crafted homes and unsurpassed amenities and services.

BAYSHORE's setting will be complemented by superb architecture and extensive landscaping. It will include an expanded shoreline walkway, renovated marina, two new city parks, fountains, waterscapes and private gardens. Future renovations and expansions are planned for the hotel to ensure its place as Vancouver's finest resort.



BCCONDOS.NET





B C C O N D O S . N E T



On the Edge of the Park

AT THE ENTRANCE TO THE CITY

BAYSHORE will be a true urban oasis. Minutes from downtown, yet somehow worlds apart. Just a few steps from all the opportunities and attractions of one of the world's most cosmopolitan cities.

A scenic, winding walkway along the shoreline of Coal Harbour will connect you with the natural beauty of Stanley Park and Vancouver's bustling downtown business, shopping and entertainment centres. Walk to the financial district, browse leisurely through the boutiques of Robson Street or meander through the charming neighbourhoods of the West End. BAYSHORE's unique location will offer the best of Vancouver. A much sought after lifestyle, admired around the world.

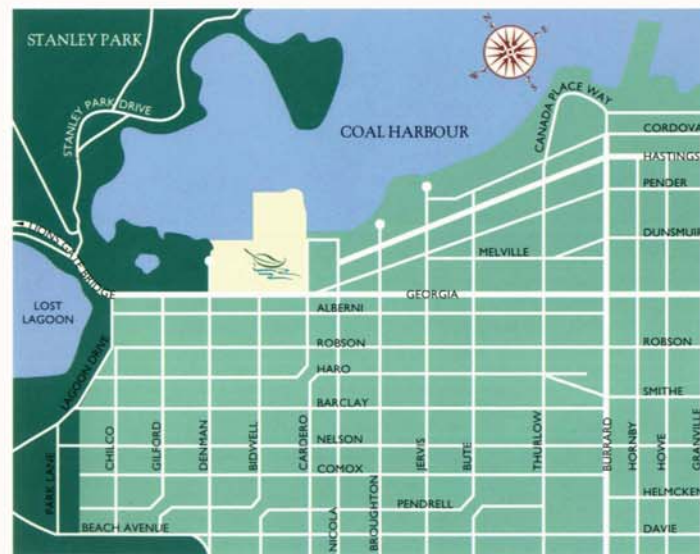

Near everything, nothing comes close to BAYSHORE



BCCONDOS.NET



Bayshore



BCCONDOS.NET



re Resort Club & Marina

THE PRIVILEGE OF OWNERSHIP

THE ADVANTAGES OF LIVING at BAYSHORE go well beyond its celebrated location and beautiful homes. You will also enjoy all the benefits of a world-class hotel and the privilege of membership in the exclusive Bayshore Resort Club.

Cast off from the private marina, relax poolside at the fitness centre, enjoy a leisurely drink at Vancouver's most picturesque outdoor pool or linger over dinner at one of the hotel's renowned restaurants.

Your concierge will be pleased to assist you in making reservations for any of the club's seemingly endless array of amenities, including boat charters, catering and housekeeping, conference facilities and guest accommodations. BAYSHORE... the only residential resort of its kind.



The ultimate in resort living



BCCONDOS.NET



Bordering on the Spectacular

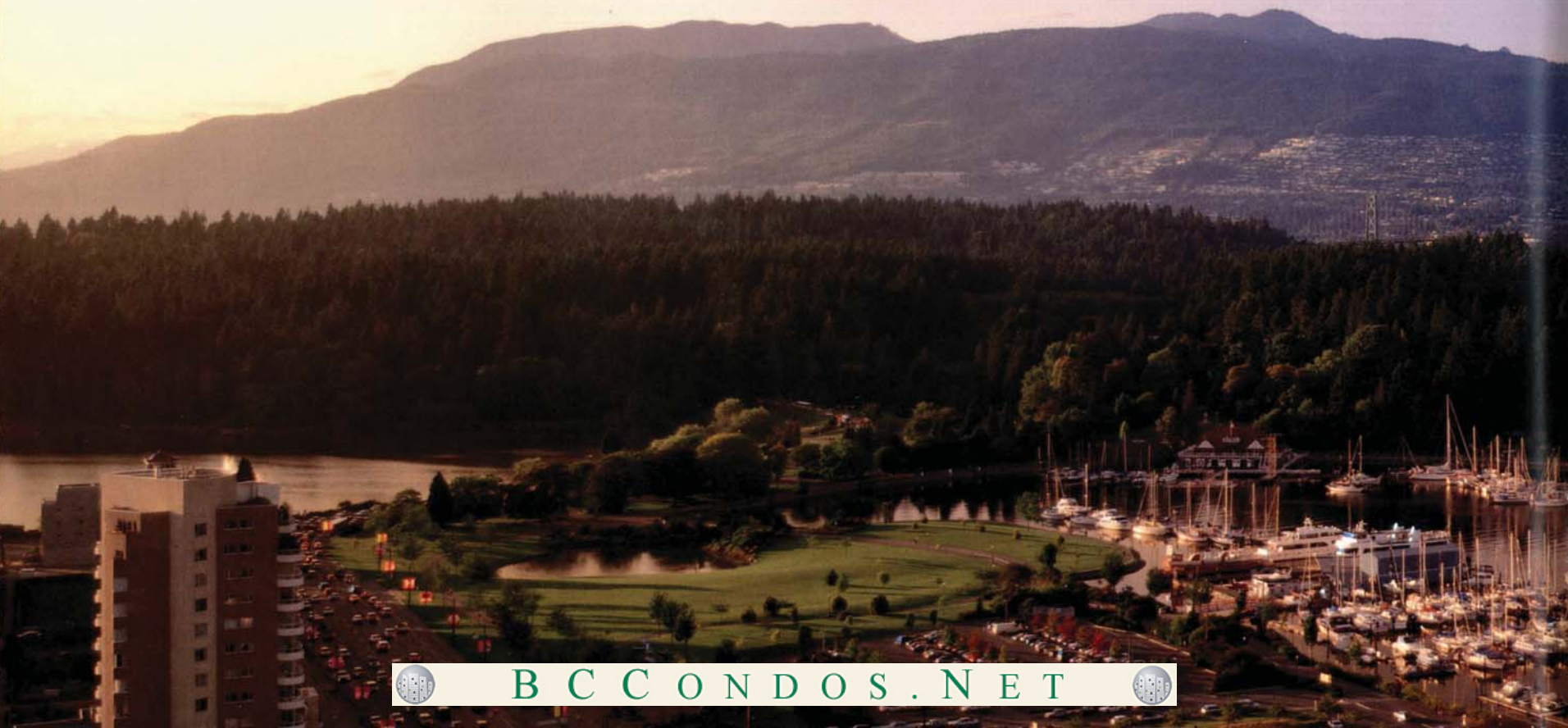

BCCONDOS.NET





B C C O N D O S . N E T



STANLEY
PARK

COAL HARBOUR

WESTIN
BAYSHORE
HOTEL

LOST
LAGOON

TO LIONS GATE BRIDGE

NYAN STREET

CARDERO STREET



BCCONDOS.NET



Luxuriant Gardens

AND SPARKLING POOLS OF WATER

VANCOUVER IS KNOWN WORLD-WIDE as a city encompassed by water and a rich abundance of parks and gardens. Fittingly, these elements will be linked to BAYSHORE through its exceptional landscape design.

The waterfront environment of BAYSHORE will be extended into the landscape with cascading pools and fountains, glimmering waterscapes and water gardens. Its park-like setting will be enhanced by two new city parks, winding paths, expansive lawns and a series of distinctive formal and informal West Coast gardens. The Georgia Esplanade, separating the towers from Georgia Street, will incorporate a grand two block long reflecting pool running parallel to a stately double row of trees.



Inspired by the beauty of its setting



B C C O N D O S . N E T





BCCONDOS.NET



Timeless Architecture

A N U N D E R S T A T E D E L E G A N C E

THE BEAUTY OF THE ARCHITECTURE will respond to its spectacular setting with contemporary elegance and refined character. Designed to maximize views from every suite, BAYSHORE's towers have been arranged to open up the breathtaking panorama of Stanley Park, Coal Harbour, the North Shore mountains and city skyline.

Set amidst more than ten acres of parks and gardens, tall, slender towers will rise up on columns, and dramatically terraced buildings will step down boldly to the water's edge. The expansive use of light glass and natural materials will enhance, rather than compete with BAYSHORE's unparalleled backdrop.

Planned with a commitment to the highest standards of design and craftsmanship and incorporating the latest in technological advancements, BAYSHORE will be a timeless classic worthy of its premier location.



B C C O N D O S . N E T



1710 & 1790

Bayshore

THE FIRST BAYSHORE RESIDENCES

THE TWO 18- AND 22-STORY TOWERS AT 1710 AND 1790 will be the first realization of the BAYSHORE vision. These prestigious residences will enjoy private entries from Bayshore Drive, an exclusive new street set within the grounds of the resort. State-of-the-art buildings will showcase soaring lobbies and tastefully appointed hallways. A private exercise studio, meeting rooms and workshop will be found on the main and lower levels as well as a cozy residents' lounge, games room and entertainment area opening onto an expansive terrace. The on-site concierge will greet your visitors, assist you with your daily schedule and enhance the security of these thoughtfully planned homes.

1710 and 1790 will offer a long-awaited return to generous living spaces with suites ranging from spacious 900 sq. ft. one bedrooms to 2500 sq. ft. and more.



BCCONDOS.NET



Surrounded by gardens no less remarkable than its homes

Drive

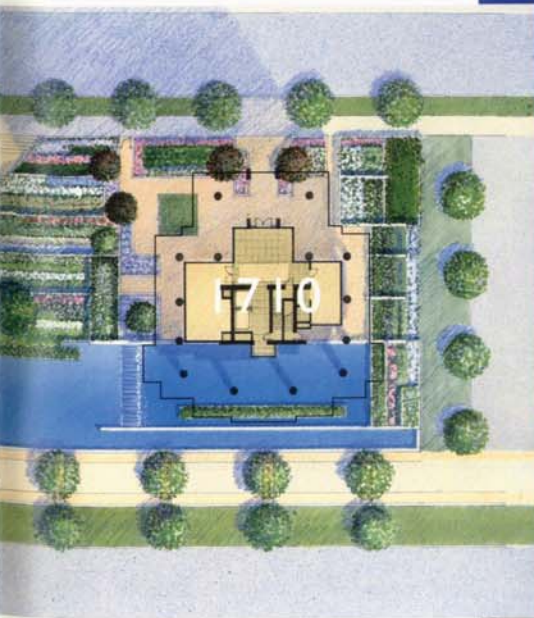

BCCONDOS.NET



Refined Interiors

U N P A R A L L E L E D V I E W S

GREAT CARE HAS BEEN TAKEN in planning every suite. Vancouver's acclaimed Robert Ledingham has designed lobbies and interiors befitting the elegance of BAYSHORE. Luxurious carpeting, recessed lighting, marble fireplaces and granite countertops will complement your choice of interior finishings. Whether you prefer hardwood or porcelain tile kitchen flooring, European-style or natural wood cabinets, gas or electric cooktops, or colour palettes ranging from sophisticated urban contemporary to subtle naturals, you can customize your home to suit your personal taste.

Well-appointed master baths will incorporate imported marble and porcelain tiles, premium fixtures, soaker tubs and separate glassed-in showers. Storage space is abundant with generous closets and in-suite storage.

Kitchens are an important focal point at BAYSHORE. Each will reflect the latest in design with top-of-the-line appliances including gas or electric cooktops with self-cleaning ovens, high-power range fans, built-in microwave ovens, double-door refrigerators, quiet dishwashers and in-sink disposal units.



Beautifully crafted interiors surpassed only by the views



B C C O N D O S . N E T



Energy-efficiency and security are an integral part of the design, with double or triple-paned windows, gas heating systems, air conditioning, secured well-lit underground parking and advanced interactive security systems.

Panoramic windows and large private balconies or terraces will offer breathtaking views from Stanley Park, across the ever-changing spectacle of the harbour, to the glittering night lights of the city skyline.



Interior materials reflect an uncompromising attention to detail



B C C O N D O S . N E T



The Developer



*Walt Disney World Swan,
Orlando, Florida*

AOKI CORPORATION, THE PARENT COMPANY of Bayshore Gardens Developments Limited Partnership, is a leader in international construction and the hospitality industry. The colours of AOKI's corporate symbol - green for nature, blue for intelligence and white for technology - represent the Company's priorities and the reasons for its 48 years of successful international operation. Soon BAYSHORE will take its rightful place amongst AOKI's finest resort developments in the world.



*Caesar Park Beach & Golf Resort,
Cancun, Mexico*



*The Westin La Paloma,
Tuscon, Arizona*



**AOKI
CORPORATION**



B C C O N D O S . N E T



*ga Golf & Resort,
Sintra, Portugal*



B C C O N D O S . N E T





CUSTOM DESIGN

1717 @ 1777

BAYSHORE DRIVE



B C C O N D O S . N E T



1717 & 1777
BAYSHORE DRIVE

Elegantly

DESIGNED INTERIORS.



YOURS.

Our Design Centre welcomes you with a marvelous selection of quality products that enable you to express your individual taste. This extensive collection of materials which include carpeting, flooring, cabinetry and accessories, gives you the freedom to create a home that is uniquely yours.

The familiarity of wood, the sophistication of granite and marble, all harmonize with the moods you wish to create. The styles and textures offer a world of variety and versatility.

FROM THE

Traditional

TO THE

Contemporary

Revive the ambiance of a classical home with all the symmetry of timeless beauty and modern convenience. Or dress your home in breathtaking style with gleaming black flooring, ivory carpets, granite and marble. The evolution of home design is now yours, and yours alone.



B C C O N D O S . N E T



From Kitchens

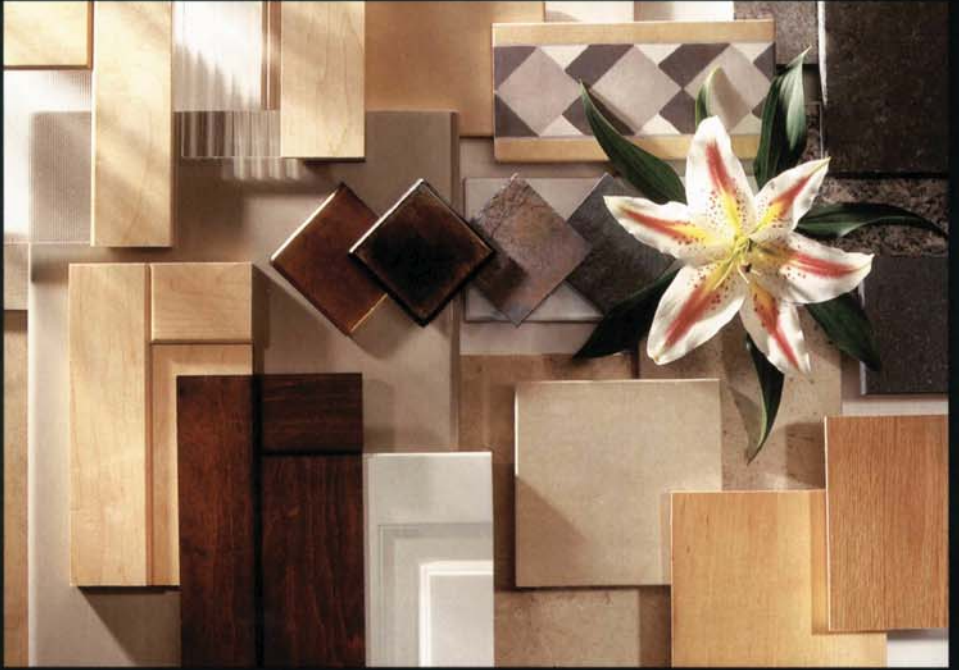

With our vast combination of choices in materials and appliances, your kitchen will never be short of creativity and warmth. Granite countertops come in a selection of hues ranging from Saturn Blue to Canadian Gold. You can also choose from eight kitchen cabinet styles, each with a distinctive look and finish to set the tone.

The kitchen backsplashes come in a variety of styles, thus allowing you to add final touches of individuality to your decor. Complementing the cabinetry are appliances which are not limited to the beauty of their gleaming exteriors. Each has the justifiable reputation of being amongst the best on the market. With a choice of stainless steel, black or white, your appliances are an unmatched combination of utility and elegance.

Finally, choose from a wonderful selection of Limestone, Maple, Oak or Porcelain Tile with Accent flooring to bring together the unique quality of your kitchen. Your choice of appliances, countertops and flooring, will prove that convenience, durability and beauty can enjoy wonderful harmony.





Earth



Forest



Stone



Moon



Sea



Breeze

To Bathrooms

For the most personal rooms in your home, we offer all the choice you need to reflect what is distinctly you. Choose from six stunning bathroom combinations of remarkable granite and marble that will bring the luxury and refinement appropriate to your home at the Bayshore.





Vision

"We've chosen a large selection of natural materials with simple, understated elegance and numerous, complementary colour choices. It's an interior design concept with a timeless palette with which you can create your own personal lifestyle."

*Pat McCulloch,
McCulloch & Associates*

Bayshore Custom Design

ENTRANCE FOYER
 Marble Botticino
 Honed Marble - Desert Beige
 Limestone - Rochmanier Blue
 Travertine Novona
 Granite - Absolute Black
 Wood - Maple or Oak

CARPETING
 Wool Loop
 Wool Country Cord
 Textured Patterned Nylon
 Heavy Plush Nylon
 Carpets come in a choice of available colours

KITCHEN FLOORING
 Honed Marble - Desert Beige
 Limestone - Rochmanier Blue
 Wood - Maple or Oak
 Porcelain with Accent

KITCHEN CABINETS
 White Heritage
 Contemporary Lacquer
 Contemporary Natural Maple
 Contemporary Natural Maple with Pin Dot Glass
 Contemporary Cherry Stained Maple
 Natural Maple Shaker
 Natural Maple Shaker with Reed Glass
 Mc Culloch Stained Maple Shaker

KITCHEN COUNTERTOPS
 Granite Canadian Gold
 Granite Saturn Blue
 Granite Uba Tuba
 Granite Absolute Black

KITCHEN BACKSPASHES
 Granite Tile to match Counter Top
 Polished Porcelain with Accent
 Antigua White Tile with Accent
 Euro Giallo Almeria with Accent

BACKSPASH ACCENT
 Slate - Rajah Premium
 Slate - Jaddish
 Raku Tile - Honey or Bronze

MARBLE BATHROOMS
 "Earth"
 Ivory Cream marble
 Emperador Brown marble
 "Forest"
 Light Green marble
 Absolute Black granite
 "Stone"
 Crema Marfil marble
 Rosa Del Guarda marble
 "Moon"
 Fiascinato marble
 Absolute Black granite
 "Sea"
 Desert Shell honed marble with Desert Shell Polished marble accent
 Perlato Royal marble
 "Breeze"
 Travertina Chiaro porcelain with embossed accent (12" x 6") flooring
 Giallo Veneziano granite

BATHROOM CABINETS
 White Heritage
 Natural Maple Shaker
 Contemporary White Lacquer
 Contemporary Natural Maple
 Contemporary Cherry Stained Maple

Features

BAYSHORE WATERFRONT RESIDENCES

1717

BAYSHORE DRIVE

- 59 view residences with;
- 11 custom penthouses from approximately 2,200 to 6,000 square feet with grand European style terraces
- 44 exceptionally spacious residences with large outdoor balconies
- Entry Porte-cochere
- Striking double volume lobby leading to club room, garden lounge, paneled billiards room, naturally-lit arts & crafts studio, library, and health club, with terraces overlooking the lagoon
- Six elevators serving three lobbies and a maximum of three residences
- Fabulous multidirectional views and exposures

1777

BAYSHORE DRIVE

- 40 view residences with;
- 5 custom penthouses from approximately 2,300 to 4,500 square feet
- 35 spacious residences with only three suites per floor
- Elegant lobby leading to tastefully appointed piano lounge, bridge room, health club, massage room and whirlpool, overlooking a beautifully landscaped outdoor terrace and lagoon
- Graciously furnished lower lobby at parking level

Impressive Exteriors

- Designed by internationally renowned architect, Richard Henriquez
- Dramatic design combining extensive tinted glass and architectural concrete
- Terraced lagoon forms a beautiful water courtyard between 1717 and 1777 Bayshore Drive
- A series of lush gardens and walkways leading to the water's edge

Custom Quality Interior Features

- Selected upgrades available for penthouse suites
- A choice of contemporary and traditional interior schemes
- Double entry wood doors
- Choice of marble, limestone, granite, maple or oak flooring in foyer
- Higher ceilings in all principal rooms with smooth finish
- French doors and full height windows in living areas
- Gas fireplaces with contemporary or traditional mantles
- Carpeting in four main weaves in a variety of hues
- Baseboards and coordinating door casings
- Crown moldings in traditional interior scheme
- Recessed pot lighting with dimmer switches throughout
- Solid core interior doors with contemporary or traditional hardware
- Most suites feature walk-in closets
- Closet organizers
- Spacious in suite storage
- In suite laundry room in most suites
- Window coverings throughout



Gourmet Kitchens

- Choice of limestone, maple, oak or porcelain tile flooring
- Choice of cabinet designs from the Bayshore Collection with selections in wood and lacquers in a variety of colours and styles
- Choice of four granite countertops
- A variety of countertop backsplashes and accents in slate and tile
- Quality appliances in white, black or stainless steel, including:
 - Bosch 5 burner gas or electric cooktop
 - Faber retractable range hood
 - Bosch built in self cleaning wall oven
 - Panasonic built in microwave
 - Bosch quiet dishwasher (stainless steel interior)
 - Sub Zero refrigerator
- Stainless steel undermounted sinks
- Single lever faucet with vegetable spray
- In sink disposal unit
- Built in waste compactor
- Under cabinet halogen lights
- Pantries, pull out drawers and lazy susans
- Breakfast rooms and counters

Luxurious Bathrooms

- 6 custom colour schemes with marble flooring and marble or granite countertops
- Master bathrooms feature six premium fixtures, including glass enclosed custom shower stall, drop in tub, separately enclosed water closet, and bidet in most suites
- Pull out drawers in all vanities
- Temperature and pressure balanced shower heads
- Euromix faucets in a choice of contemporary or traditional design

Safety and Security

- Gated secured, brightly lit and painted underground parking
- Private gated guest parking
- Sprinklers, smoke and heat detectors in every suite
- Interactive security system
- Every suite pre-wired for individual security system
- On site concierge
- 24 hour security video surveillance
- Secured generously sized individual storage rooms for every suite at parking levels
- A ten-year New Home Warranty program

Energy, Efficiency and Comfort

- Leading edge fibre-optics to provide access to a choice of innovative new telecommunications products and services
- Energy-efficient heat pump and air conditioning
- Water purification system
- Energy saving, double glazed windows
- BC Hydro approved Power Smart light fixtures

Well Appointed Terraces and Balconies

- Lighting and water hose bibs
- Privacy landscaping and trellises
- Built in planters with irrigation
- Porcelain tile or concrete pavers
- Gas connections for all terraces and patios



Features

THE TOWERS

The two slim 18- and 22-storey towers at 1710 & 1790 Bayshore Drive, have been masterfully designed and will be built to the highest standards of craftsmanship. Rising up on columns and surrounded by waterscapes and formal landscaped gardens, the buildings will feature:

- Exteriors combining subtle coloured natural materials and extensive light glass.
- Entry off Bayshore Drive, an exclusive new street set within the grounds of BAYSHORE.
- Secured, well-lit underground parking.
- An advanced, interactive security system.
- The convenience of an on-site concierge and a resident caretaker.
- Soaring, two storey high lobbies.
- Tastefully appointed main levels with meeting rooms, a cozy residents lounge and large entertainment area overlooking a beautifully landscaped outdoor terrace.
- A private exercise studio and workshop on the lower level.
- Energy efficient design with heat pump and air conditioning.
- Water purification system.
- The incorporation of fibre-optics to provide access to an impressive choice of innovative new telecommunications products and services.

THE INTERIORS

The residences at 1710 & 1790 have been carefully planned and will offer suites ranging from spacious 900 sq. ft. one bedrooms to over 2,500 sq. ft. three bedrooms and den/family room. The elegant interiors, designed by Robert Ledingham, will offer:

- Expansive panoramic, double or triple-paned opening windows.
- Large open or enclosed private balconies or terraces with unsurpassed views of Stanley Park, Coal Harbour and the city lights.
- A choice of three beautiful colour palettes.
- Sumptuous 50 oz. carpeting and tiled entrances.
- Gas fireplaces with marble detailing.
- Designer kitchens with a choice of European-style or wood cabinets; hardwood or porcelain tile floors; natural granite or solid countertops.
- Top of the line kitchen appliances including gas or electric cook tops and self-cleaning ovens; range fans; double-door refrigerators, in-sink disposal units; quiet dishwashers and built-in microwaves.
- Luxuriously appointed master bathrooms with imported marble and porcelain tiles; premium fixtures; relaxing soaker tubs and separate glassed-in showers.
- Convenient in-suite laundry with washer and dryer.
- Abundant in-suite storage and large closets.
- Interactive security system:
- Three-phone line capability.
- An unprecedented ten-year new home warranty program.

THE RESORT CLUB & MARINA

Owners at BAYSHORE will enjoy membership in the exclusive Bayshore Resort Club and Marina. This exclusive VIP club package will provide privileges of The Westin Bayshore Hotel:

- Extensive personal, business and guest services including:
 - Catering, room service, laundry & dry cleaning and housekeeping.
 - Conference and banquet facilities.
 - Guest accommodation.
- The convenience of booking services through the concierge and monthly billing.
- No monthly service fees.
- A renovated private marina with berth space reserved for BAYSHORE residents.
- An expanded and upgraded comprehensive health club and fitness centre including indoor pool, whirlpool, full training equipment, snack bar, changing rooms and showers.
- A beautiful outdoor pool set against the spectacular backdrop of Coal Harbour.
- Restaurants, lounges and retail shops.
- Shuttle service between the hotel and downtown.



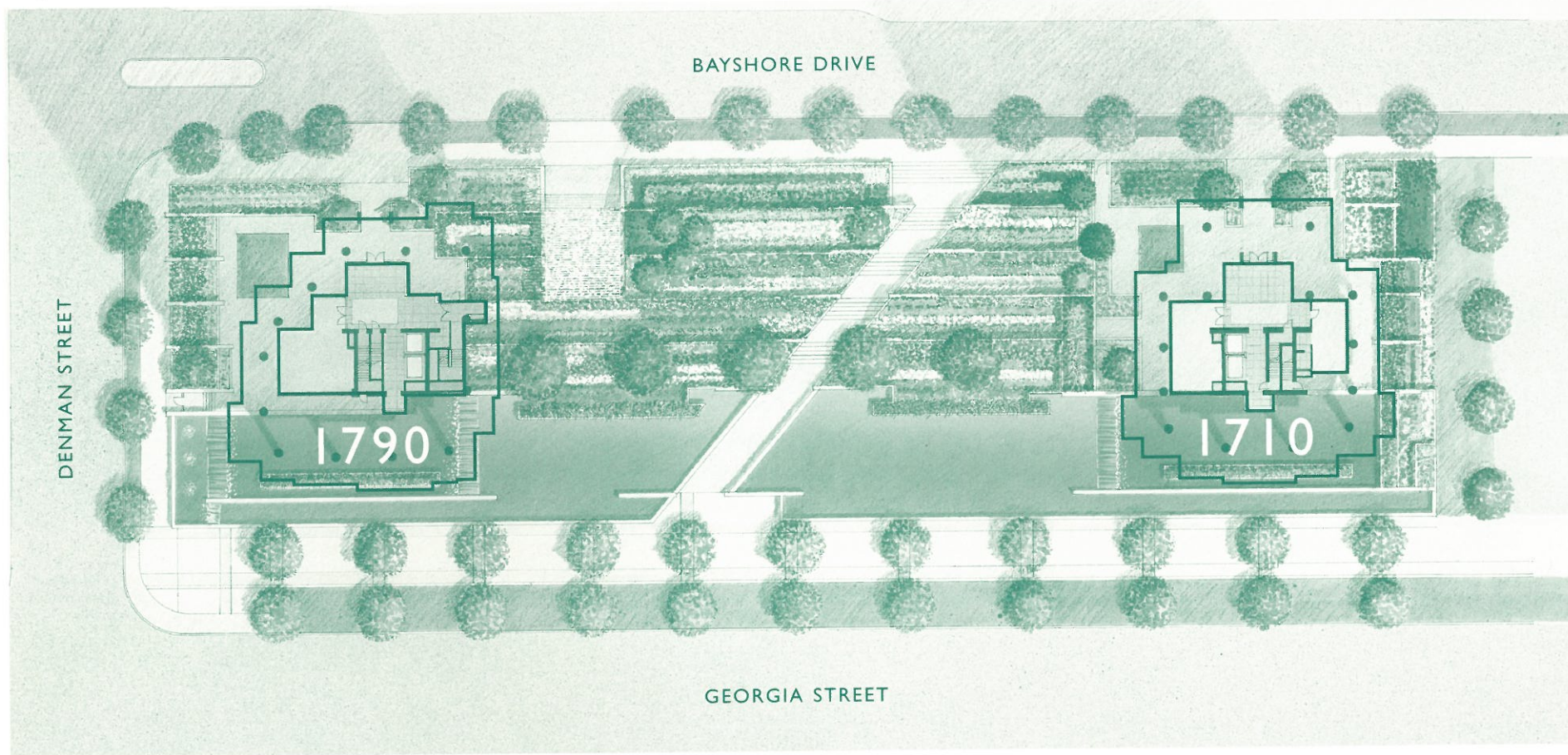

THE LANDSCAPING

Directly adjoining Stanley Park, BAYSHORE will be set amidst ten acres of luxuriant landscaping designed by Durante Kruek Ltd. The grounds will include:

- An extended waterfront walkway linking up with

- Two new city parks occupying more than two and one-half acres.
- A series of distinctive formal and informal gardens.

- Winding pathways connecting the parks and gardens.
- The Georgia Esplanade, a grand new boulevard between BAYSHORE and Georgia Street, incorporating a two-block long reflecting pool running parallel to a double row of trees.



B C C O N D O S . N E T





Site Plan

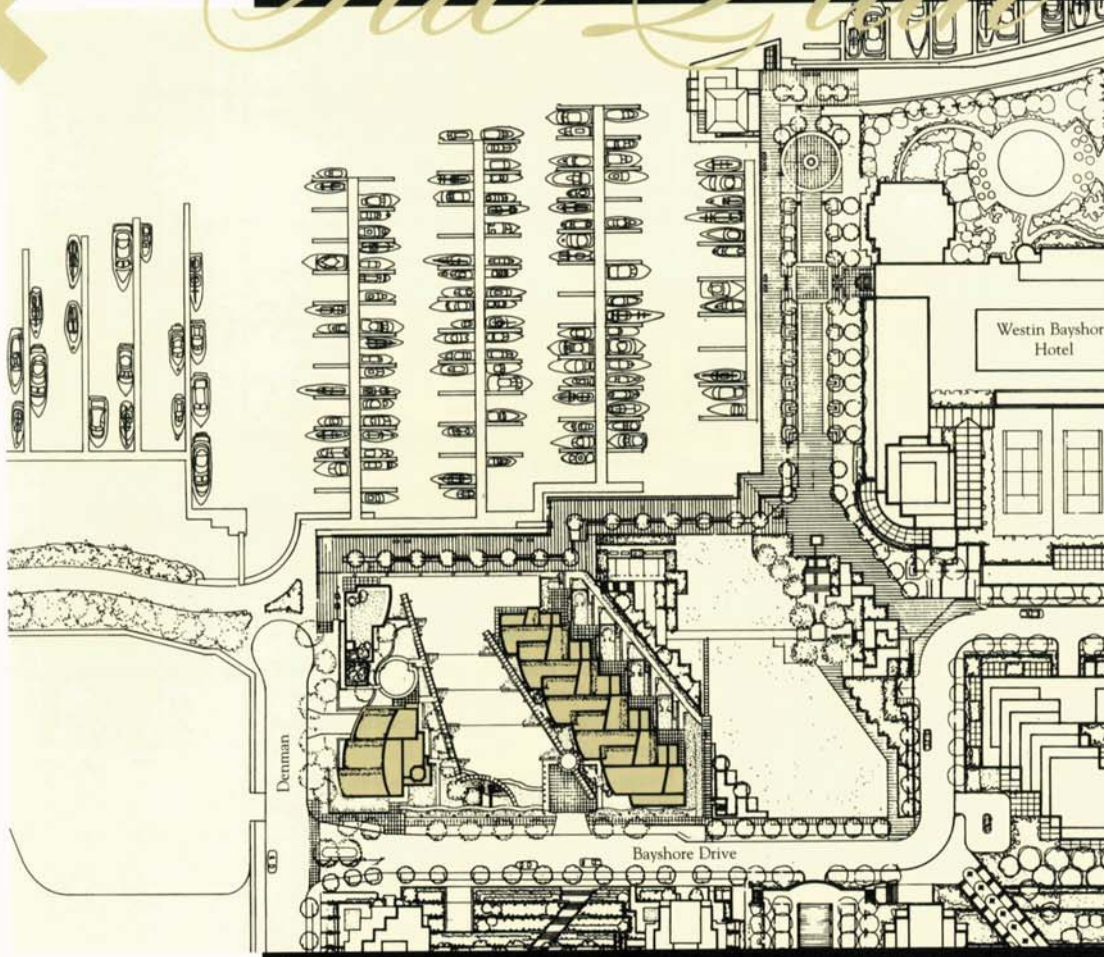

BAYSHORE

Vancouver's only waterfront residential resort

ISSUE # 1 0

Master the delicate craft
of parallel parking.



Coming home to Bayshore is a special event. With a little touch, you gently manoeuvre into your own reserved slip. With pride. With skill. And even if you never go to sea, living beside the Bayshore marina is a great reward. For those who've become masters of their own craft.



The Waterfront Residences.

Most units priced from \$300,000 to \$1.2 million. Presentation Centre at Suite 1100 - 1300 West Georgia Street 12.5 hrs daily. For a private appointment, or to view our fully furnished penthouse, call Evelyn Froese (604) 688-1710. In Toronto please call TEL: (416) 921-1122. Toll Free: 1-800-467-1766.

Exclusively marketed by Royal LePage.

ONE OF SEVERAL BAYSHORE ADS TO WIN
A 1998 SILVER GEORGIE AWARD

Bayshore Wins Nine Silver Georgie Awards

Bayshore Gardens Developments Ltd. was the recipient of nine Silver Georgie Awards in the 7th Annual Georgie Awards Competition. And now our Silver winners are eligible for Gold Awards which will be presented at a Gala Awards Evening at the Hyatt Regency Hotel, Saturday, November 7.

The awards are presented by the Canadian Home Builders' Association of B.C. in recognition of outstanding achievement within B.C.'s housing industry.

Five Silver Awards were presented to Bayshore in conjunction with Robertson Pick Advertising for the project's well received 1997/1998 advertising campaign. Our web site (www.bayshore.bc.ca) created by Karo Design Resources Inc., earned a Silver as well.

Sales Manager Evelyn Froese was recognized for her outstanding contribution to Bayshore's success with a Silver Award for Best Salesperson in New Home Construction. Micron, Bayshore's form work contractor also won a Silver for Outstanding Sub trade.



Entries are judged by an impartial panel of industry experts from across Canada and the U.S. Panel members are selected based on their years of experience and knowledge in fields

ranging from interior design and advertising, to engineering and construction.

Previous Georgie Awards presented to Bayshore include a Gold Award for Best On-Site Sales Office/Presentation Centre, and two Silvers for Best Logo and Best Brochure.

Sales Soar Through Summer Months

This summer's beautiful, sunny weather provided a spectacular backdrop for the resort-like setting of the Waterfront Residences at Bayshore, drawing an impressive number of visitors to our sales presentation centre.

Strong interest from local, American and European buyers boosted sales to nearly 70 per cent by the end of August.

A lovely selection of 2 bedroom-plus-den and penthouses-style suites still remain, starting at \$550,000. Please contact Evelyn Froese of Royal LePage at (604) 688-1710 or toll-free 1-800-477-1766 for further information.



Construction Follows Shoreline Reconstruction Approval

Bayshore's construction team breathed a sigh of relief on September 18 when approval was obtained for shoreline renewal plans along Bayshore's waterfront.

Months and months of negotiating with the federal Department of Fisheries and Oceans was brought to an end and construction began the following week.

The first step was the installation of a silt carton, a filter system which will prevent any construction debris from flowing into Burrard Inlet, around the area to be excavated. By mid-October, a process of excavating and densifying the shoreline soil will begin creating a strong foundation for the sea wall. The western portion of the shoreline is scheduled to be completed by next summer.

Construction of the Waterfront Residences has reached a visible stage, with concrete work climbing to the 7th floor of 1717 and the 2nd floor of 1777 Bayshore Drive. Installation of the main electrical and mechanical systems has begun and exterior window work is scheduled to commence the middle of October.



CONSTRUCTION CONTINUES ON THE WATERFRONT RESIDENCES AT BAYSHORE.



Consultant Profile

Interior Designer McCulloch & Associates

The elegantly designed interiors of 1717 & 1777 Bayshore Drive come with an extensive range of sophisticated choices in flooring, cabinetry, carpeting and accessories, allowing buyers a unique opportunity to customize their new home.

Vancouver-based design and architectural firm McCulloch and Associates created the Waterfront Residences' interior design concepts.

Headed by Charters McCulloch, a registered interior designer with 30 years

experience, the company maintains a small office that includes Chart's wife Pat, architect Stefan Wiedemann and Susan Van Gaans. Expansion has been kept to a minimum, allowing the firm to provide direct, personal service.

For Bayshore, Pat has selected natural materials with understated elegance and numerous, complementary colour choices. It's a timeless palette with which you can create your own personal style.

For more information contact us at: sales@bayshore.bc.ca Or visit our web site at: www.bayshore.bc.ca

